

Automatic Arm Sets

Inside Rear Transfer Arm System

The Pulltarps® Rear Transfer arm system is designed especially for the rear box on transfer set applications. The fully enclosed high mount spring housings fit inside the rear box so it can be transferred. The powerful 1.3hp Superwinch® motor operates the aluminum arms that pivot smoothly on long wearing UHMW bushings. The arms are made of schedule 40 aluminum tubing.

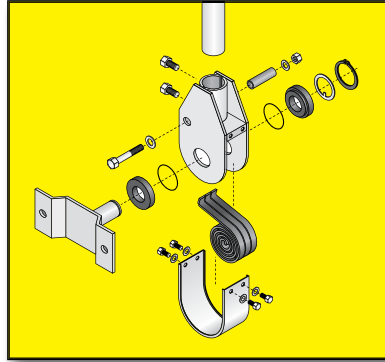

Features and Benefits

- ▶ Handles applications up to 18'
- ▶ Pivots on UHMW Bushings.
- ▶ Fully Enclosed Spring Housing
- ▶ Mounts inside the body.
- ▶ Light weight aluminum arms

Single Spring Arm System

These systems are "Simply The Best" because the heavy duty spring housings are fully enclosed and pivot smoothly on UHMW bushings and are not affected by water, salt or grit. This unique design has a low profile that is compact and out of harms way. The massive 2" spring is powder coated to resist corrosion better than any other spring on the market. All Pulltarps® arm sets are made of fence pipe or common aluminum tubing that is inexpensive and easy to replace if they are damaged.

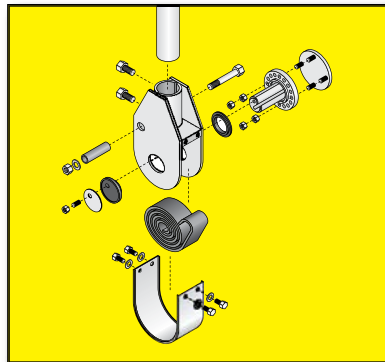

Features and Benefits

- ▶ Handles applications up to 40'
- ▶ Pivots on UHMW Bushings.
- ▶ Fully Enclosed Spring Housing
- ▶ Urethane Bumpers reduce noise.
- ▶ Optional Arm Catchers available (see pg. 26).
- ▶ Available with steel or aluminum arms