

Installation Instructions - Single Spring Arm Kits

501-0713, 501-0714, 501-0731, 501-0759, 501-0760, 501-0761, 501-0762, 501-0763, 501-0764, 501-0765,
501-0784 501-0785, 501-0786

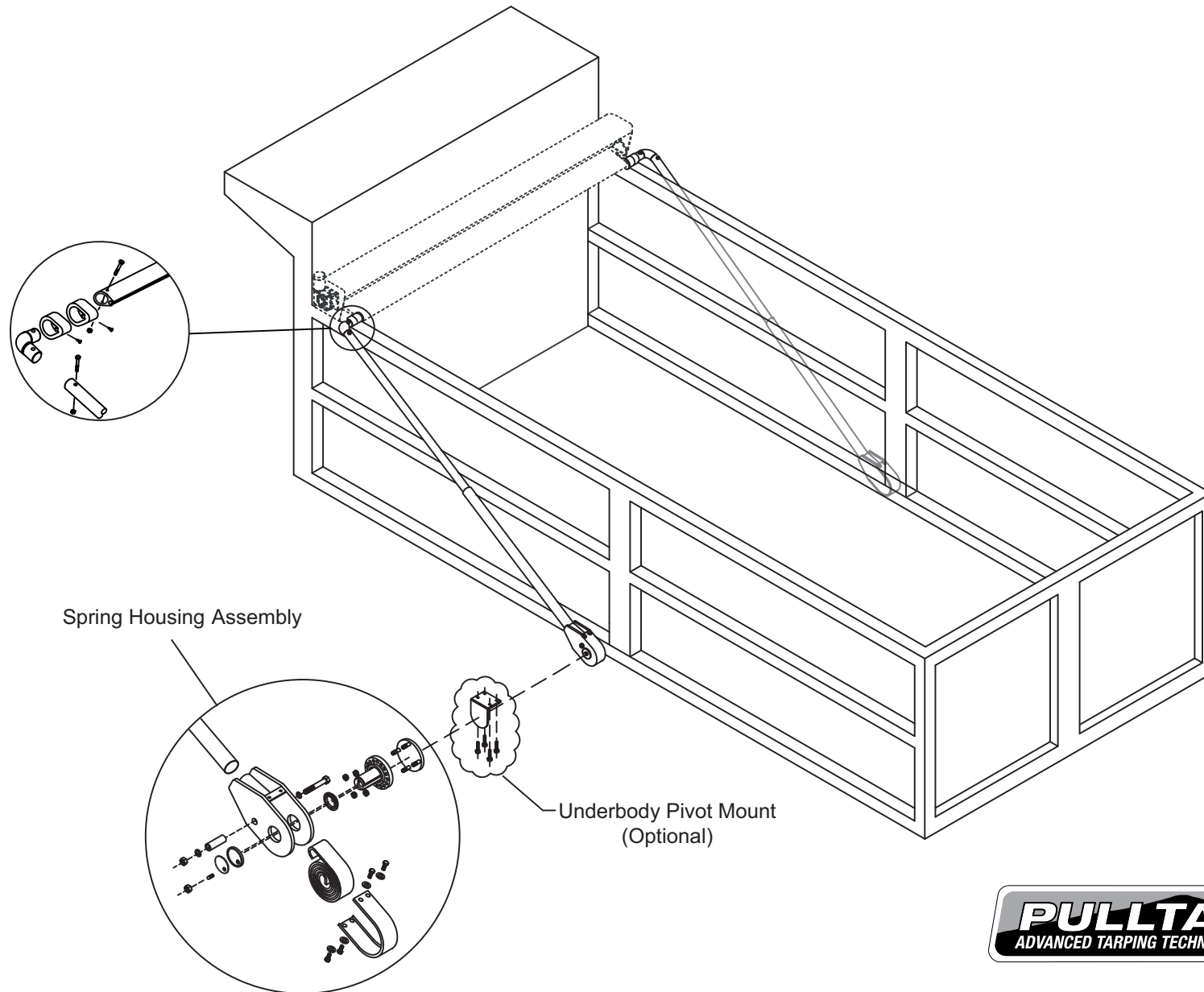

Step 1. Determining the Pivot Points and Mounting Locations

Locate the proper mounting positions by determining Point "A" and Point "B" and insuring measurement "D" and "E" are equal (Fig.1). Point "C" must be located as low as possible. Mark pivot location.

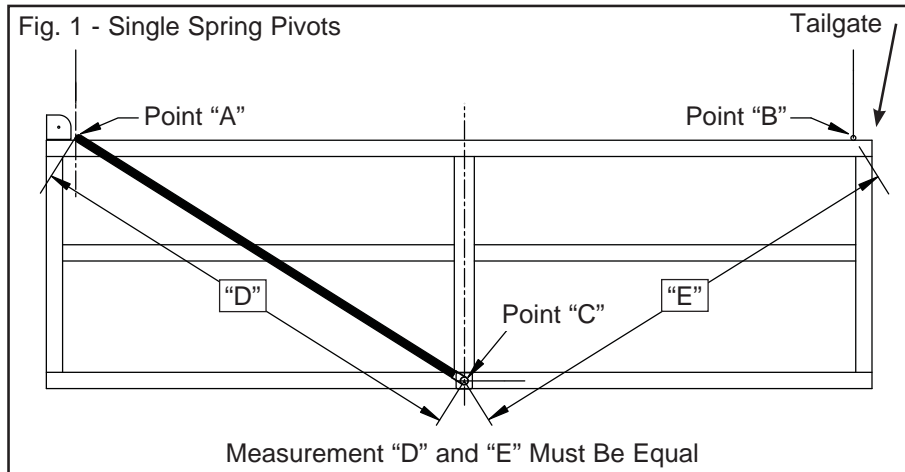

Step 2. Mounting the Pivot

For Single Springs pivots weld or bolt the Arm Adaptor Plate in place (Fig. 2).

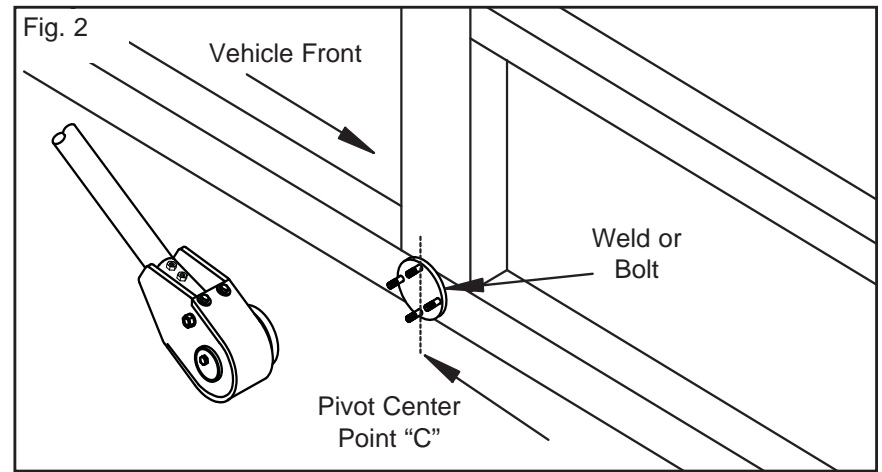

Step 3a. Arm Preload (for boxes over 22' in length)

Install Arm and Pivot assemblies on Arm Adaptor Plate with Arm indexed as shown in Fig. 3a. Arms must be indexed with no spring load on pivots. Index Arms at 180 degrees of travel from the Roller Mechanism for proper preload of the springs. The dotted lines represent proper 180 degree preload position for applications with Bent Arms. Mark pivot pin location on box.

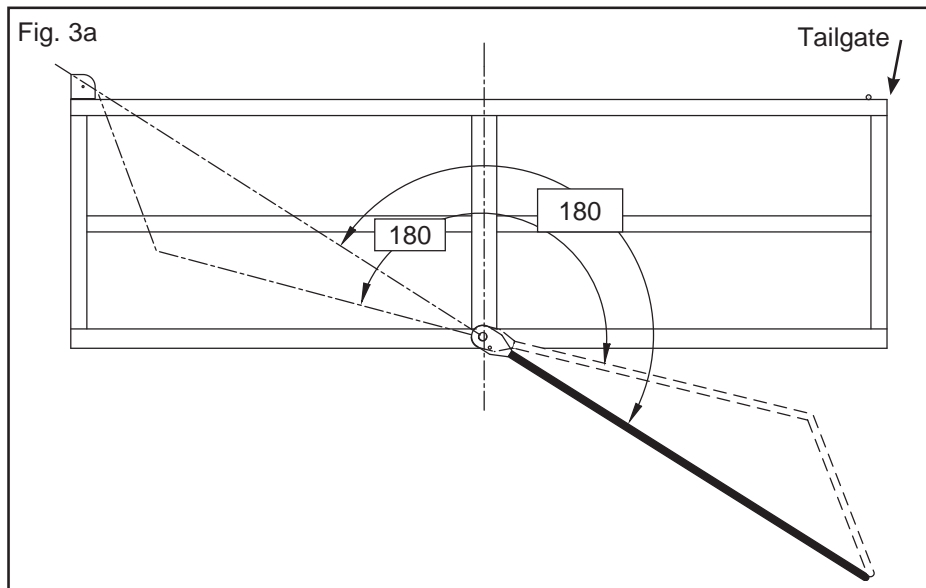

Step 3b. Arm Preload (for boxes under 22' in length)

Install Arm and Pivot assemblies on Arm Adaptor Plate with Arm indexed as shown in Fig. 3b. Arms must be indexed with no spring load on pivots. Index Arms at 150 degrees of travel from the Roller Mechanism for proper preload of the springs. The dotted lines represent proper 150 degree preload position for applications with Bent Arms. Mark pivot pin location on box.

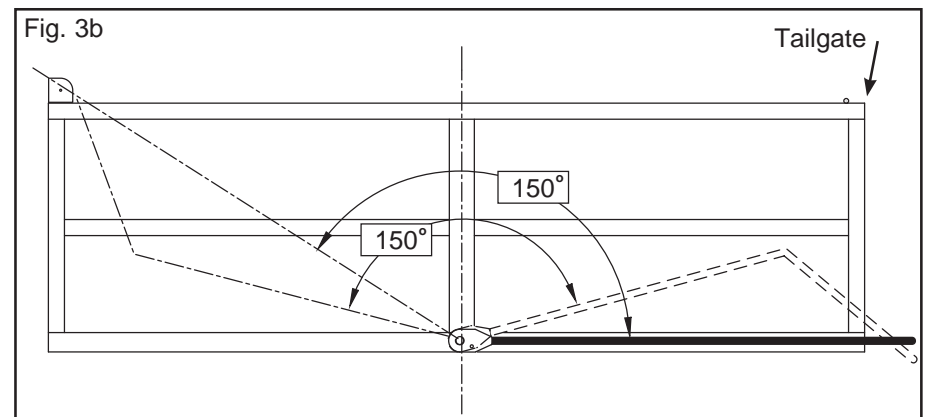

Step 4. Correct Alignment of arms to truck

Arms and Pivots must be square and parallel to truck (Fig.4).

Dimension "A" must equal "B"
Dimension "C" must equal "D"
Dimension "E" must equal "F"

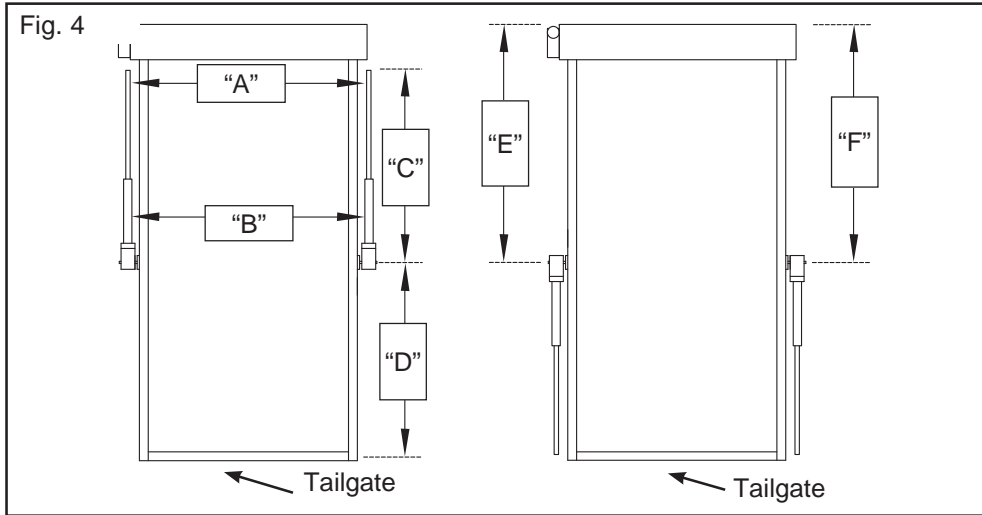

Step 5. Adjust the Arms on both sides to be the same length.

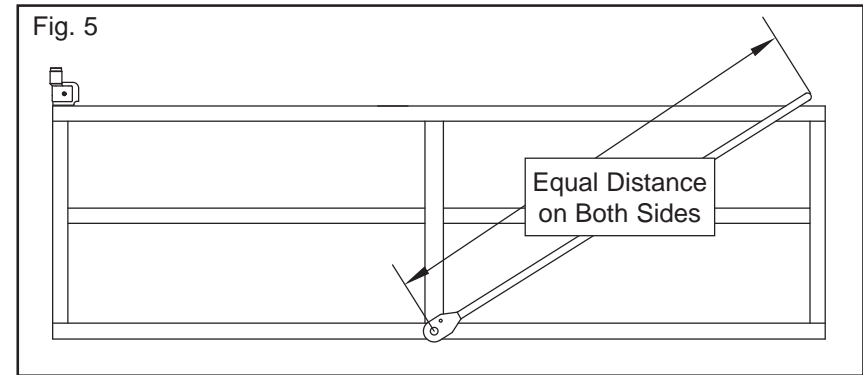

Step 6. Tarp Installation

Slide Tarp into groove on Roller Tube and center (Fig. 6).

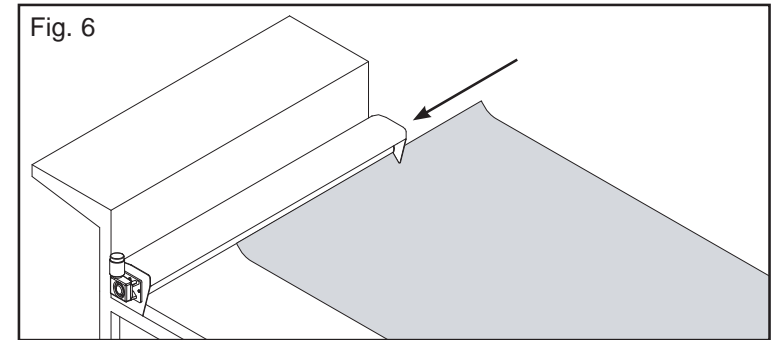

Step 7. Installing the Pullbar

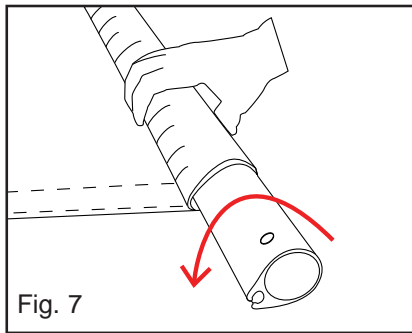

Cut the pull bar to length making sure the arms remain parallel and square to the body.

Slide the tarp into groove in the pull bar and center the tarp.

Roll the tarp up on the pull bar two revolutions. Fig. 7

Fasten the tarp in place by sliding the two urethane bumpers on to the pull bar far enough to touch the edges of the tarp. Lock in place by installing a 1 1/2" long (506-9933) self drilling screw through the bumper and into the hem tube groove of the pull bar.(Fig. 8)

Fig. 8

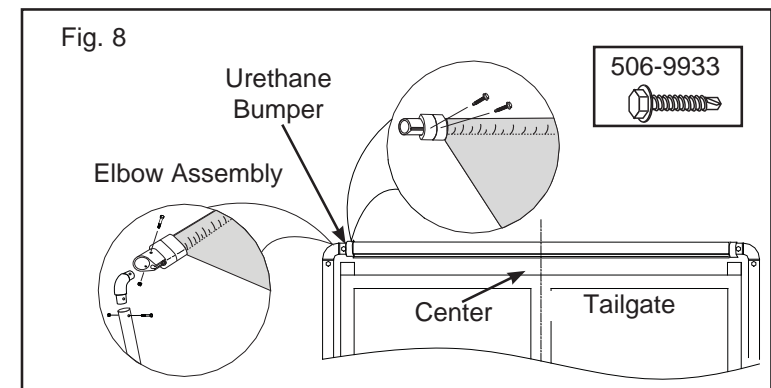

Note: Tarp must be retracted when dumping.

Step 8. Optional Flap Tarp, Rope and Hook Installation

Parts: Tie Down Hooks (Steel or Alum.)



Pull Down Hook



The Location Of The Tie Down Hooks Is Critical !

Flip the braided rope over the corner so that the flaps and tie down ropes hang over each side of the box. The number of tie down hooks vary depending on the length of your tarp. One pull down hook is included with your Pulltarp system. If needed. Use the hook to pull the braided rope and flap over the side of the box.

The tie down hooks must be positioned so that:

- The tie down rope can be reached from the ground.
- The bungee cord has to be stretched to reach the last hook (see step 10).
- The rope has no slack.
- The tie down hooks are level with one another.

To ensure proper hook placement, first duct tape the rope to the box in place of the tie down hooks. Start with hook closest to the cab.

- Position the first hook 6" (15.24cm) down and 12" (30.48cm) forward (toward the cab) from the first grommet (Fig.9).
- Position 2nd hook straight down from 1st grommet. This hook should be reached from ground (Fig.10).
- Place middle hooks equal distances from grommet (Fig.11). These hooks should be placed at the same height as the second hook.
- Position last hook (closest to the tailgate) below the last grommet at the same height as the others (Fig.12).
- Weld hooks in place.

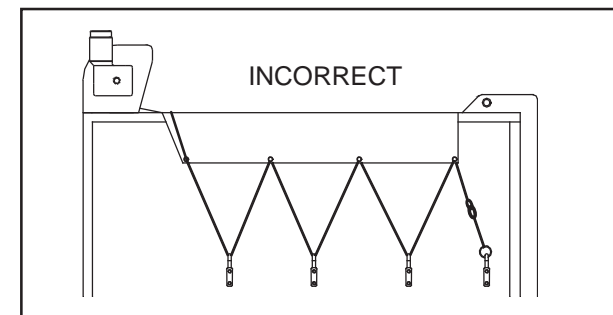
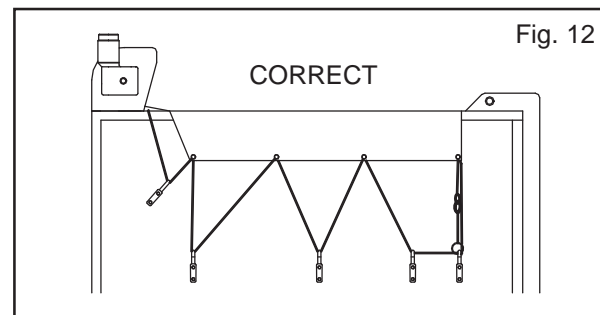
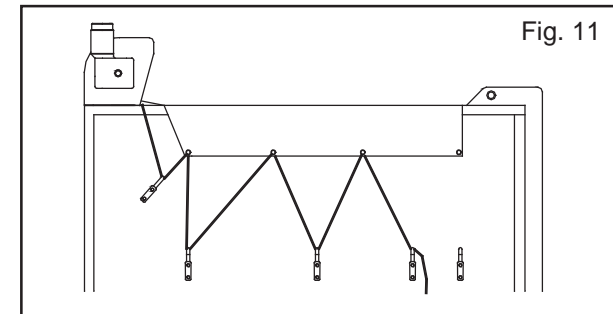
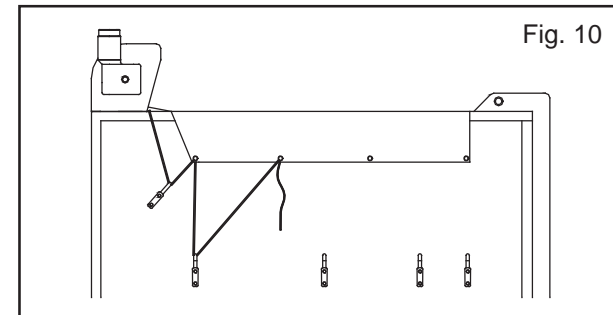
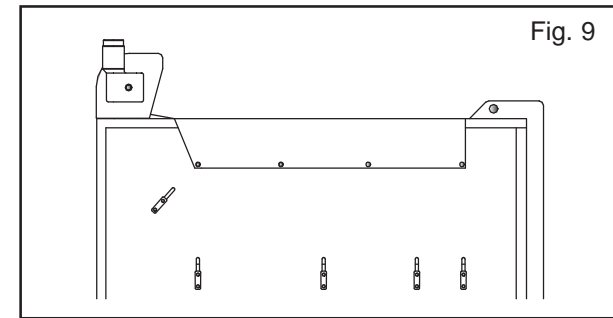

Step 9. Bungee Cord Installation

After side hooks are installed, the tie down rope must be installed and cut to proper length. It is important to get all of the slack out of the rope to prevent blowing and rubbing of flaps in windy conditions.

Parts:

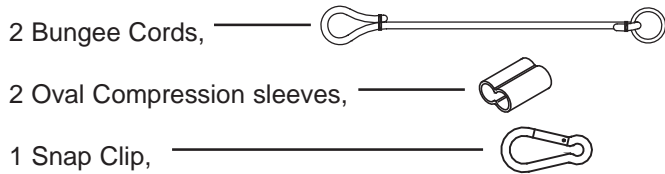

Connect Bungee Cord to Rope

1. Thread braided rope through Oval Compression Sleeve.
2. Feed rope through the eye of the bungee cord.
3. Thread the rope back through the oval compression sleeve. Adjust for proper length. Crimp compression sleeve.

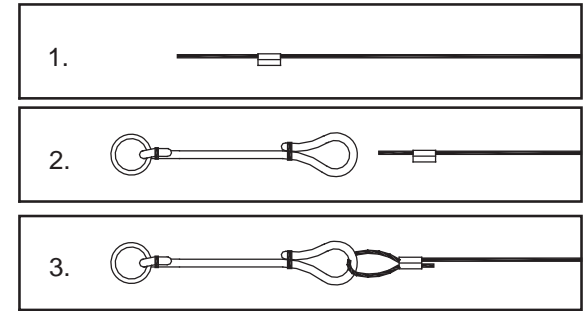

Tarps with Tie Downs

To tighten, pull loose end of rope through the Oval Compression Sleeve (Fig.13). Stretch the bungee cord making sure all slack is taken out of the rope, crimp compression sleeve (Fig.14).

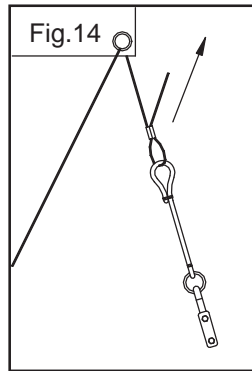
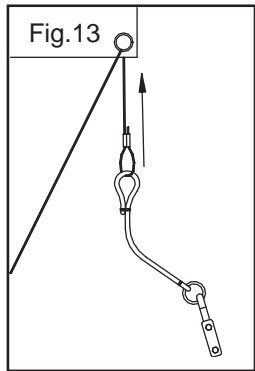

Tarps with Side Flaps

To tighten, pull loose end of rope through the Oval Compression Sleeve (Fig.15). Stretch the bungee cord making sure all slack is taken out of the rope, crimp compression sleeve (Fig. 16).

Note: Check for proper placement of rope through the last two hooks.

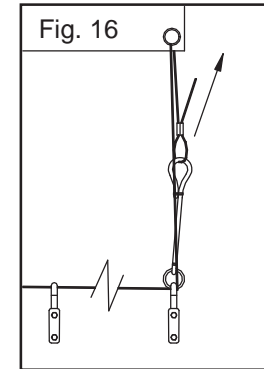
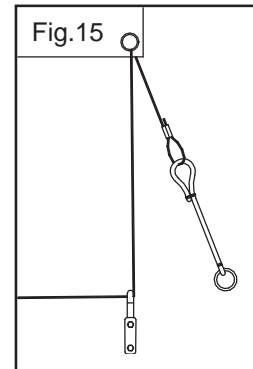

Snap Clip installation

Flip the rope back on top of the tarp, making sure to hold the bungee at all times. The first snap clip is factory installed 5'-6" from the pullrod. Open the clip and enclose the rope. Weave the second clip through the main pullrope where the ends of the bungee cords meet the main pullrope. Make sure the rope is taught when clipped. **NOTE: First snap clip should not be used on long wheel base belly dumps.**

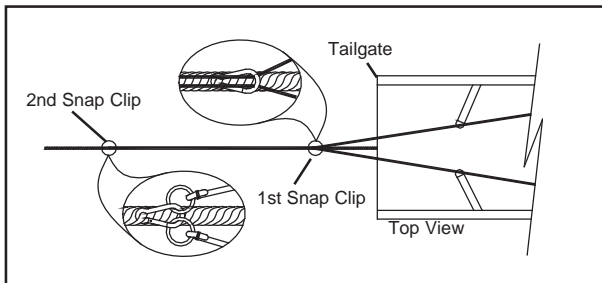

Excess Rope

You may need extra rope to keep the side flap system ground operated. If your application requires extra rope, the slack needs to be taken up by attaching the end of the bungee cord to an alternate hook. (pictured below)

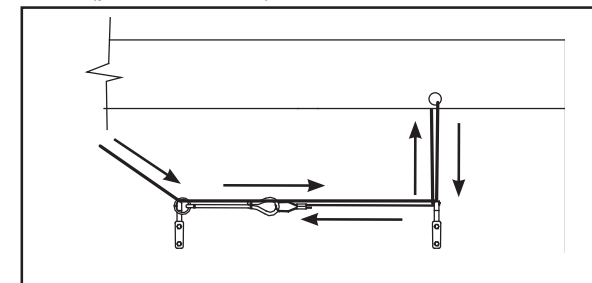

Step 10. Flap/Tie Down Rope Placement and Installation (Fig. 17).

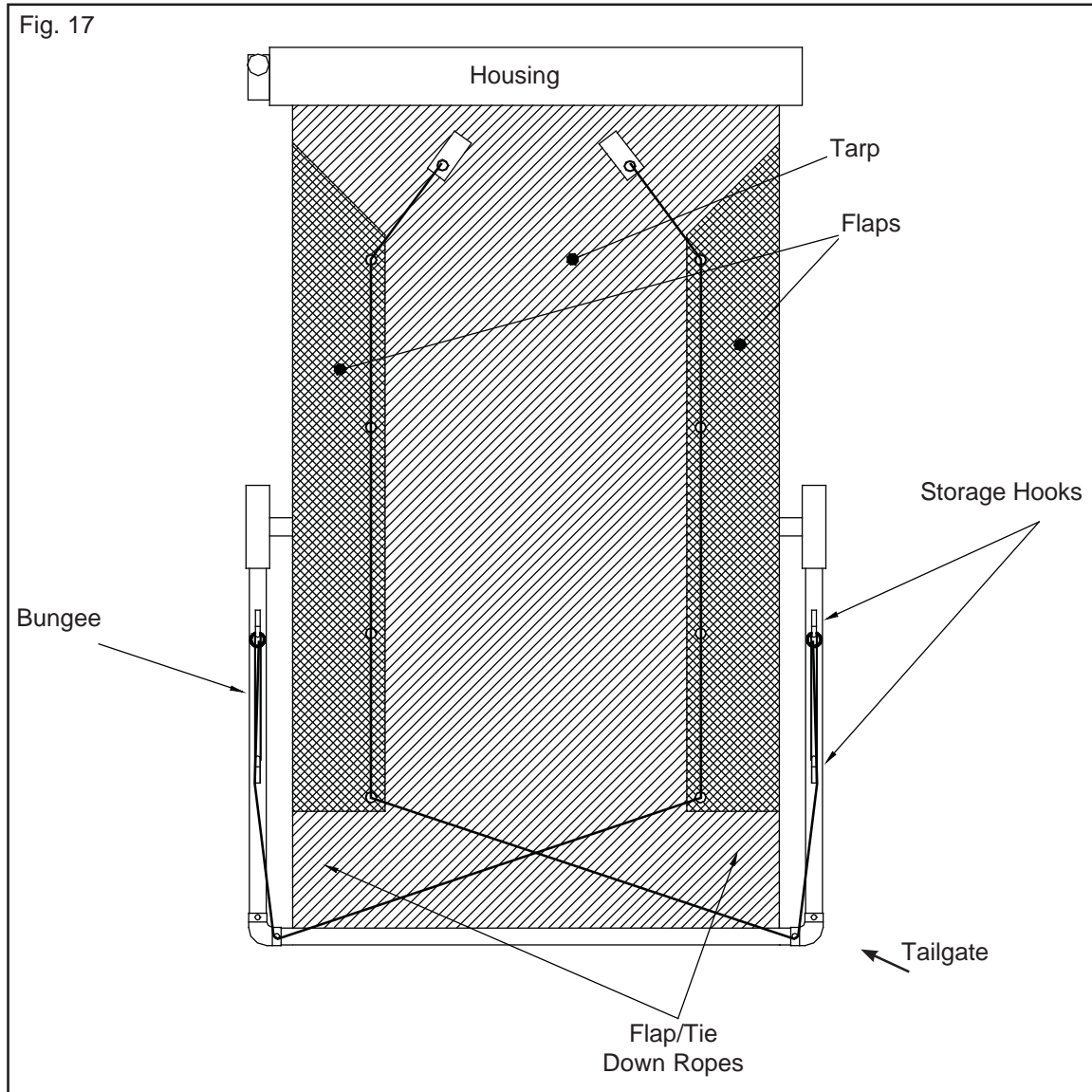

Step 11. Rope Hook Placement

Weld rope storage hook on the top of the arms approx. 32" apart (Fig.18).

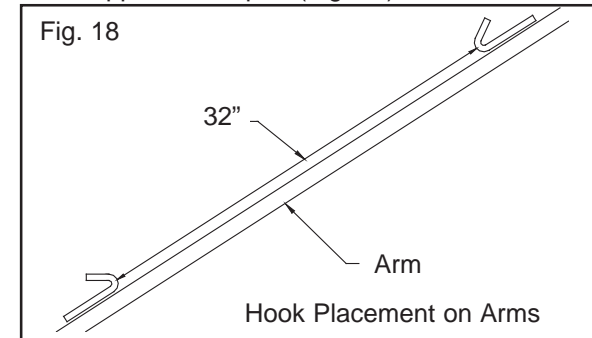

Step 12. Rope Hook Placement For Aluminum Arms

Use Self Drilling screws (part #506-9933) to install Hooks (Fig. 19)

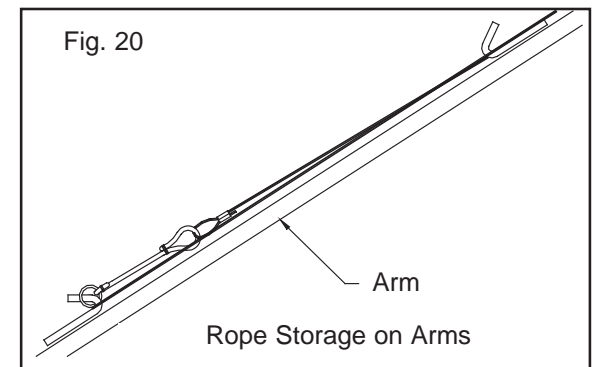
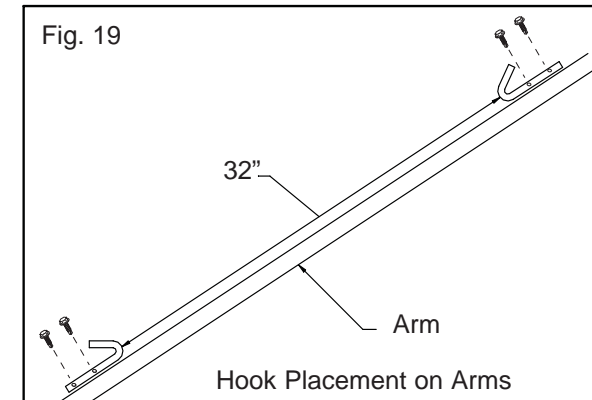

Option #1. Plug Assembly - Part # 514-0505

Assemble the Quick Disconnect as shown in Fig. 21 and Fig. 22.

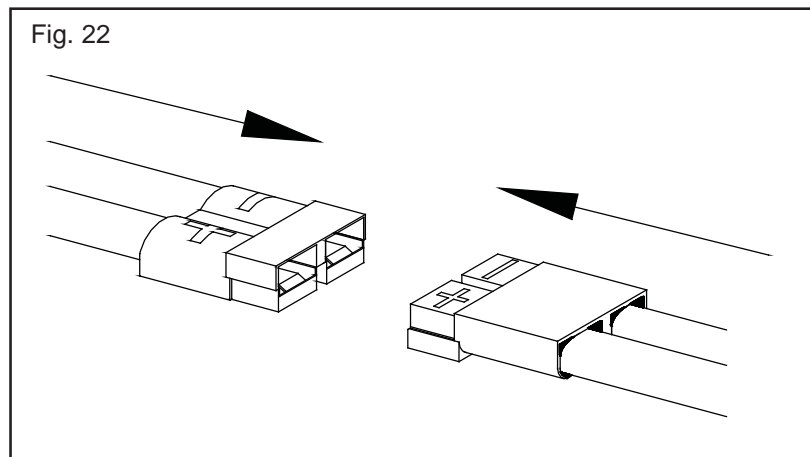
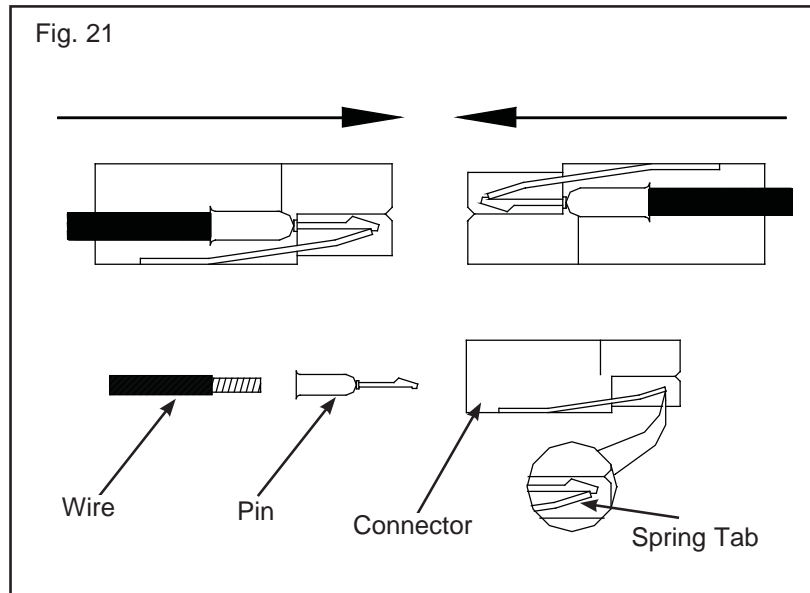

Option #2. Plug Assembly - Part # 514-0501

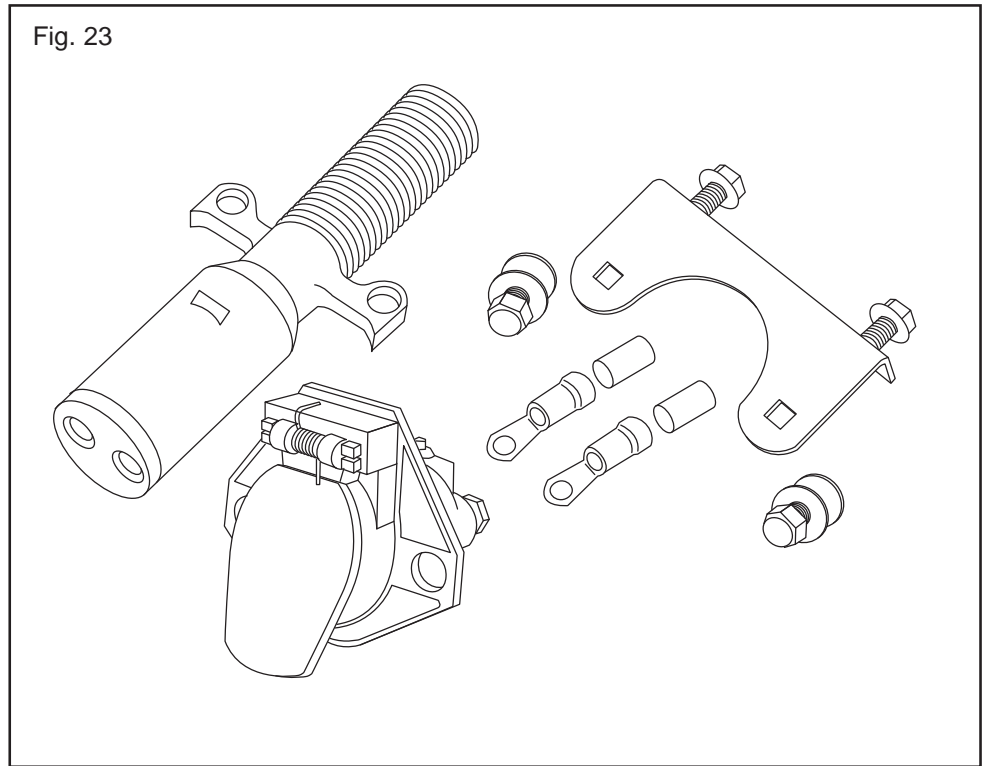

SINGLE SPRING PIVOTS WITH ALUMINUM ARMS

501-0714, 501-0731, 501-0759, 501-0760, 501-0761, 501-0762, 501-0764, 501-0765, 501-0785, 501-0786

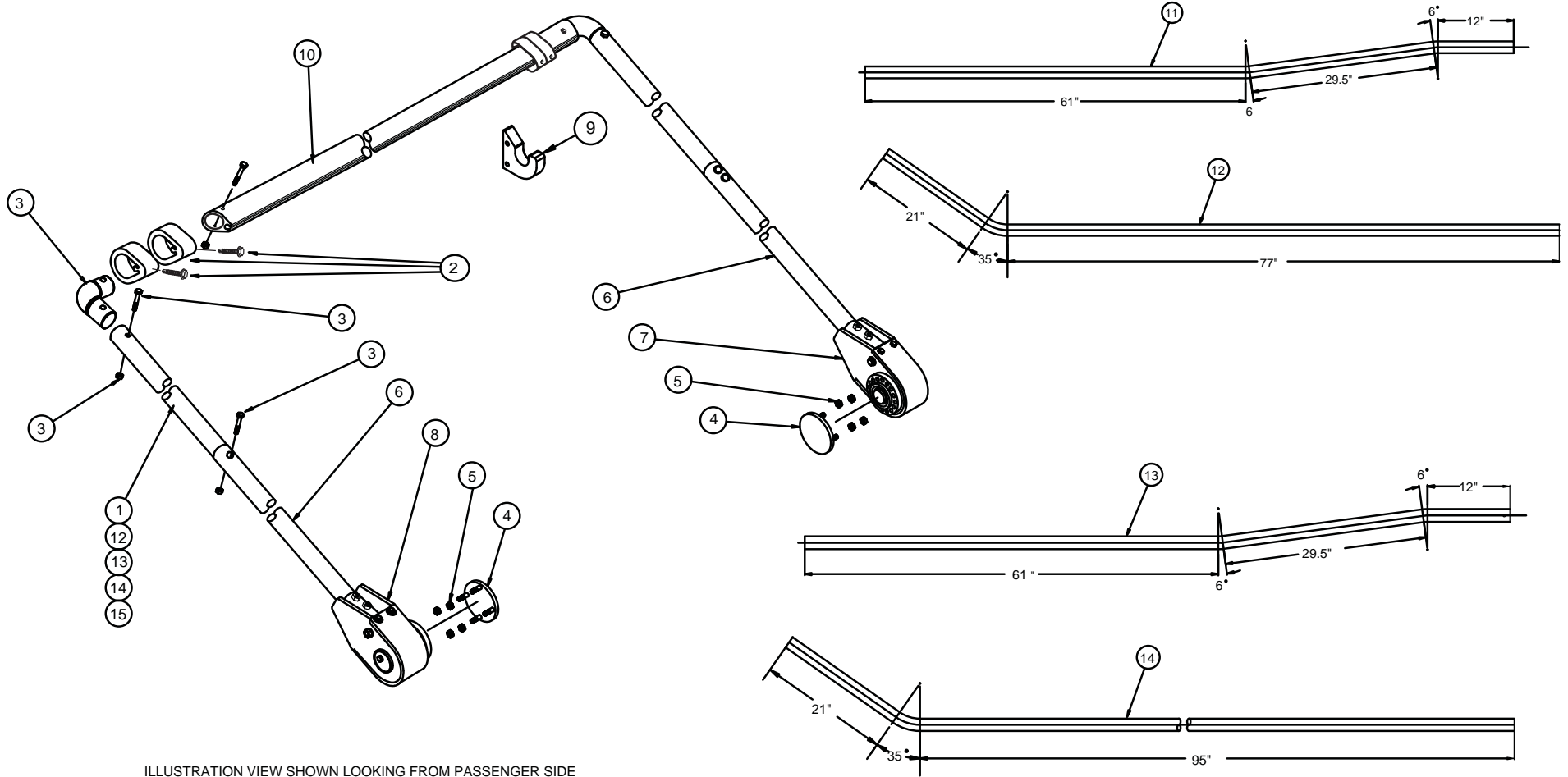

ILLUSTRATION VIEW SHOWN LOOKING FROM PASSENGER SIDE TO REAR OF VEHICLE.

ITEM	PART#	DESCRIPTION	QTY
1	501-1211	ALUMINUM UPPER ARM OR PULLROD	2
2	501-1293	TEAR DROP BUMPER KIT	1
3	501-0791	ELBOW KIT (FOR ALUM. WITH TEAR DROP)	1
4	501-1237	4" ARM ADAPTOR PLATE ASSEMBLY	2
5	504-3705	3/8"-16 NYLOC NUT (THIN)	8
6	501-1209	ALUMINUM LOWER ARM TUBE	2
7	501-1101	SINGLE SPRING HOUSING-DRIVER	1
8	501-1102	SINGLE SPRING HOUSING-PASSENGER	1
9	501-1247	ARM CATCHER ASSEMBLY (OPTIONAL)	1
10	501-0430	UNIVERSAL TEAR DROP PULLBAR	1

ARM OPTIONS

ITEM	PART#	DESCRIPTION	QTY
11	501-1210	ALUMINUM LOWER OFFSET ARM TUBE	2
12	501-1214	UPPER ARM TUBING-DRILLED-BENT	2
13	501-1215	ALUMINUM OFFSET UPPER ARM TUBE	2
14	501-1216	ALUMINUM UPPER ARM TUBE BENT-144"	2
15	501-1212	ALUMINUM UPPER ARM TUBE - 144"	2

GR REV: 06/29/12

SINGLE SPRING PIVOTS WITH STEEL ARMS # 501-0763, 501-0784

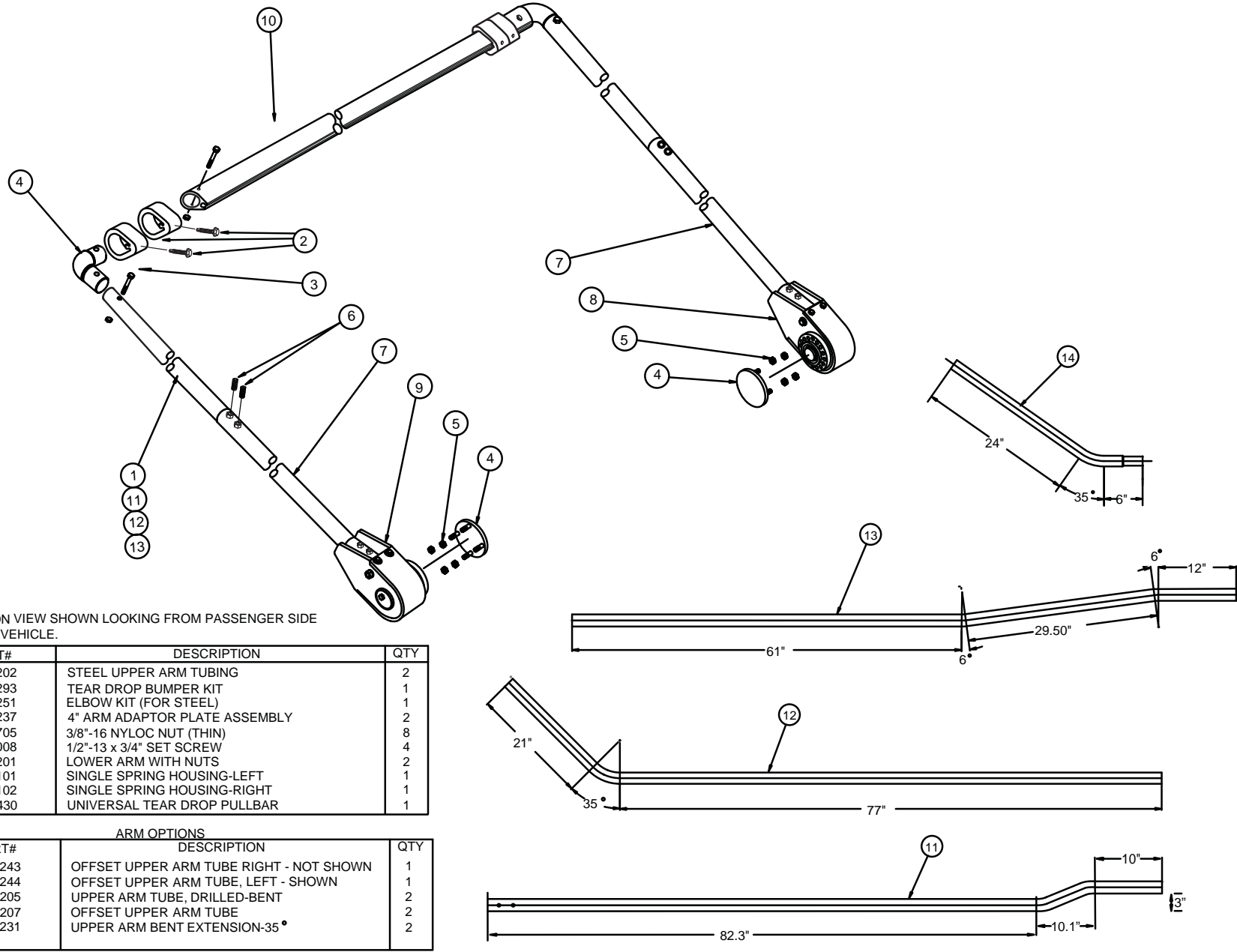

ILLUSTRATION VIEW SHOWN LOOKING FROM PASSENGER SIDE TO REAR OF VEHICLE.

ITEM	PART#	DESCRIPTION	QTY
1	501-1202	STEEL UPPER ARM TUBING	2
2	501-1293	TEAR DROP BUMPER KIT	1
3	501-1251	ELBOW KIT (FOR STEEL)	1
4	501-1237	4" ARM ADAPTOR PLATE ASSEMBLY	2
5	504-3705	3/8"-16 NYLOC NUT (THIN)	8
6	506-5008	1/2"-13 x 3/4" SET SCREW	4
7	501-1201	LOWER ARM WITH NUTS	2
8	501-1101	SINGLE SPRING HOUSING-LEFT	1
9	501-1102	SINGLE SPRING HOUSING-RIGHT	1
10	501-0430	UNIVERSAL TEAR DROP PULLBAR	1

ARM OPTIONS

ITEM	PART#	DESCRIPTION	QTY
11	501-1243	OFFSET UPPER ARM TUBE RIGHT - NOT SHOWN	1
11	501-1244	OFFSET UPPER ARM TUBE, LEFT - SHOWN	1
12	501-1205	UPPER ARM TUBE, DRILLED-BENT	2
13	501-1207	OFFSET UPPER ARM TUBE	2
14	501-1231	UPPER ARM BENT EXTENSION-35°	2

GR REV: 6/28/12

SINGLESPRING HOUSING ASSEMBLY

(#501-1101DRVR.) SHOWN
(#501-1102PASS.) OPPOSITE

USED WITH SYSTEMS #202-0215, 203-0215, 211-0215, 212-0215,
213-0215, 214-0215, 215-0215, 218-0215, 222-0215

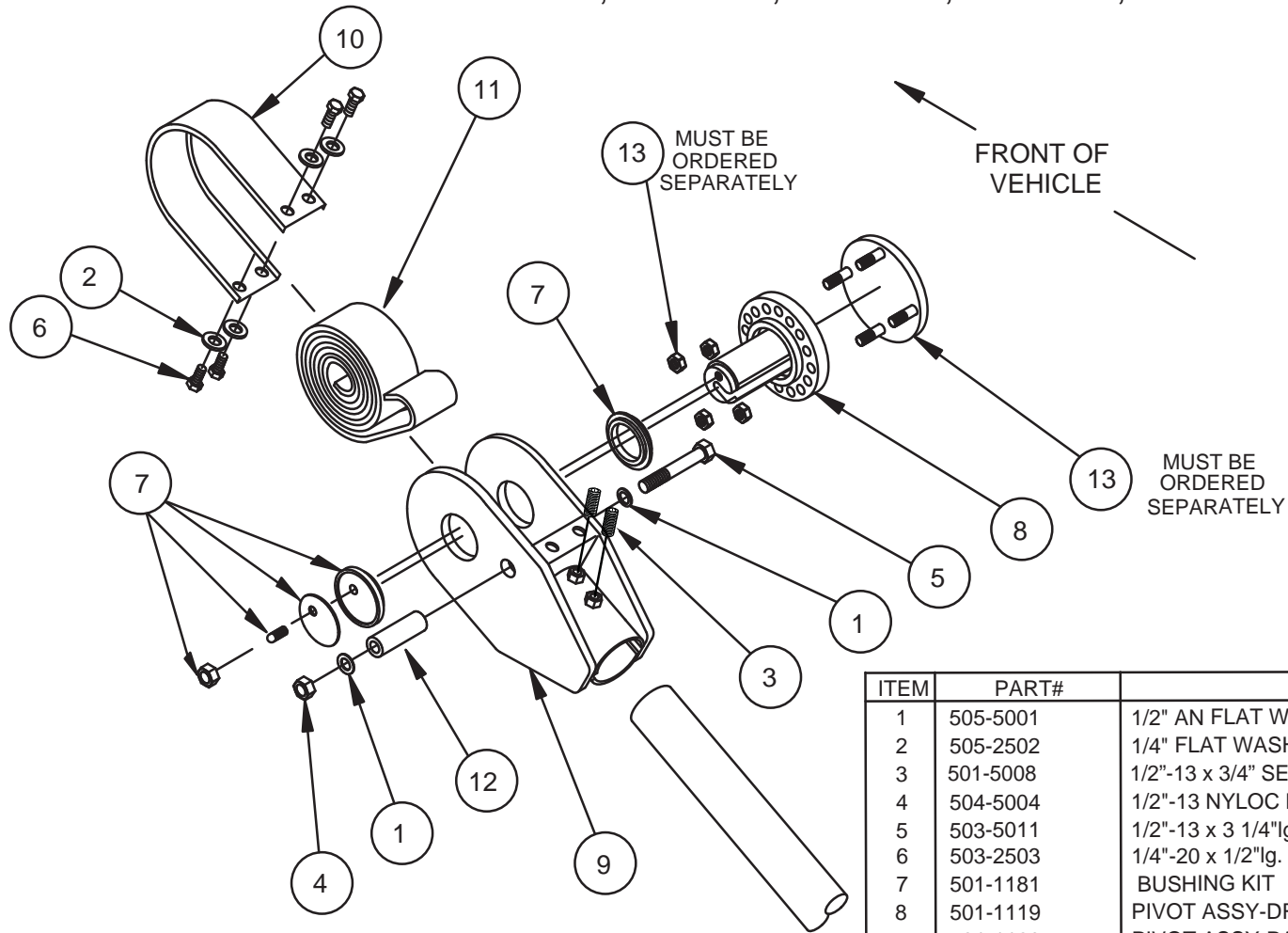

ITEM	PART#	DESCRIPTION	QTY
1	505-5001	1/2" AN FLAT WASHER	2
2	505-2502	1/4" FLAT WASHER USS	4
3	501-5008	1/2"-13 x 3/4" SET SCREW	4
4	504-5004	1/2"-13 NYLOC NUT	1
5	503-5011	1/2"-13 x 3 1/4"lg. HHCS BOLT	1
6	503-2503	1/4"-20 x 1/2"lg. HHCS BOLT	4
7	501-1181	BUSHING KIT	1
8	501-1119	PIVOT ASSY-DRIVER SIDE	1
	501-1120	PIVOT ASSY-PASS. SIDE (NOT SHOWN)	1
9	501-1109	SPRING SIDE PLATE ASSEMBLY	1
10	501-1151	ARM DUST COVER	1
11	501-1156	ROLLED SPRING ASSY. W/STRIP	1
12	501-1158	SPRING CONNECTION PIN	1
13	501-1237	4" ARM ADAPTOR PLATE ASSEMBLY	1

NOT PART OF KIT
MUST BE
ORDERED SEPARATELY

BAB REV: 12/4/08