

Installation Instructions - Super Six Electric Arm Kits with Underbody Pivots

501-2112, 501-2113, 501-2114, 501-2115

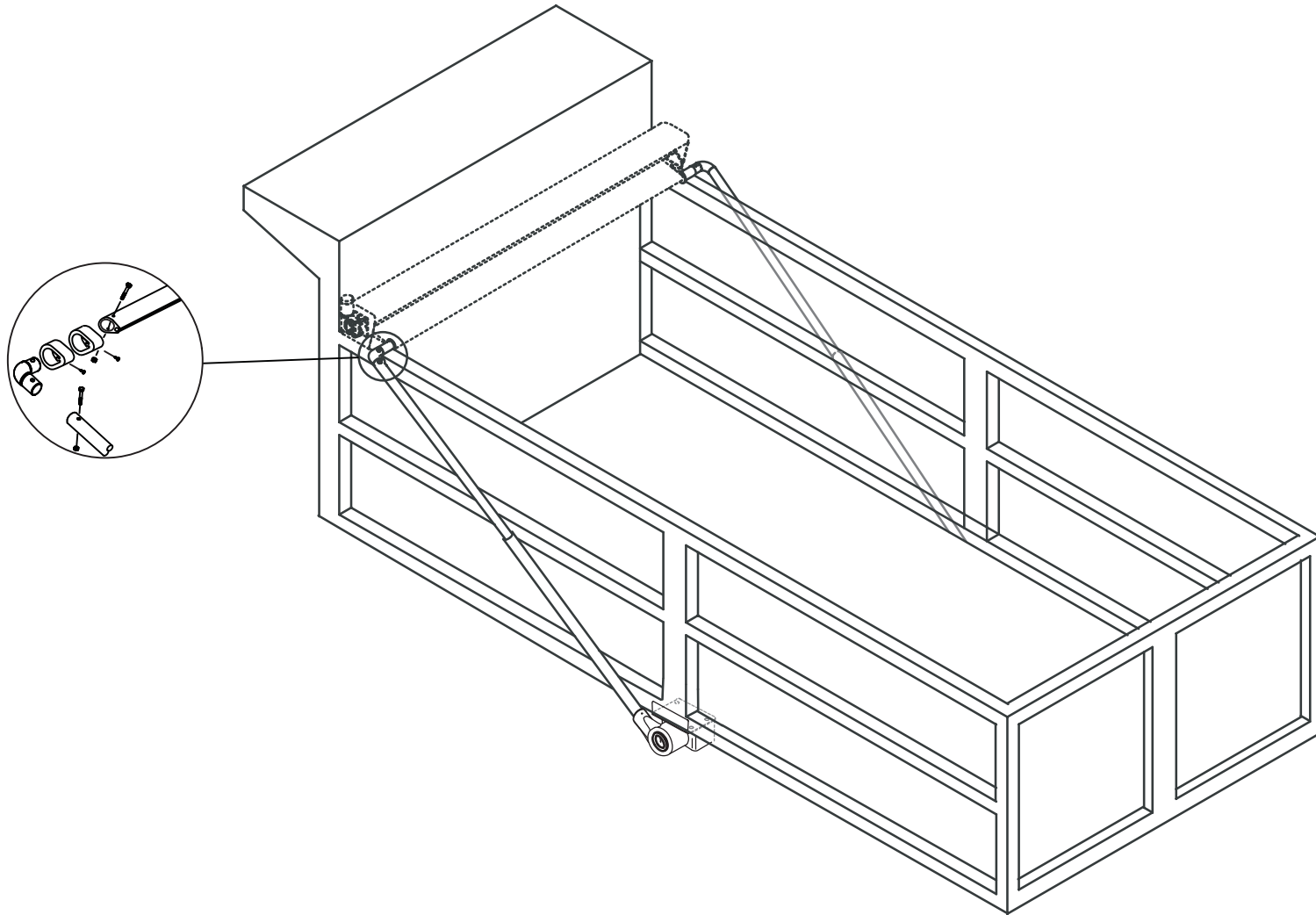

Step 1. Determining the Pivot Points and Mounting Locations

Locate the proper mounting positions by determining Point "A" and Point "B" and insuring measurement "D" and "E" are equal (Fig.1a & 1b). Point "C" must be located as low as possible. Mark pivot location.

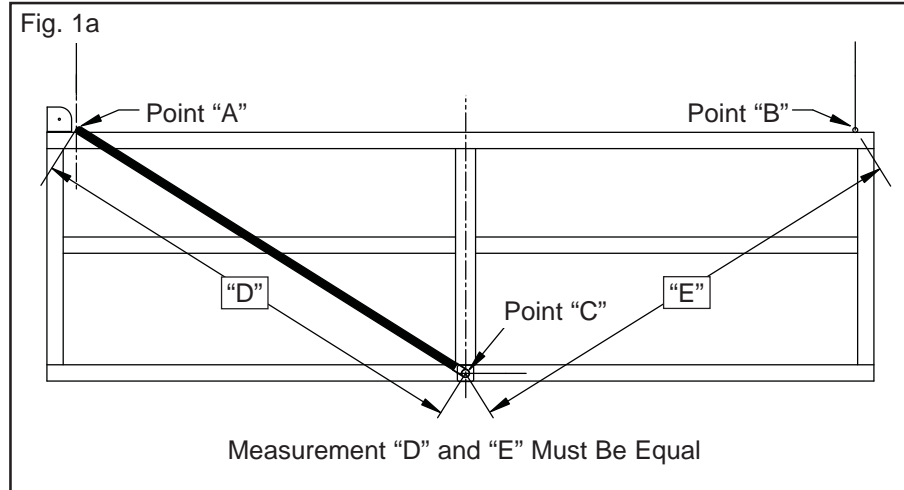

Step 2. Mounting the Pivot

Mark the Pivot Center Point on Truck body. (fig. 2a)

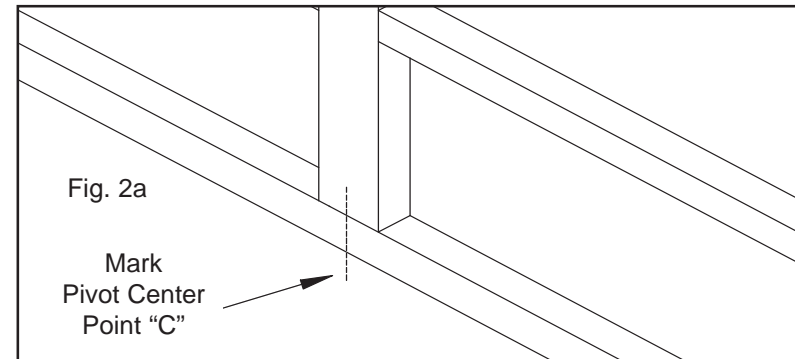

Bolt or weld the Under Body Pivot housings to truck body.
(fig. 2b) Bolts are not provided.

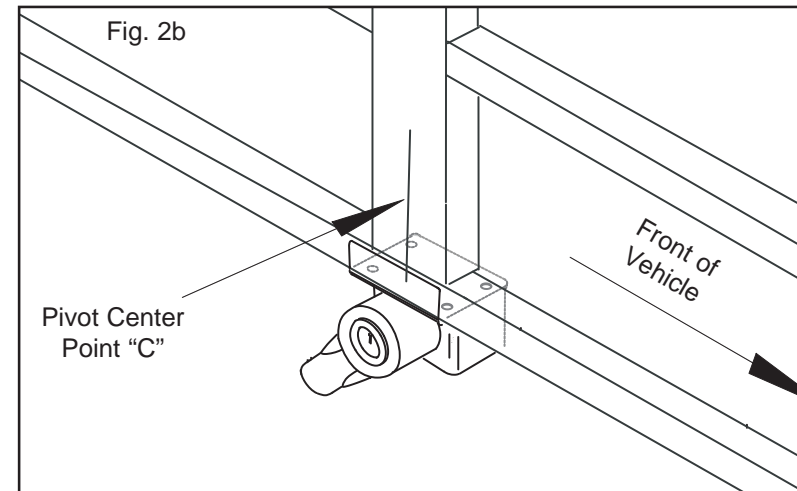
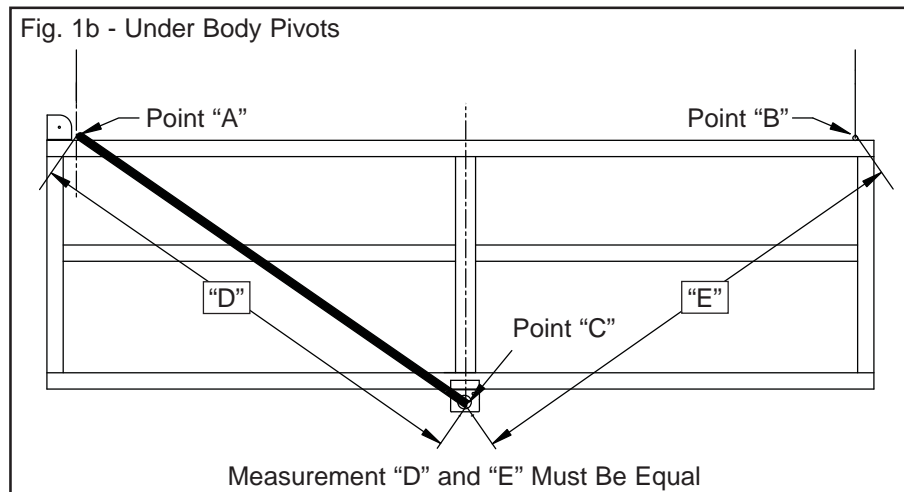

Step 4. Correct Alignment of arms to truck

Arms and Pivots must be square and parallel to truck (Fig.4).

Dimension "A" must equal "B"
Dimension "C" must equal "D"
Dimension "E" must equal "F"

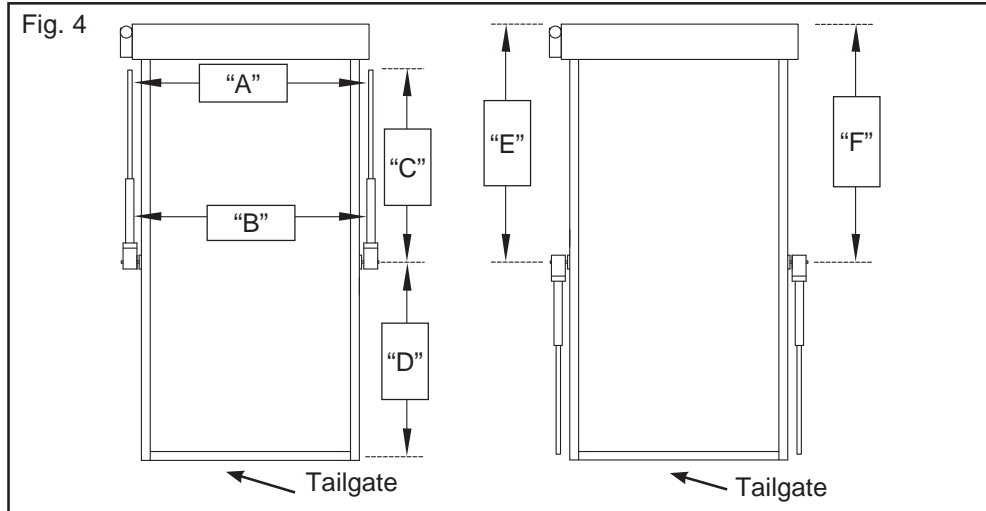

Step 5. Adjust the Arms on both sides to be the same length.

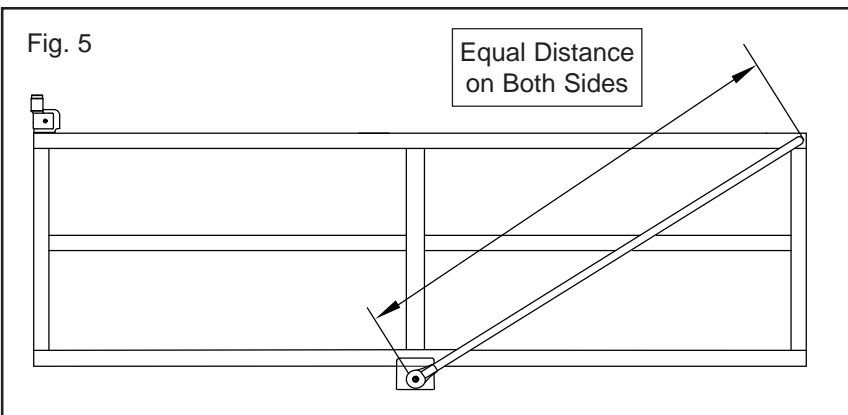

Step 6. Tarp Installation

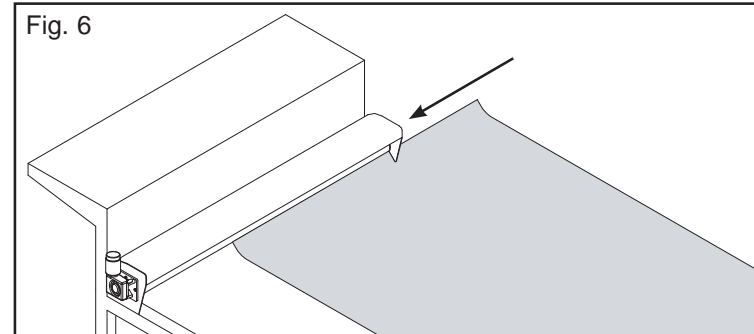

Step 7. Installing the Pullbar

Cut the pull bar to length making sure the arms remain parallel and square to the body.

Slide the tarp into groove in the pull bar and center the tarp.

Roll the tarp up on the pull bar two revolutions. Fig. 7

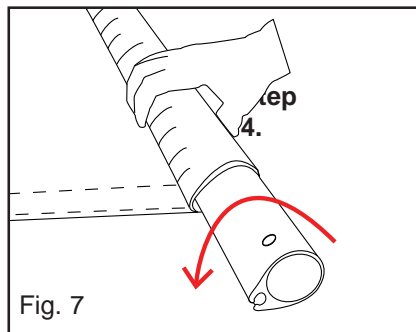

Fasten the tarp in place by sliding the two urethane bumpers on to the pull bar far enough to touch the edges of the tarp. Lock in place by installing a 1 1/2" long (506-9933) self drilling screw through the bumper and into the hem tube groove of the pull bar.(Fig. 8)

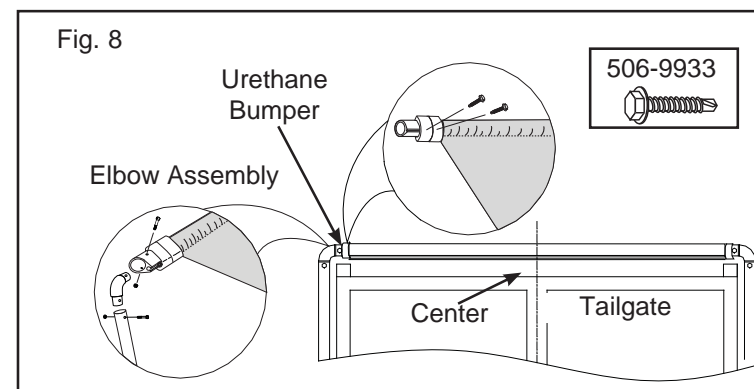

Note: Tarp must be retracted when dumping.

Step 9. Optional Flap Tarp, Rope and Hook Installation

Parts: Tie Down Hooks (Steel or Alum.)



Pull Down Hook



The Location Of The Tie Down Hooks Is Critical !

Flip the braided rope over the corner so that the flaps and tie down ropes hang over each side of the box. The number of tie down hooks vary depending on the length of your tarp. One pull down hook is included with your Pulltarp system. If needed. Use the hook to pull the braided rope and flap over the side of the box.

The tie down hooks must be positioned so that:

- The tie down rope can be reached from the ground.
- The bungee cord has to be stretched to reach the last hook.
- The rope has no slack.
- The tie down hooks are level with one another.

To ensure proper hook placement, first duct tape the rope to the box in place of the tie down hooks. Start with hook closest to the cab.

1. Position the first hook 6" (15.24cm) down and 12" (30.48cm) forward (toward the cab) from the first grommet (Fig.9).
2. Position 2nd hook straight down from 1st grommet. This hook should be reached from ground (Fig.10).
3. Place middle hooks equal distances from grommet (Fig.11). These hooks should be placed at the same height as the second hook.
4. Position last hook (closest to the tailgate) below the last grommet at the same height as the others (Fig.12).
5. Weld hooks in place.

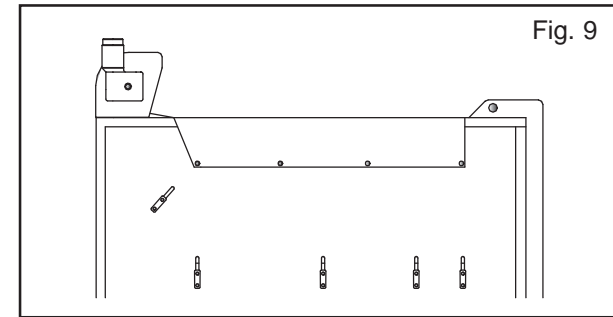

Fig. 9

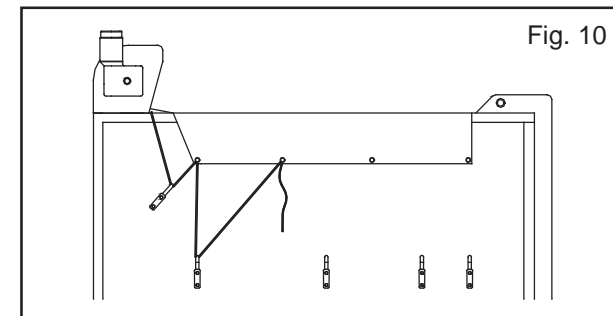

Fig. 10

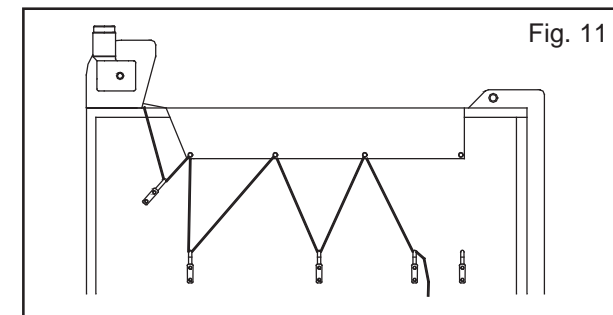

Fig. 11

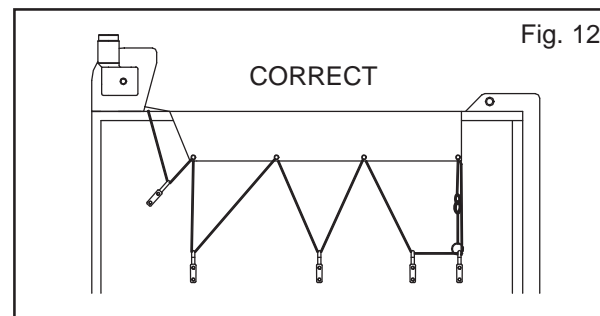
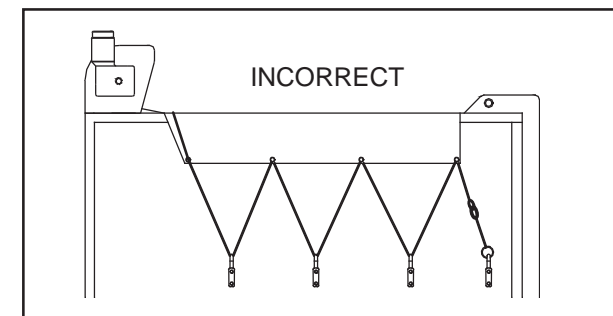

Fig. 12



Step 10. Bungee Cord Installation

After side hooks are installed, the tie down rope must be installed and cut to proper length. It is important to get all of the slack out of the rope to prevent blowing and rubbing of flaps in windy conditions.

Parts:

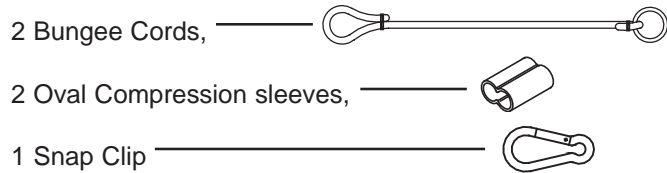

Connect Bungee Cord to Rope

1. Thread braided rope through Oval Compression Sleeve.
2. Feed rope through the eye of the bungee cord.
3. Thread the rope back through the oval compression sleeve. Adjust for proper length. Crimp compression sleeve.

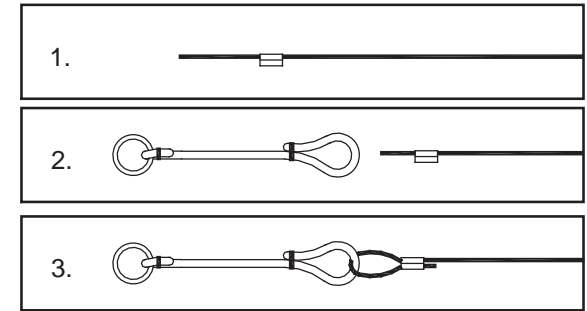

Tarps with Side Flaps

To tighten, pull loose end of rope through the Oval Compression Sleeve (Fig.13). Stretch the bungee cord making sure all slack is taken out of the rope, crimp compression sleeve (Fig.14).

Note: Check for proper placement of rope through the last two hooks.

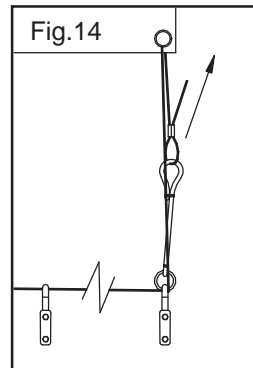
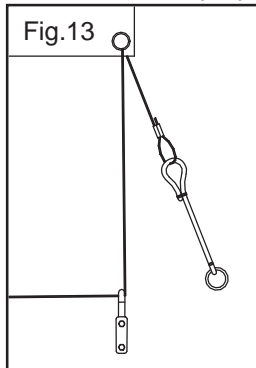

Configuring Snap Clip installation

Flip the tie down ropes on top of the tarp, making sure to hold the bungee at all times. The first snap clip is installed 5'-6" from the pullrod. Open the clip and enclose the tie down ropes. Pull the tie down ropes along the pullrod until the rings at the ends of the bungees meet. Weave the second clip through the main pullrod where the ends of the bungee cords meet the main pullrod. Clip the rings at the ends of the bungees to the pullrod. Make sure the rope is just slightly taut when clipped. *NOTE: First snap clip should not be used on long wheel base belly dumps.*

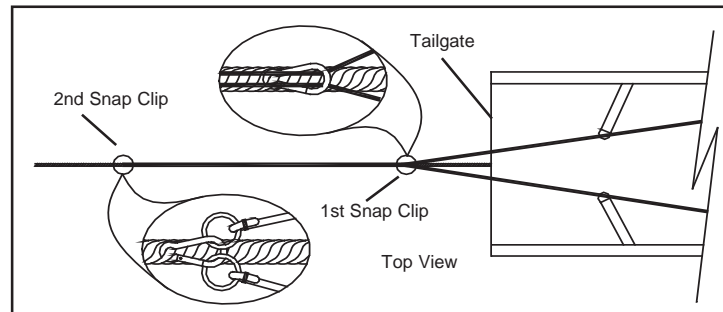

Excess Rope

You may need extra rope to keep the side flap system ground operated. If your application requires extra rope, the slack needs to be taken up by attaching the end of the bungee cord to an alternate hook. (Fig. 15)

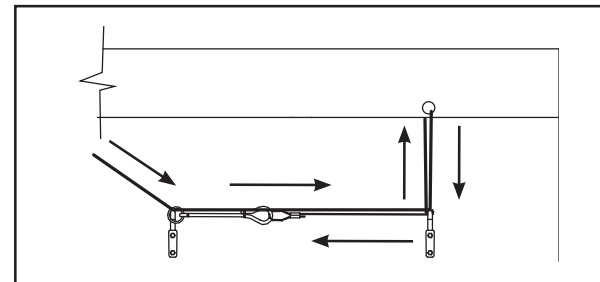

Step 11. Flap/Tie Down Rope Placement and Installation (Fig.15).

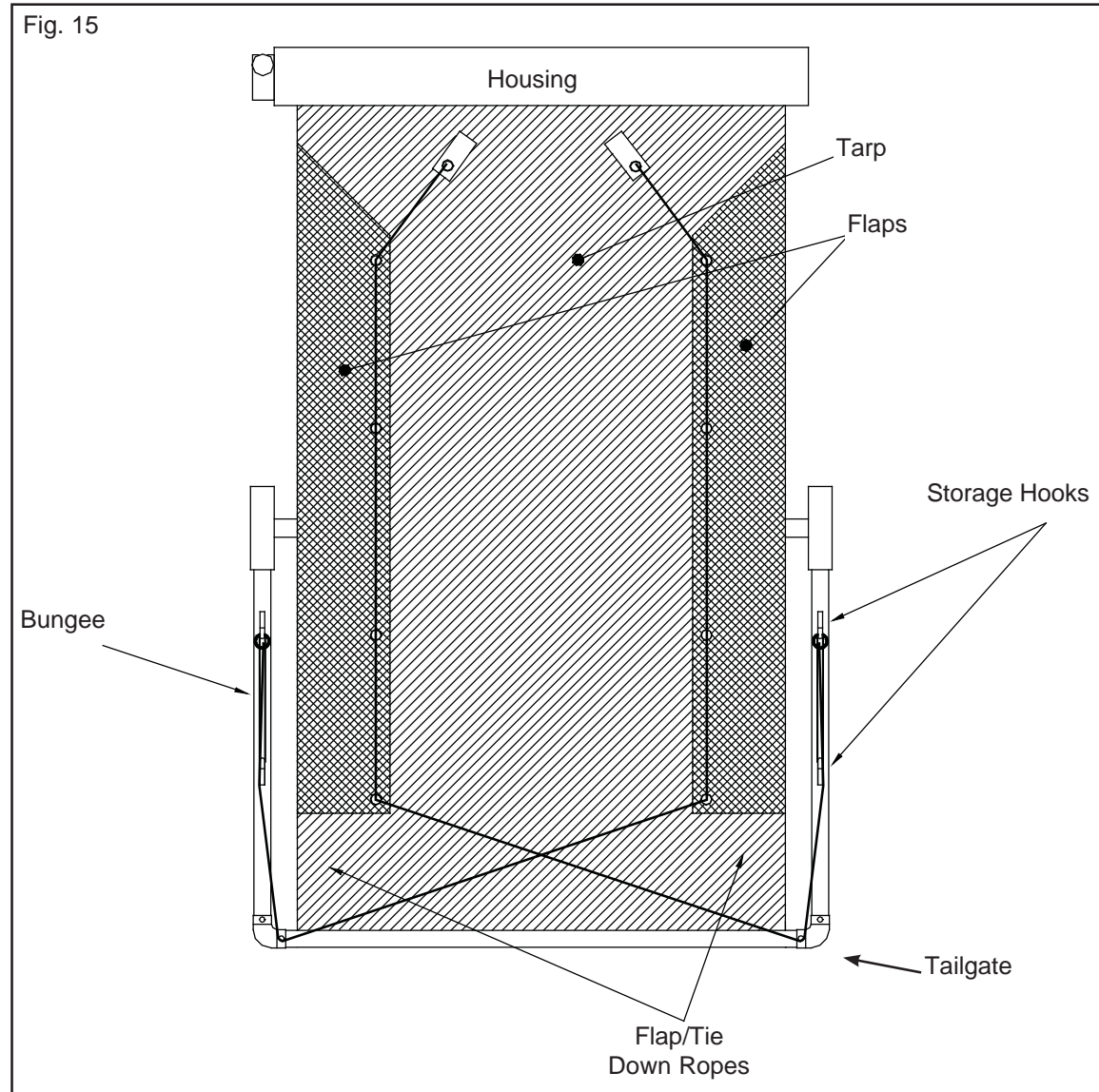

Step 12. Rope Hook Placement

Weld rope storage hook on the top of the arms approx. 32" apart (Fig.16).

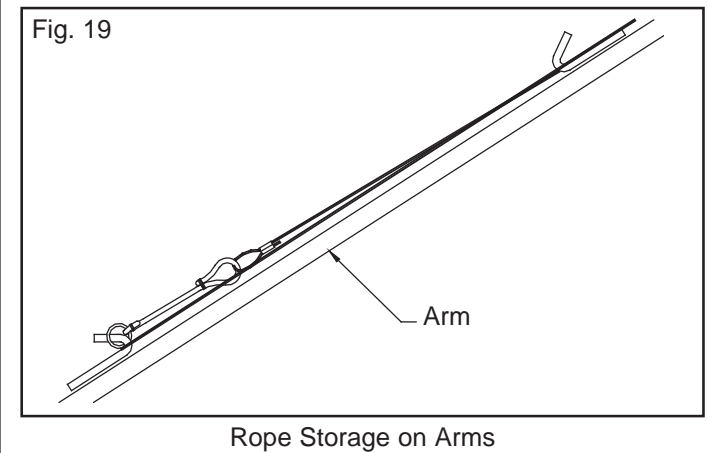
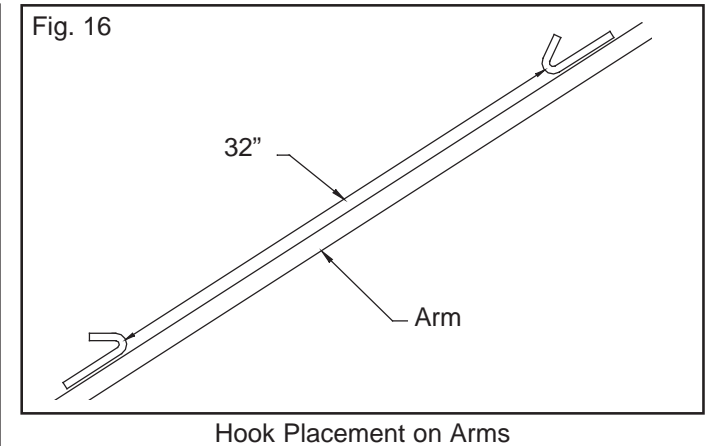

SIX SPRING UNDERBODY PIVOT ASSEMBLY 501-2109 LEFT SIDE - (SHOWN) 501-2110 RIGHT SIDE

ITEM NO.	PART NUMBER	DESCRIPTION	QTY.
1	501-2116	END CAP WITH BEARING	2
2	517-9966	SPRING, UNDERBODY ARM SYSTEM	6
3	501-2108	Underbody Pivot Mount Assy.	1
4	501-2106	6 Spring Housing Assembly	1
5	501-1162	WASHER 1-7/8 X 1-1/4 NARROW RIM	3
6	506-0101	1 1/4" SNAP RING	1
7	503-3712	3/8-16 X 3" HHCS BOLT ZC	1
8	504-3702	NUT, 3/8-16 HEX NUT NYLOC ZINC PLT	1

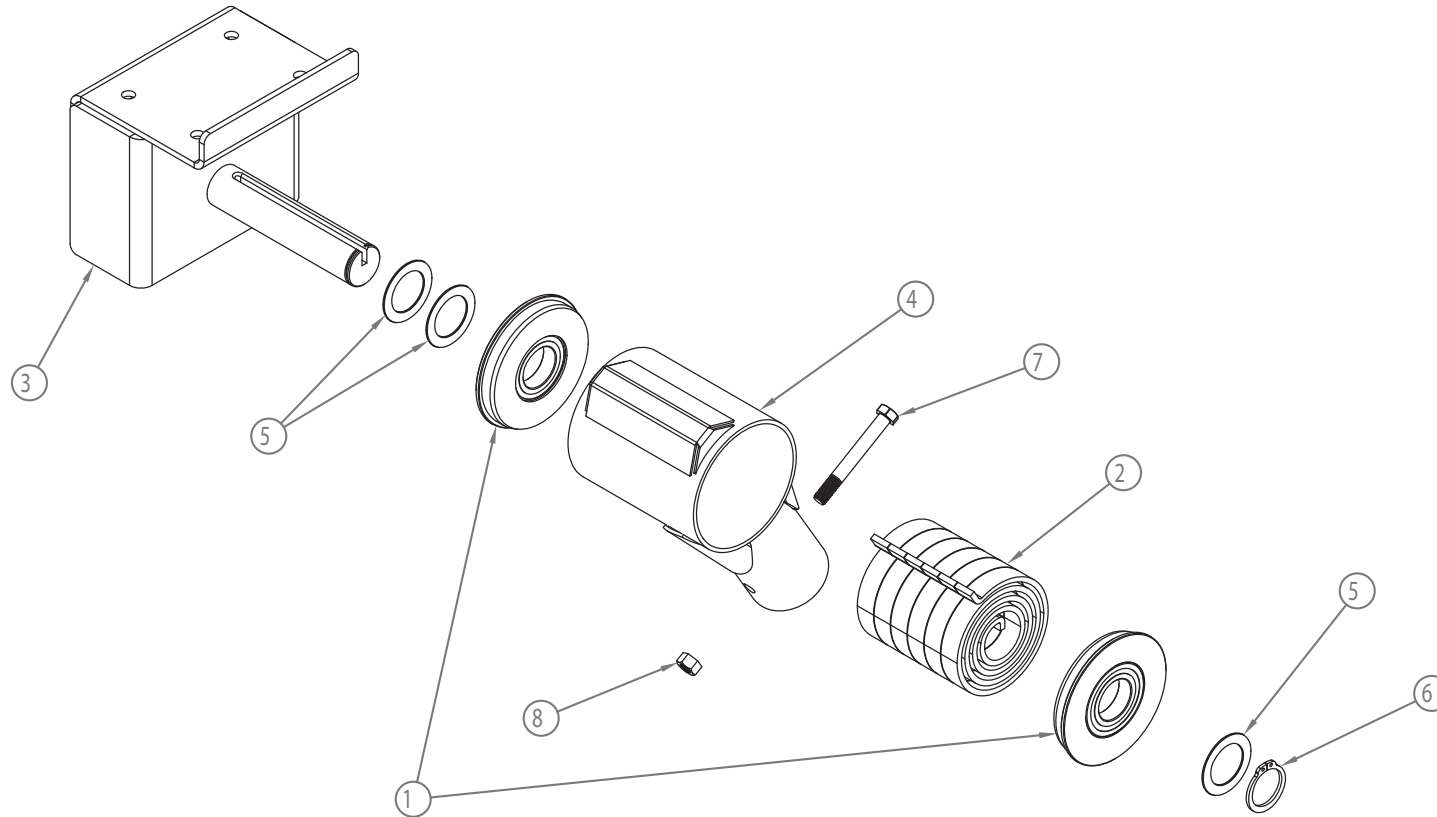

SIX SPRING UNDERBODY KIT WITH STRAIGHT STEEL ARMS 501-2112

ITEM NO.	PART NUMBER	DESCRIPTION	QTY.
1	501-2110	GEN III 6 Spring Right Housing Assy.	1
2	501-2109	GEN III 6 Spring Left Housing Assy.	1
3	501-0430	UNIVERSAL TEAR DROP PULLROD 103"	1
4	501-1251	(STEEL) ELBOW & UPPER CONN HARDWARE	1
5	501-1293	TEAR DROP BUMPER KIT	1
6	514-0122	6GA WIRE 80' LONG	1
7	501-1201	LOWER ARM TUBE WITH NUTS	2
8	501-1202	STEEL UPPER ARM TUBING- DRILLED	2

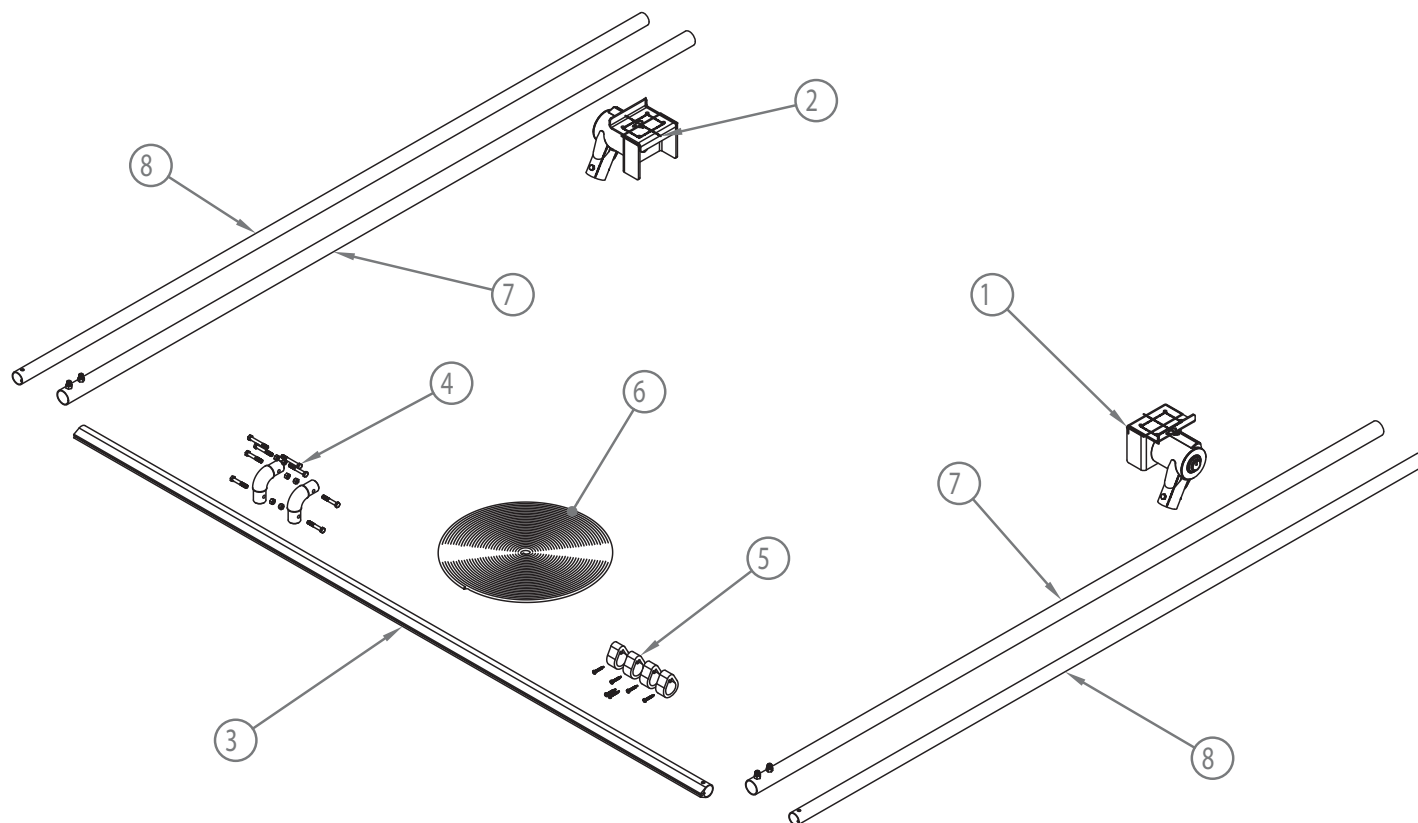

STEEL SIX SPRING UNDERBODY STEEL ARM KIT WITH BENT UPPER ARMS 501-2113

ITEM NO.	PART NUMBER	DESCRIPTION	QTY.
1	501-2110	GEN III 6 Spring Right Housing Assy.	1
2	501-2109	GEN III 6 Spring Left Housing Assy.	1
3	501-0430	UNIVERSAL TEAR DROP PULLROD 103"	1
4	501-1251	(STEEL) ELBOW & UPPER CONN HARDWARE	1
5	501-1293	TEAR DROP BUMPER KIT	1
6	514-0122	6GA WIRE 80' LONG	1
7	501-1201	LOWER ARM TUBE WITH NUTS	2
8	501-1205	UPPER ARM TUBING - DRILLED- BENT	2

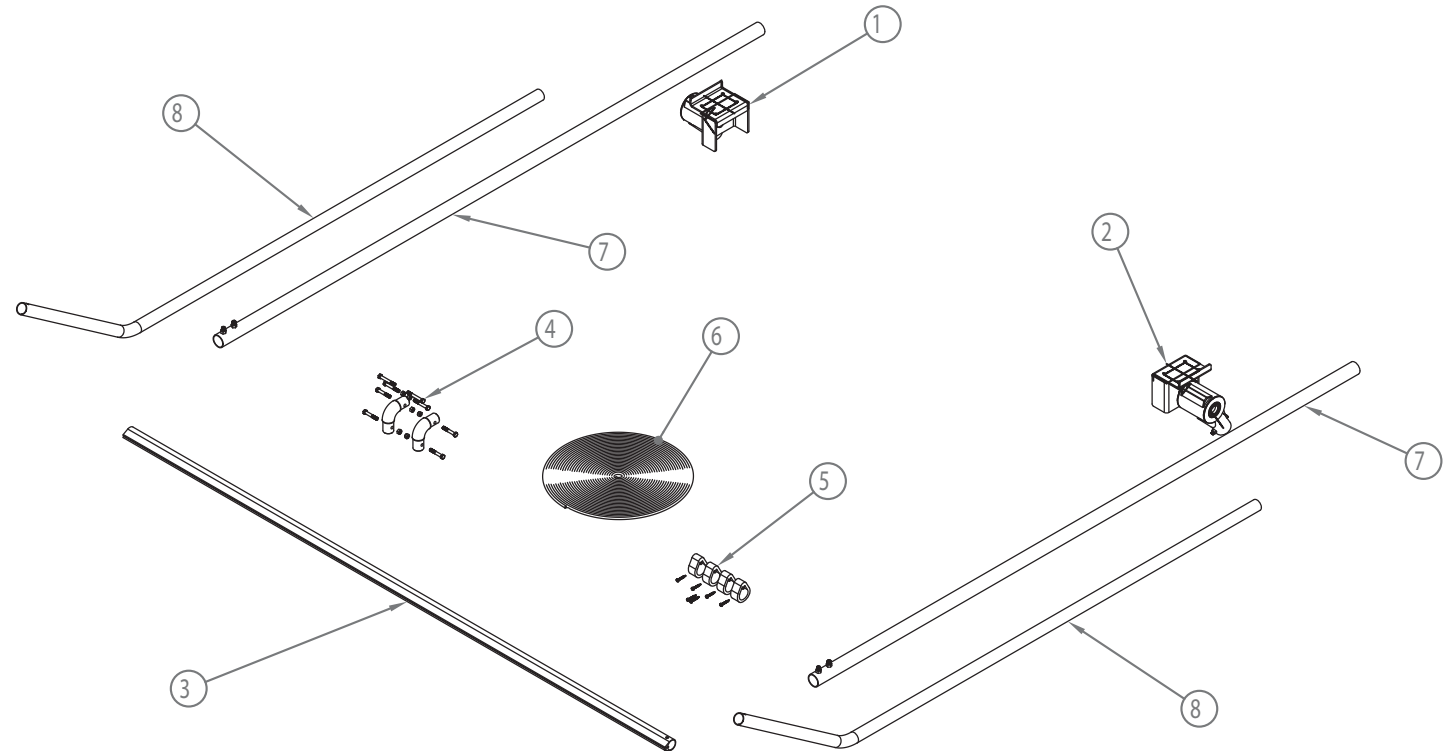

SIX SPRING UNDERBODY KIT WITH ALUMINUM ARMS 501-2114 STRAIGHT ARMS

501-2115 WITH BENT UPPER ARMS

ITEM NO.	PART NUMBER	DESCRIPTION	QTY.
1	501-2110	GEN III 6 Spring Right Housing Assy.	1
2	501-2109	GEN III 6 Spring Left Housing Assy.	1
3	501-0430	UNIVERSAL TEAR DROP PULLROD 103"	1
4	501-0791	STL/ALUM ELBOW AND UPPER CONN	1
5	501-1293	TEAR DROP BUMPER KIT	1
6	514-0122	6GA WIRE 80' LONG	1
7	501-1211	ALUM. UPPER ARM OR PULLROD	2
8	501-1209	ALUM. LOWER ARM TUBE - 103" LONG	2
9	501-1214	OPTIONAL - ALUM. UPPER ARM, BENT	2

