



## Installation Instructions

## Manual Arm Kits

### Related Instructions & How-To Videos



[PDF: Offset Bracket Installation](#)



[PDF: Ratchet Operation](#)



[Video: Ratchet Lock Operation](#)



[PDF: Tarp Wind Matrix](#)



[Pulltarps Resources](#)

Steel #113-2214 / #113-2215 & Aluminum #113-2224 / #113-2225

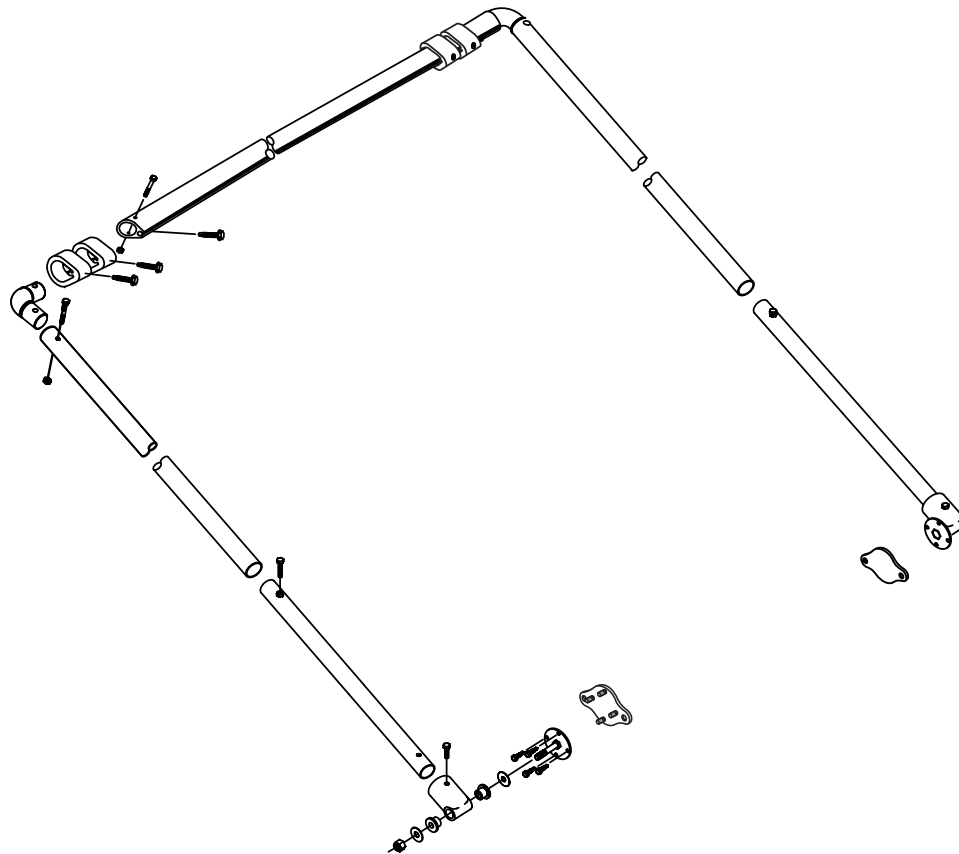

**DURING INSTALLATION, SOME FABRICATION MAY BE REQUIRED.**

607-0033

WLH 11/02/20



A Safe Fleet Brand



Installation Instructions

Manual Arm Kits

TABLE OF CONTENTS

Parts & Tools		Installation Instructions	
Steel Manual Arms (Complete Kits) #113-2214, 113-2215 .....		2 Determining the Pivot Point .....	6-7
Aluminum Manual Arm Kits #113-2224, #113-2225 .....		3 Mounting the Pivot Point & Installing the Pullbar .....	8-9
Required Tools .....		4 Operating the System .....	11

**PULLTARPS**

A Safe Fleet Brand



**Installation Instructions**

**Manual Arm Kits**

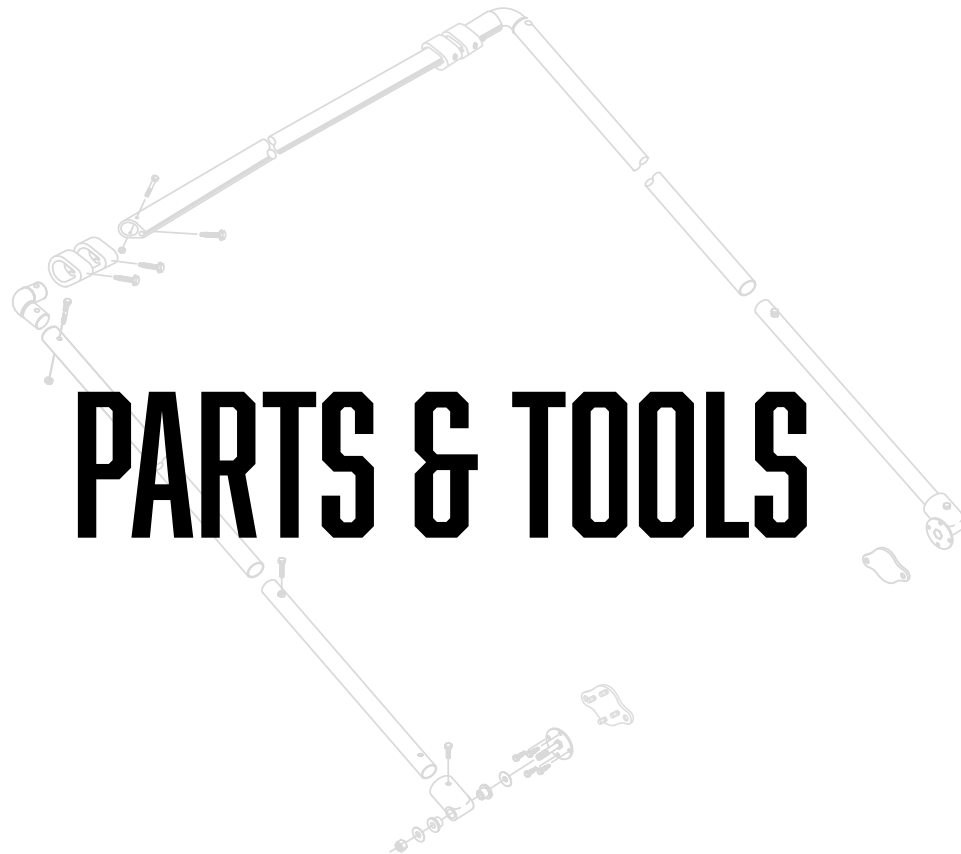



### Steel Manual Arms (Complete Kits) #113-2214, 113-2215

ITEM	PART #	DESCRIPTION	QTY
1	501-1251	Elbow Kit (Steel Arms)	1
2	501-0430	Universal Tear Drop Pullbar	1
3	501-1195	Pivot Assembly	2
4	501-1229	Lower Connection Arm Tube	2
5	501-1293	Tear Drop Bumper Kit	1
6	501-2235	EZ-Mount Assembly	2

#### Arm Options

ITEM	PART #	DESCRIPTION	QTY
7	501-1202	Straight Upper Arm	2
8	501-1205	Upper Arm Tubing-Drilled-Bent	2

REV. 04/10/19 WLH

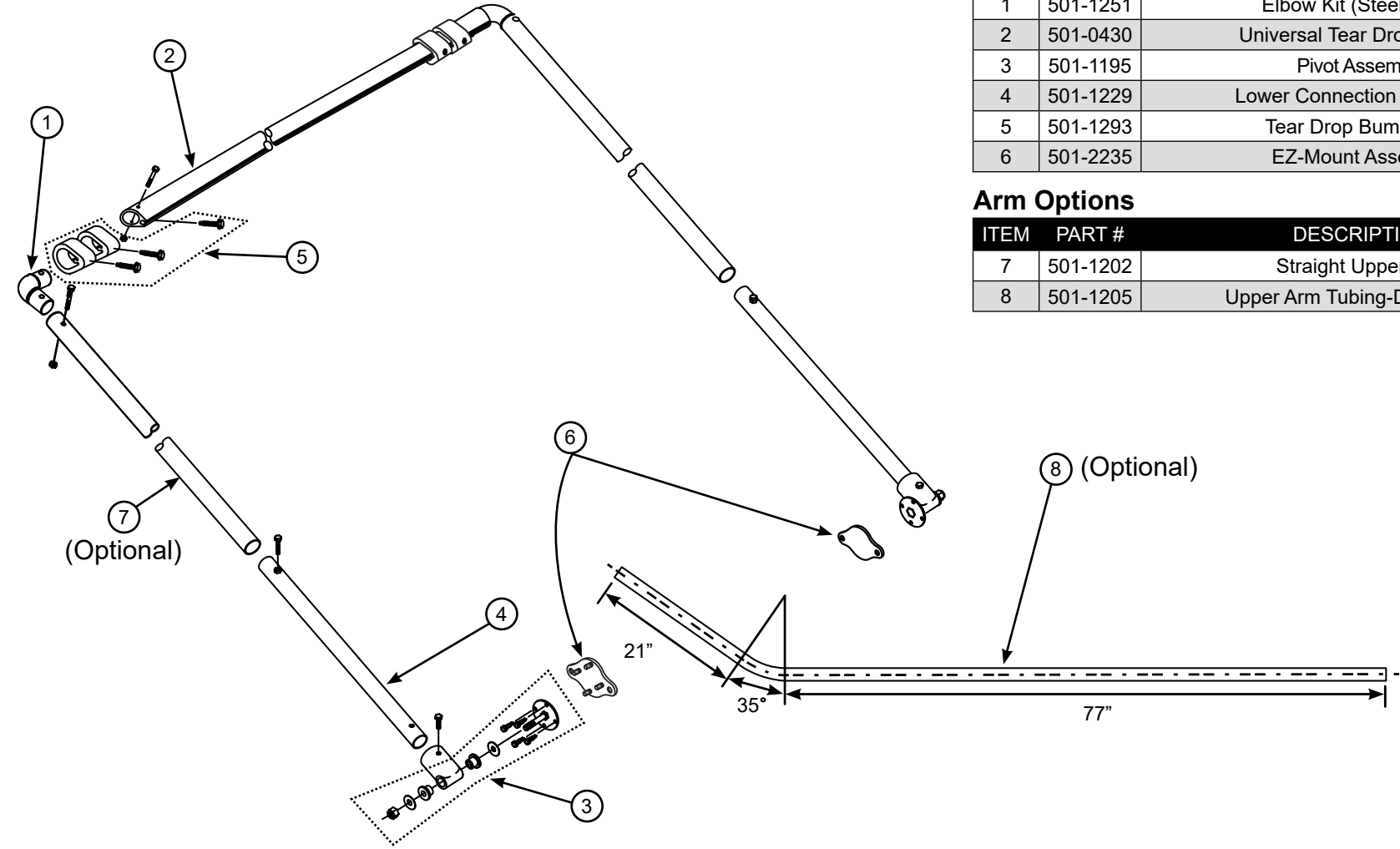



Aluminum Manual Arm Kits #113-2224, #113-2225

ITEM	PART #	DESCRIPTION	QTY
1	501-0791	Elbow Kit for Aluminum with Tear Drop	1
2	501-0430	Universal Tear Drop Pullbar	1
3	501-1195	Pivot Assembly Kit	2
4	501-1217	Aluminum Lower Arm Tube	2
5	501-1293	Tear Drop Bumper Kit	1
6	501-2235	EZ-Mount Assembly	2

Arm Options

ITEM	PART #	DESCRIPTION	QTY
7	501-1211	Aluminum Upper Arm	2
8	501-1214	Aluminum Upper Arm with Bend	2

REV. 10/21/16 WLH

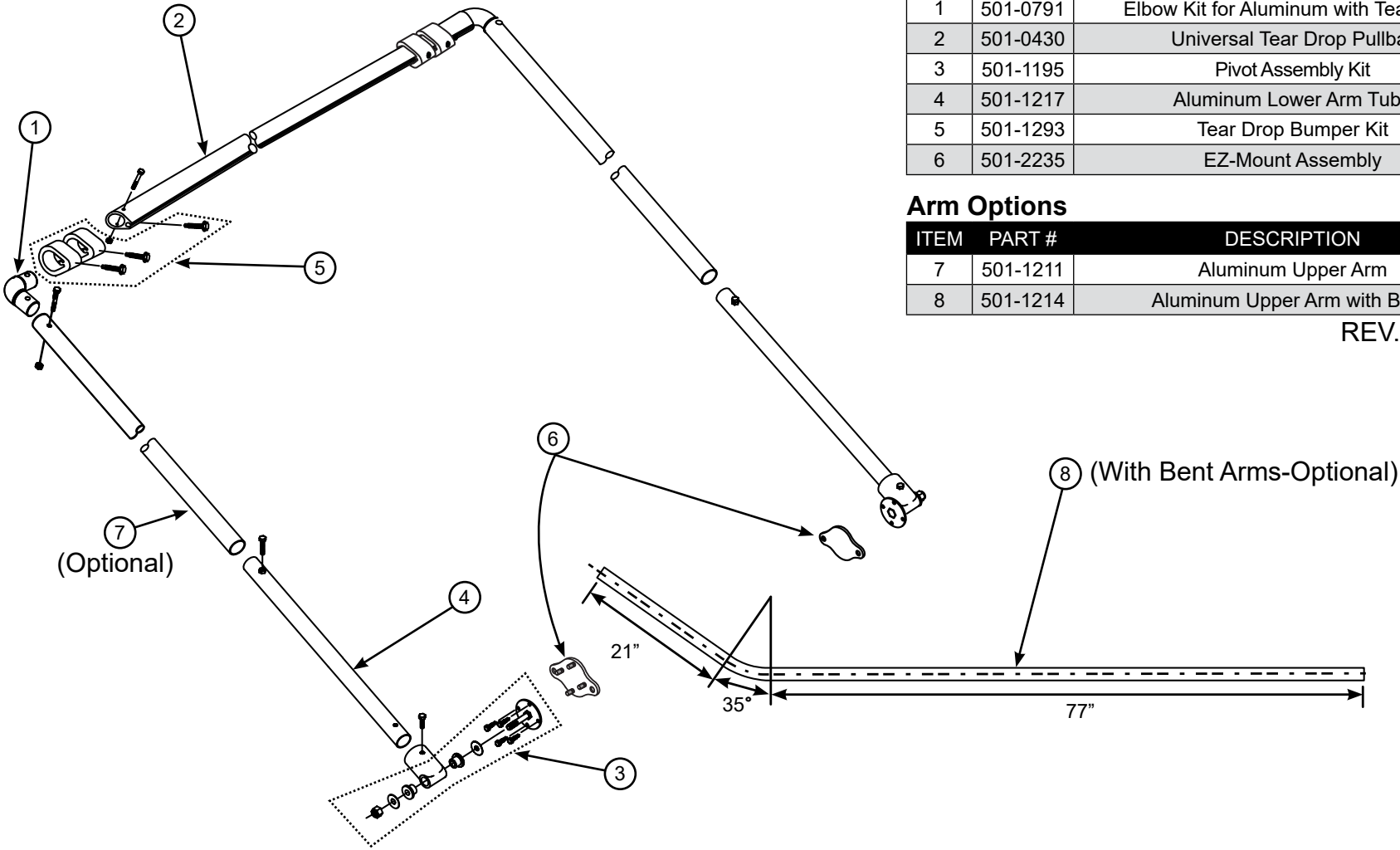



A Safe Fleet Brand



**Installation Instructions**

**Manual Arm Kits**

**Required Tools**



Spray Paint

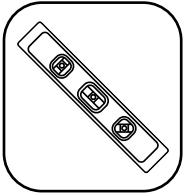

Level

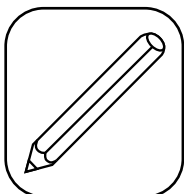

Pencil or Marker

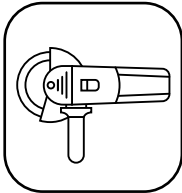

Metal Grinder

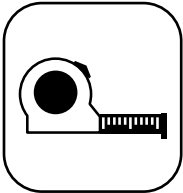

Tape Measure

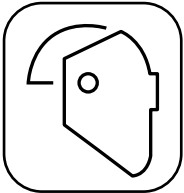

Welding Equipment & Helmet

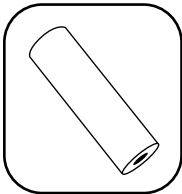

9/16" Socket

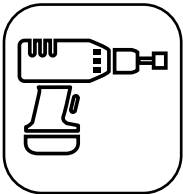

Impact Drill

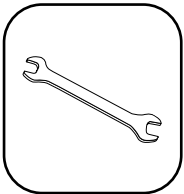

9/16" Open/Close Wrench

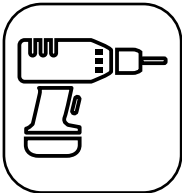

Power Drill  
(Optional)

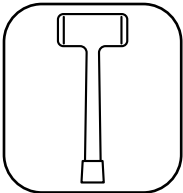

Dead Blow Hammer  
(Optional)

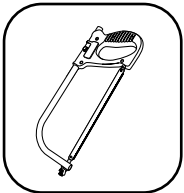

Hacksaw



A Safe Fleet Brand





A Safe Fleet Brand

Required Tools:



## Installation Instructions

## Manual Arm Kits

### Determining the Pivot Point

#### Step 1:

Measure from Point "A" to a point close to where you estimate the center to be. Record the measurement "D" and mark the box (Fig. 1).

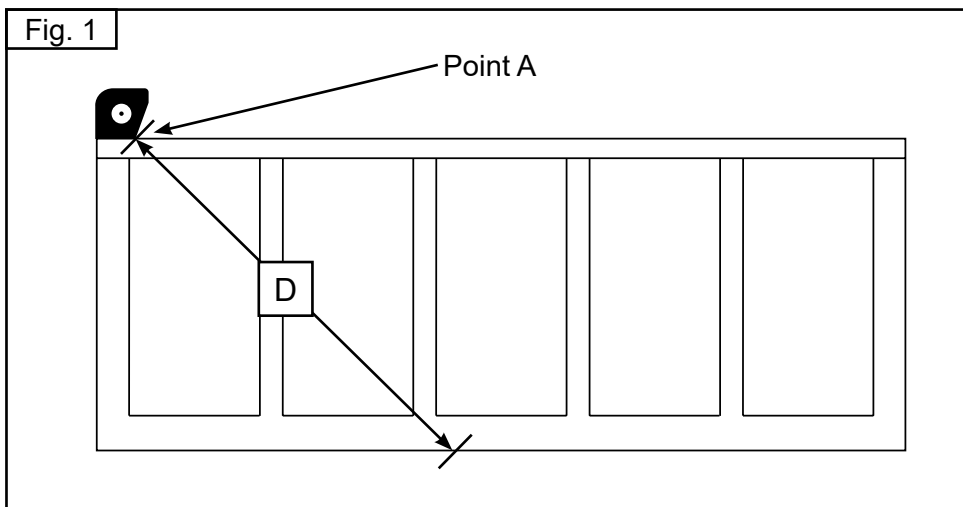

#### Step 2:

Measure from Point "B" using the same measurement from Step 1 and mark it (Fig. 2).

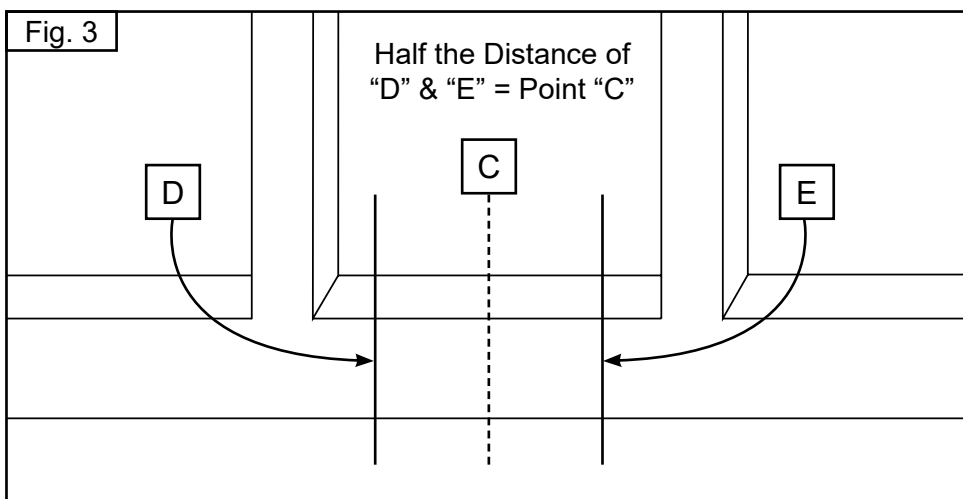
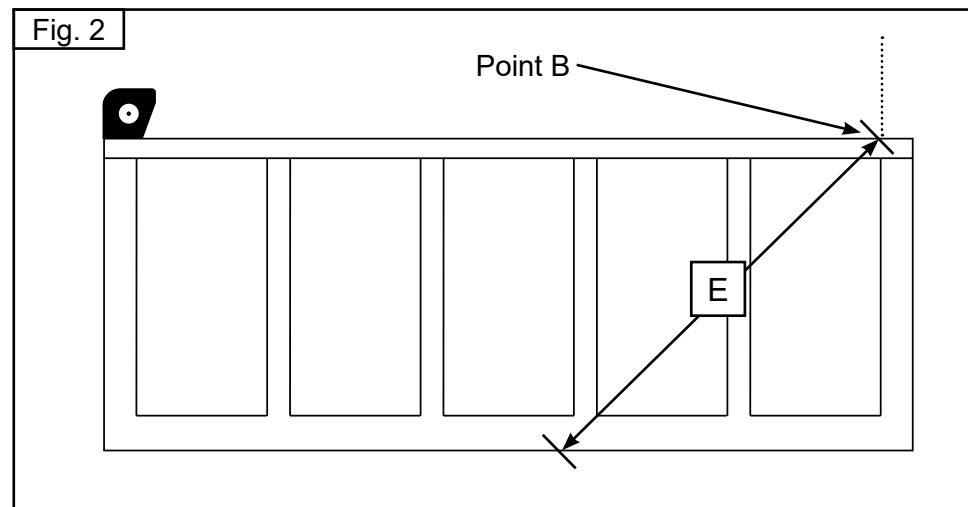

#### Step 3:

Measure from the first mark "D" to second "E" at the same height, take 1/2 of that measurement and that will determine the pivot (Point C) (Fig. 3).

Measure from the back of the box to the pivot point. Transfer this measurement to the other side of the truck to establish the pivot point.

**CAUTION:** Some applications may require the pivot to be located above the lower edge of the body.



**PRODUCT OPTION:** Offset Brackets easily offset your pivots to provide clearance for your arms to your truck or trailer.





## Installation Instructions

## Manual Arm Kits

### Determining the Pivot Point

#### Step 4:

Measure from Point "A" to Point "C" (Fig. 4). This measurement = "F". Refer to the chart (Fig. 4A) to determine if the pivot must be moved up towards the top rail. **CAUTION: If the pivot is mounted too low, the arms will become too short to cover the body.**

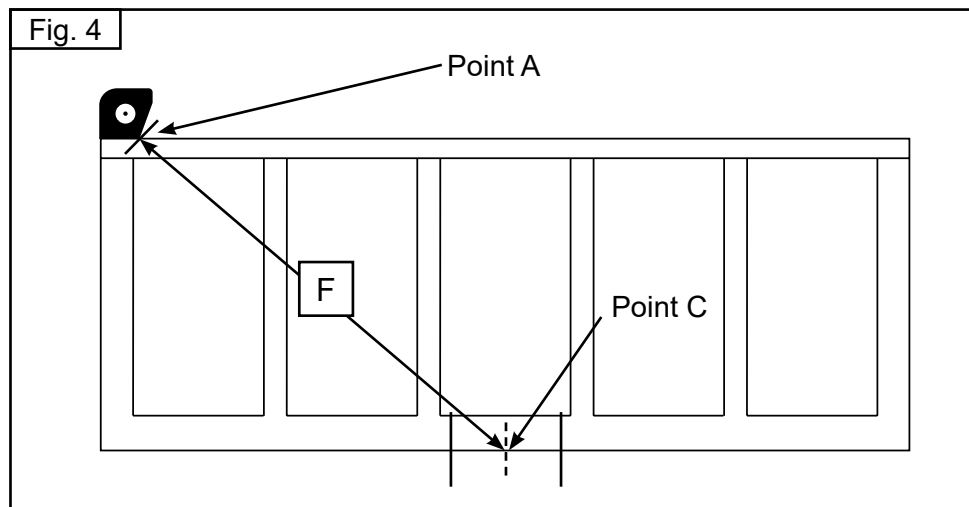
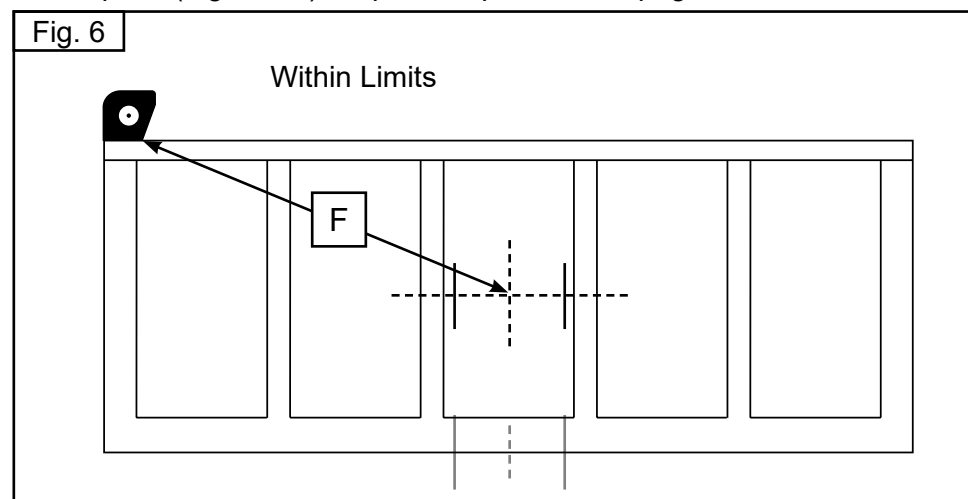
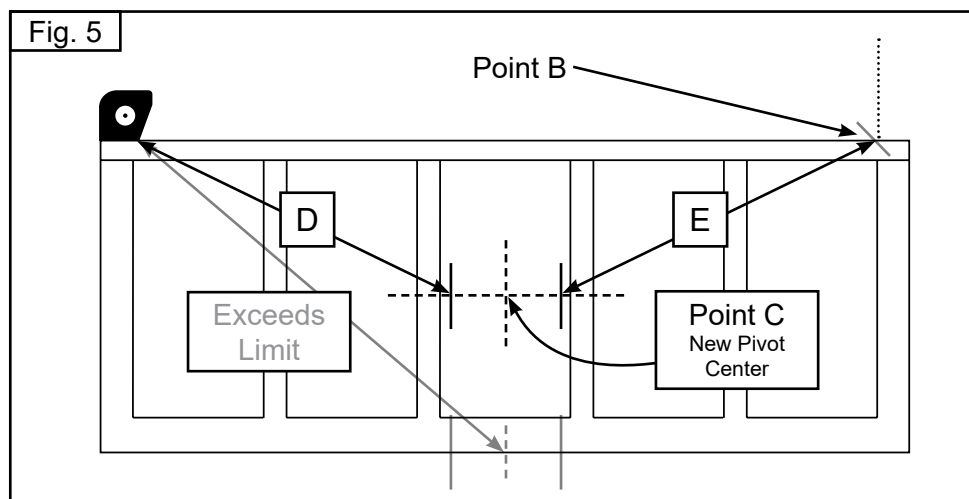
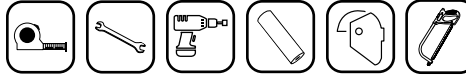

Fig. 4A

PART #	18' Tarp Application	"F" Measurement Can Not Exceed
108-0215	SuperShield 9500	<p><b>130"</b></p> <p>(Over 130" See Instructions Below)</p>
107-0215	SuperShield 8500	
106-0215	Steel Protector	
101-0215	Open 6000	
105-0215	Open 9000	
103-0215	Aluminator 7000	





## Installation Instructions

## Manual Arm Kits

### Mounting the Pivot Point & Installing the Pullbar

#### Step 6:

The pivots can either be bolted or welded in place, making sure to mount directly over point “C” and insert arm into pivots. Using the holes as a guide, drill and bolt in place (Fig. 7).

Fig. 7



#### Step 7:

Cut the pull bar to length making sure the arms remain parallel and square to the body (8A). Slide the tarp into the pull bar groove and center the tarp. (Fig. 8B).

Fig. 8A



Fig. 8B





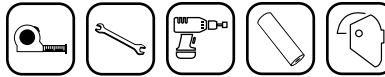

## Installation Instructions

## Manual Arm Kits

### Mounting the Pivot Point & Installing the Pullbar

#### Step 8:

Slide urethane bumpers on to the pull bar far enough to touch the edges of the tarp (Fig. 9A). Then install elbows and connect to arms (Fig. 9B). Once the elbows are in installed, lock the bumpers in place by installing a 1-1/2" long (501-9933) self drilling screw through the bumper and into the hem tube groove of the pull bar (Fig. 9C & D).

**NOTE: Tarp must be retracted when dumping!**

Fig. 9A



Fig. 9B



Fig. 9C



Fig. 9D

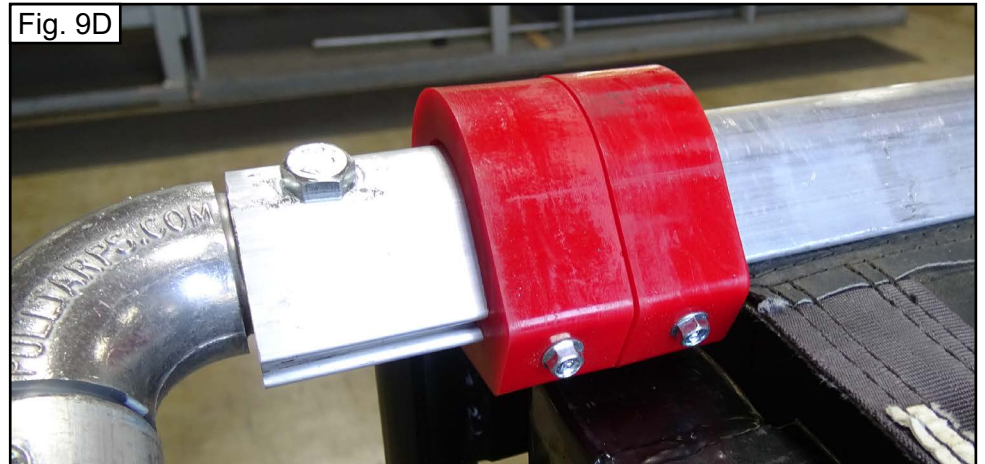

**PULLTARPS**

A Safe Fleet Brand



**Installation Instructions**

**Manual Arm Kits**

A line drawing of a dump truck with a Pulltarps system installed. The truck is shown from a side-rear perspective. A person is standing at the rear of the truck, operating the system. The text "OPERATION OF SYSTEM" is overlaid on the image in large, bold, black capital letters.

# OPERATION OF SYSTEM



## Installation Instructions

## Manual Arm Kits

### Operating the System

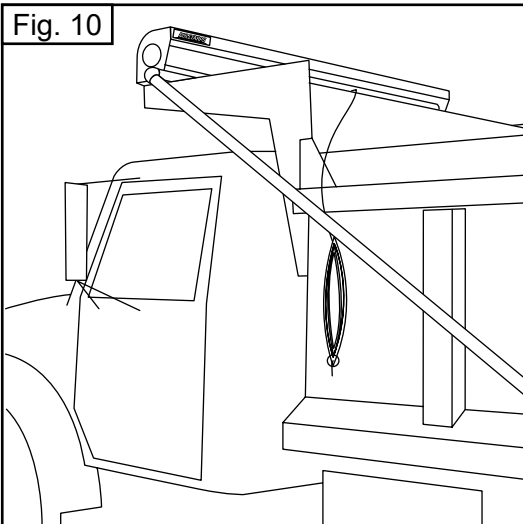

#### Step 9:

Uncoil the rope from the storage hooks and start the arms over the load with the rope or by hand (Fig. 10).

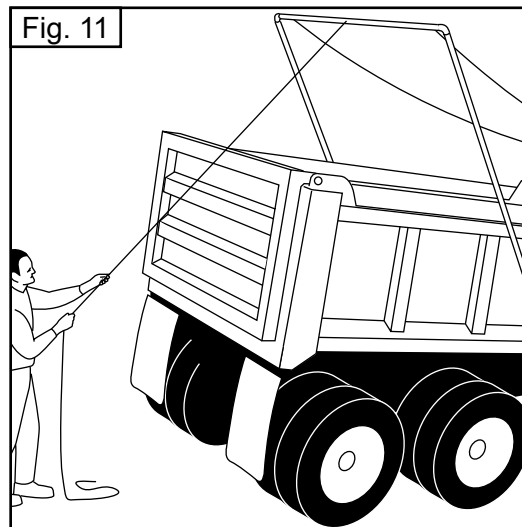

#### Step 10:

Flip the rope over the corner of the tail gate. From the center of the tailgate, pull the tarp out over the load (Fig. 11).

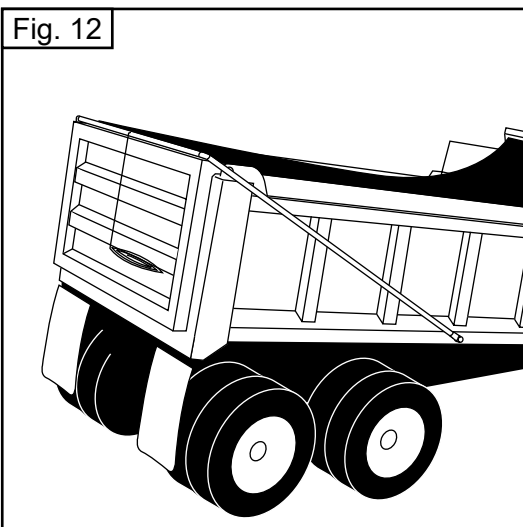

#### Step 11:

Pull the tarp to the tailgate and secure the rope on the hooks provided (Fig. 12). If tarp has side flaps secure as well.

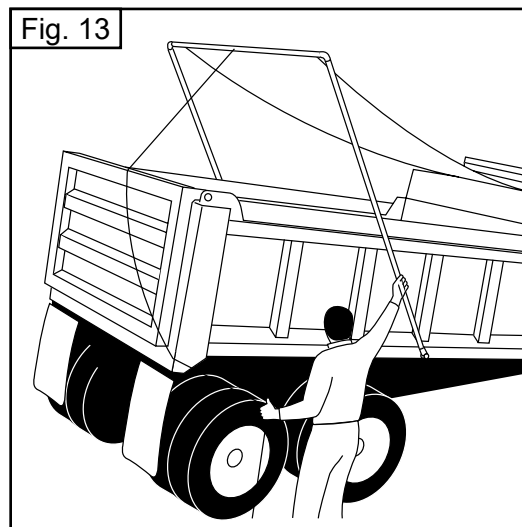

#### Step 12:

To retract, untie the rope and pull the rope around the corner of the truck body. Start the arms back by hand until the spring tension in the roller takes over to retract the tarp completely. Maintain tension on the rope to prevent the tarp from retracting too quickly. (Fig. 13).