



PULLTARPS®



INSTALLATION INSTRUCTIONS

Tarp Tamer Bow

Related Instructions,
How-To Videos & More



[PDF: ArmCatcher-Supplemental](#)



[PDF: Bolt-On Mounting System](#)



[PDF: Automatic \(Electric\) Core Systems](#)



[PDF: Optional Tarp Tamer](#)



[Video: Electric Drive Unit Operation](#)



Document #: 607-0134
Revised: 05/01/25 WLH

DURING INSTALLATION, SOME FABRICATION MAY BE REQUIRED.



Table of Contents

Tools & Parts

Recommended Tools 2

Tarp Tamer Bow to 21’ Steel #501-1800 (Straight), #501-1801 (Bent)..... 3

Tarp Tamer Bow to 21’ Aluminum #501-1802 (Straight), #501-1803 (Bent) 4

Installation

Preparation, Lower Arm Connection & Saddle Strap..... 6

Pivot Point & Bow Arm Assembly 7

Adjusting Bow Arms 8



PULLTARPS®

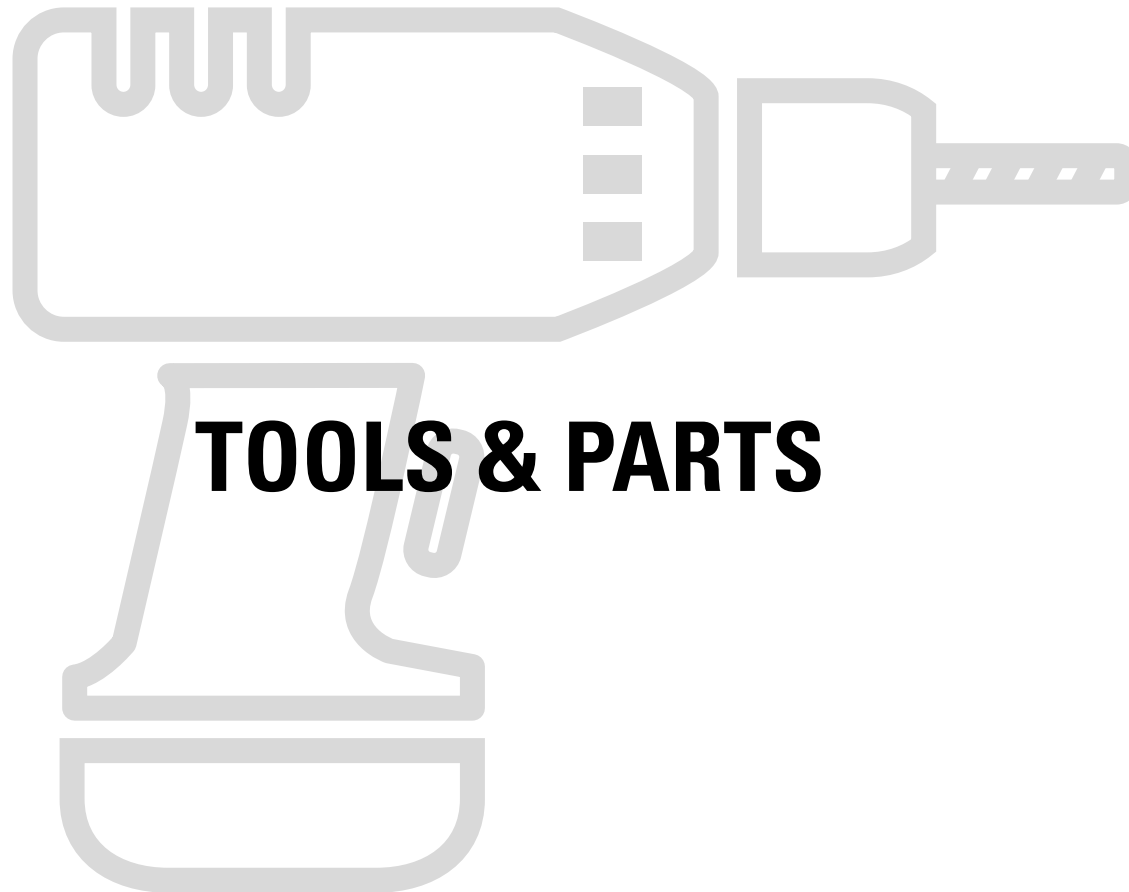

TOOLS & PARTS



INSTALLATION INSTRUCTIONS

Tarp Tamer Bow

Recommended Tools



Safety Glasses and Gloves



Welding Equipment & Helmet

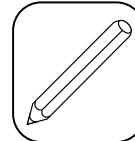

Pencil or Marker

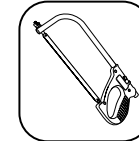

Hacksaw



Tape Measure



Socket Wrench

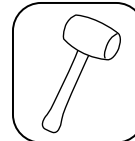

Rubber Mallet

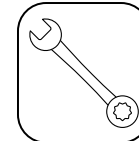

3/8" Box Wrench



Adjustable Wrench

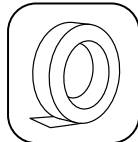

Masking Tape

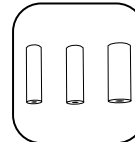

3/8" & 5/16" Sockets

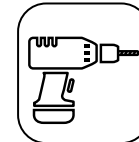

Power Drill

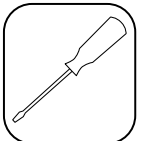

Flathead Screwdriver



INSTALLATION INSTRUCTIONS

Tarp Tamer Bow

Tarp Tamer Bow to 21' Steel #501-1800 (Straight), #501-1801 (Bent)

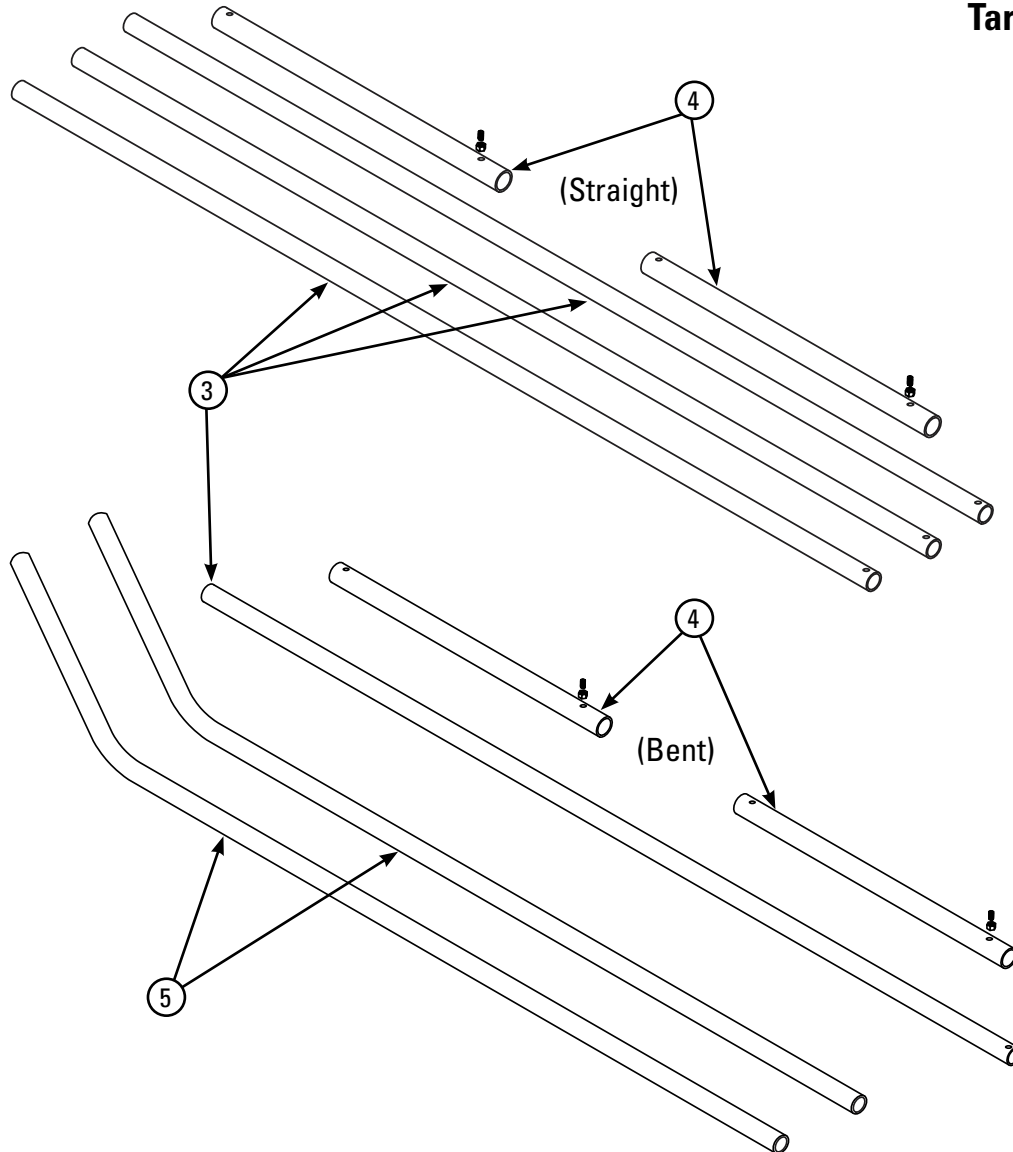

Straight & Bent

ITEM	PART #	DESCRIPTION	QTY
1	501-0796	Tarp Tamer Bow Hardware Kit (Straight)	1
--	--	Tarp Tamer Bow Hardware Kit (Bent)	1
2	501-1251	Elbow & Upper Conn. Hardware (Straight) - Steel	1
--	--	Elbow & Upper Conn. Hardware (Bent) - Steel	1
3	501-1202	Steel Upper Arm Tubing (Straight) - Drilled	3
--	--	Steel Upper Arm Tubing (Bent) - Drilled	1
4	501-1229	Lower Connection Arm Tube (Straight) - 34.25"	2
--	--	Lower Connection Arm Tube (Bent) - 34.25"	2
5	501-1205	Upper Arm Tubing (Bent) - Drilled	2

REV. 12/19/16 WLH

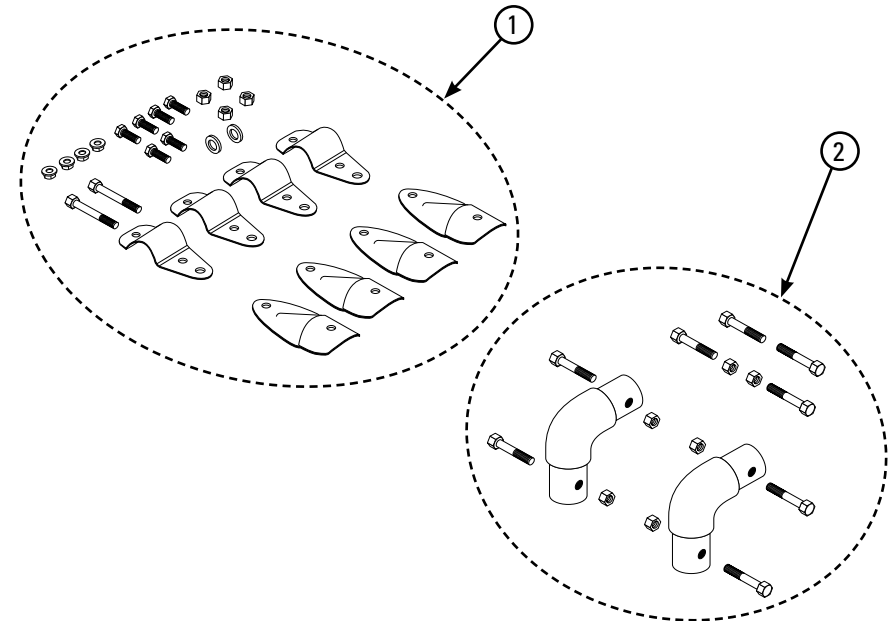



INSTALLATION INSTRUCTIONS

Tarp Tamer Bow

Tarp Tamer Bow to 21' Aluminum #501-1802 (Straight), #501-1803 (Bent)

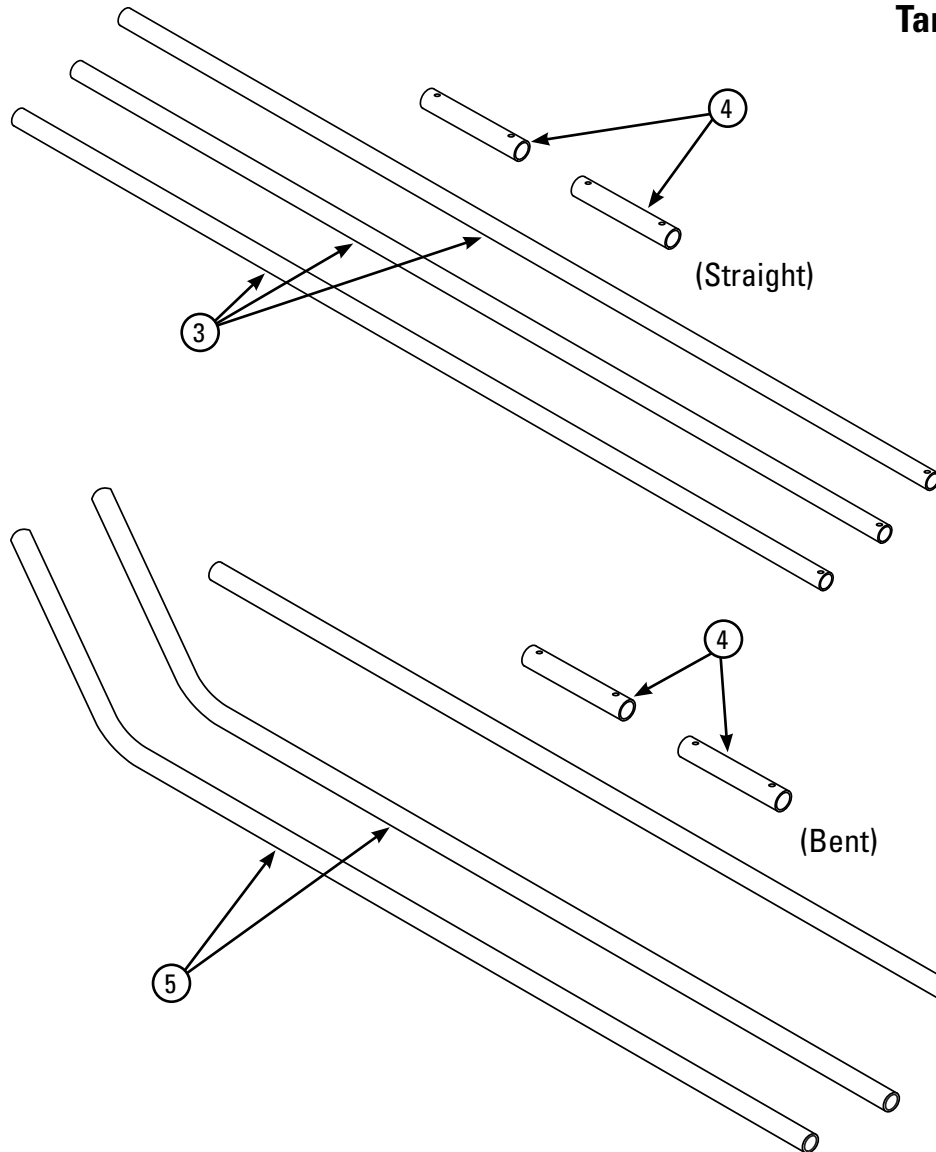

Straight & Bent

ITEM	PART #	DESCRIPTION	QTY
1	501-0796	Tarp Tamer Bow Hardware Kit (Straight)	1
--	--	Tarp Tamer Bow Hardware Kit (Bent)	1
2	501-1250	Elbow & Upper Conn. Hardware (Straight) - Alum	1
--	--	Elbow & Upper Conn. Hardware (Bent) - Alum	1
3	501-1211	Aluminum Upper Arm or Pullrod (Straight)	3
--	--	Aluminum Upper Arm or Pullrod (Bent)	1
4	501-1217	Aluminum 4 Spring Arm Tube 30" Long (Straight)	2
--	--	Aluminum 4 Spring Arm Tube 30" Long (Bent)	2
5	501-1214	Aluminum Upper Arm (Bent) - Up to 33'	2

REV. 12/19/16 WLH

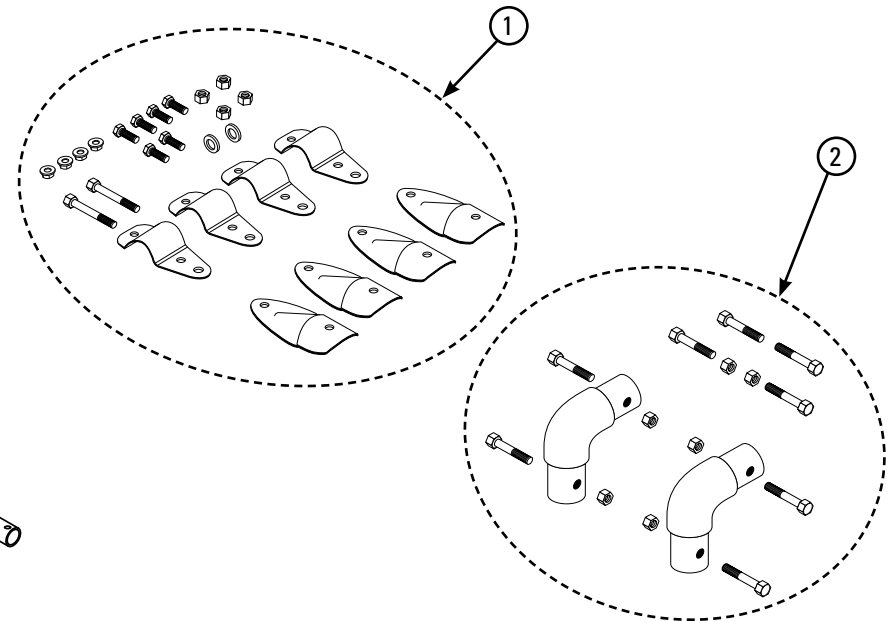



PULLTARPS®



INSTALLATION INSTRUCTIONS

Tarp Tamer Bow



INSTALLATION



PULLTARPS®



INSTALLATION INSTRUCTIONS

Tarp Tamer Bow

Preparation, Lower Arm Connection & Saddle Strap

Step 1: Fully extend the tarp to the tailgate (Fig. 1).

Fig. 1

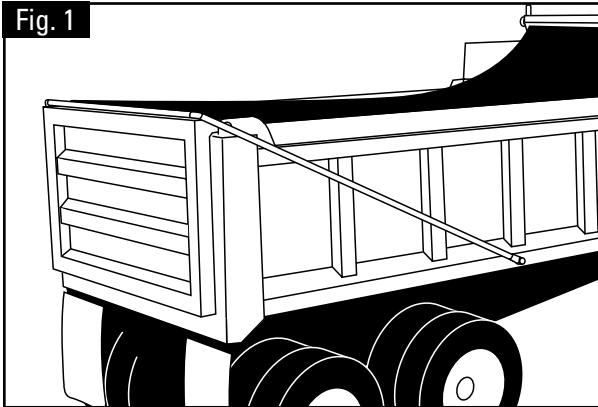

Fig. 2



Step 2 - Assemble Lower Arm Connection:

Place Connection Brackets (501-0542) on each side of the Lower Connection Arm Tube (501-1229) and bolt in place using the 3/8 - 16 x 2 3/4 bolts (503-3711) and 3/8 - 16 lock nuts (504-3702). Tighten bolts just enough to hold the parts in place. Final tightening will take place later (Fig. 2).

Fig. 3



Step 3 - Assemble Saddle Strap:

Assemble Saddle Strap (501-0543) as shown with one 5/16 - 18 x 1 bolt (503-3105), 1/4 x 3/4 Spacer (523-0225) and 5/16 - 18 lock nut (504-3103). Do not tighten the bolt at this time. (Fig. 3).

Fig. 4



Step 4 - Install the Saddle Strap Assembly:

Install the Saddle Strap Assembly over the existing lower arm. Insert the 5/16 - 18 x 1 (503-3105) lower bolt and 5/16-18 lock nut (504-3103) as shown. Move the assembly along the lower arm tube to a point near the middle of the box. Tighten both bolts until just snug to hold the assembly in place. Repeat process on other side of the body. (Fig. 3).

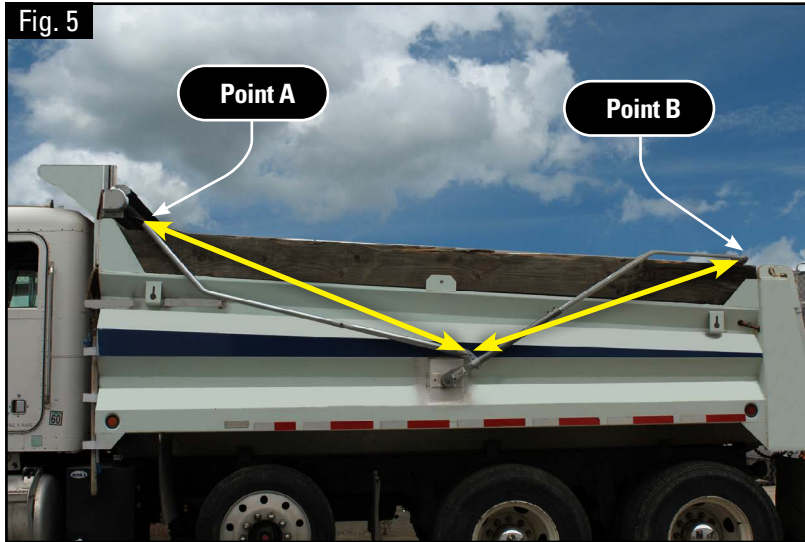

Pivot Point & Bow Arm Assembly

Fig. 5

Step 5 - Locating the pivot point for the Tarp Tamer Bow:

Adjust the position of the Saddle Strap Assembly up or down the lower arm until the hole in the assembly is even with the middle of the box. See illustration. Measure and mark a location 3" behind the cab shield. This will be point "A" where the Tarp Tamer Bow will rest when the tarp is covering the opening. Measure from the arm mounting hole in the Saddle Strap Assembly to point "A" and then to point "B". Adjust the location of the location of the Saddle Strap Assembly until the hole is the same distance from both points. Repeat process on other side of the body (Fig. 5).

Fig. 6

Step 6 - Installing the Bow Arm Assembly:

Attach the Lower Connection Arm Tube Assembly to the Saddle Strap Assembly using the 3/8 -16 x 1 bolts (503-3704) and 3/8 locking nut (504-3702). Tighten Arm Tube Bolts from step 1 at this time. Insert the elbow into the upper arm tube and secure with a 3/8 - 16 x 2 1/4 bolt (503-3710) and 3/8 locking nut (504-3702). Slide the upper arm into the Lower Connection Arm Tube and position it so that the elbow is aligned at point "A". Tighten the set screw on the Lower Connection Arm Tube to hold the upper arm in place. The end of the arm opposite the elbow can be cut to length if the arm is too long. Repeat process on other side of the body (Fig. 6).

Measure the width of the pullbar at the rear of the body where the tarp is attached. Cut the cross bar (501-1202) for the Tarp Tamer Bow to the same length. Note: one end of the cross bar is already drilled for the elbows. Match drill the other end of the cross bar for the other elbow. Attach the cross bar to the upper arms/elbows using the 3/8 - 16 x 2 3/4 bolts (503-3711) and 3/8 locking nuts (504-3702).



PULLTARPS®



INSTALLATION INSTRUCTIONS

Tarp Tamer Bow

Adjusting Bow Arms

Step 7:

Cycle the tarp system to retract the arms to the front of the box where they will rest. The Tarp Tamer Bow should be resting just in front of the pullbar to prevent binding when the tarp is retracted (Fig. 7A, B & C). Adjust the Saddle Strap Assembly location on the lower arms or the upper arm lengths for the tarp as necessary so that the arms park in the proper location.

Cycle the system several times checking for binding or rubbing and adjust as necessary.

Fig. 7A



Fig. 7B



Fig. 7C

