

• DETAILS OF MANUAL ARMS •

• DETAILS MAKE THE DIFFERENCE •

Full Line of Tarp Housings



End Caps

The fiberglass reinforced nylon end caps provide friction free operation even in subzero temperatures. Lasts longer than bearings because they're not affected by salt, moisture or grit.

Part # 517-0102

Galvanized Roller Tube

Easily remove or install any tarp. Tarp slides in and out of the groove on the roller tube.

Part # 501-13XX

Mounting Plate

Steel Mounting Plate is bolted to aluminum bodies and can be welded or bolted to steel bodies.

Part # 501-1124

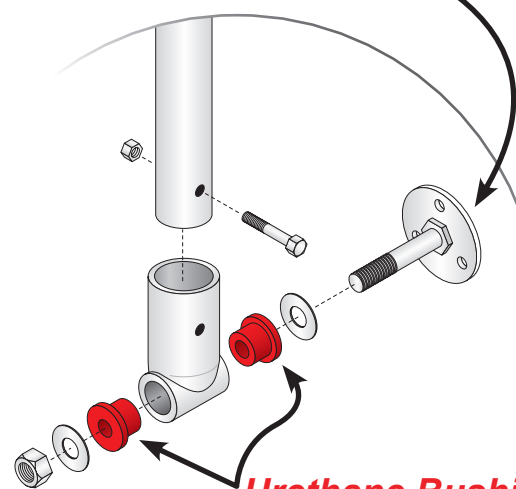

Urethane Bushings

Provide smooth operation, absorb shock and are not affected by salt, moisture, or grit.

Part # 501-1146

Spring

The Spring is plated to resist corrosion and has a lifetime guarantee.

Grommets

Come standard on all tarps.

Side Flaps

Vinyl Side Flaps are available for all tarps. See page 47.

Standard Arm Tubing

Arms made of common fence pipe or aluminum tubing. Allows for inexpensive repairs in the field.

Part # 501-12XX

Teardrop Pullbar

Tarp slides in groove and wraps around our pullbar design.

Part # 501-0430

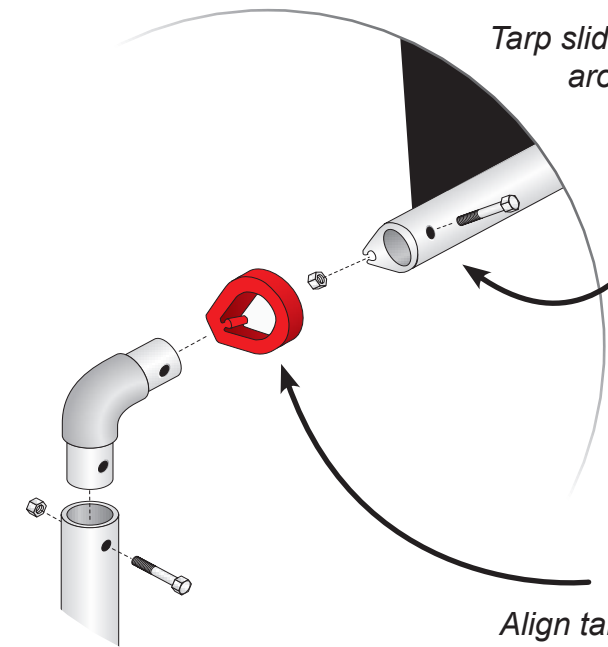

Urethane Bumpers

Align tarp and protect the body.

Part # 517-0116

Braided Loop

Goes through the webbing loop to prevent hanging up when pulling over the tailgate.

Part # 501-10XX

Rope Storage Hooks

Provided for front and rear rope storage. Zinc plated steel or aluminum.

Part # 501-014X

Bungee Cord

The orange and black polypropylene truckers' rope has a bungee cord with a ring attached so it doesn't need to be tied off.

Part # 501-10XX