



INSTALLATION INSTRUCTIONS

Steel Four (4) Spring Arm Adjustable System

501-1755, 501-1756

Related Instructions,
How-To Videos & More



[PDF: Optional Tarp Tamer](#)



[PDF: Bolt-On Mounting System](#)



[PDF: Deluxe High Amp Switch - 12V](#)



[PDF: Cab External Switch - 12V](#)



[PDF: 12V Smart Switch w/ External Switch](#)

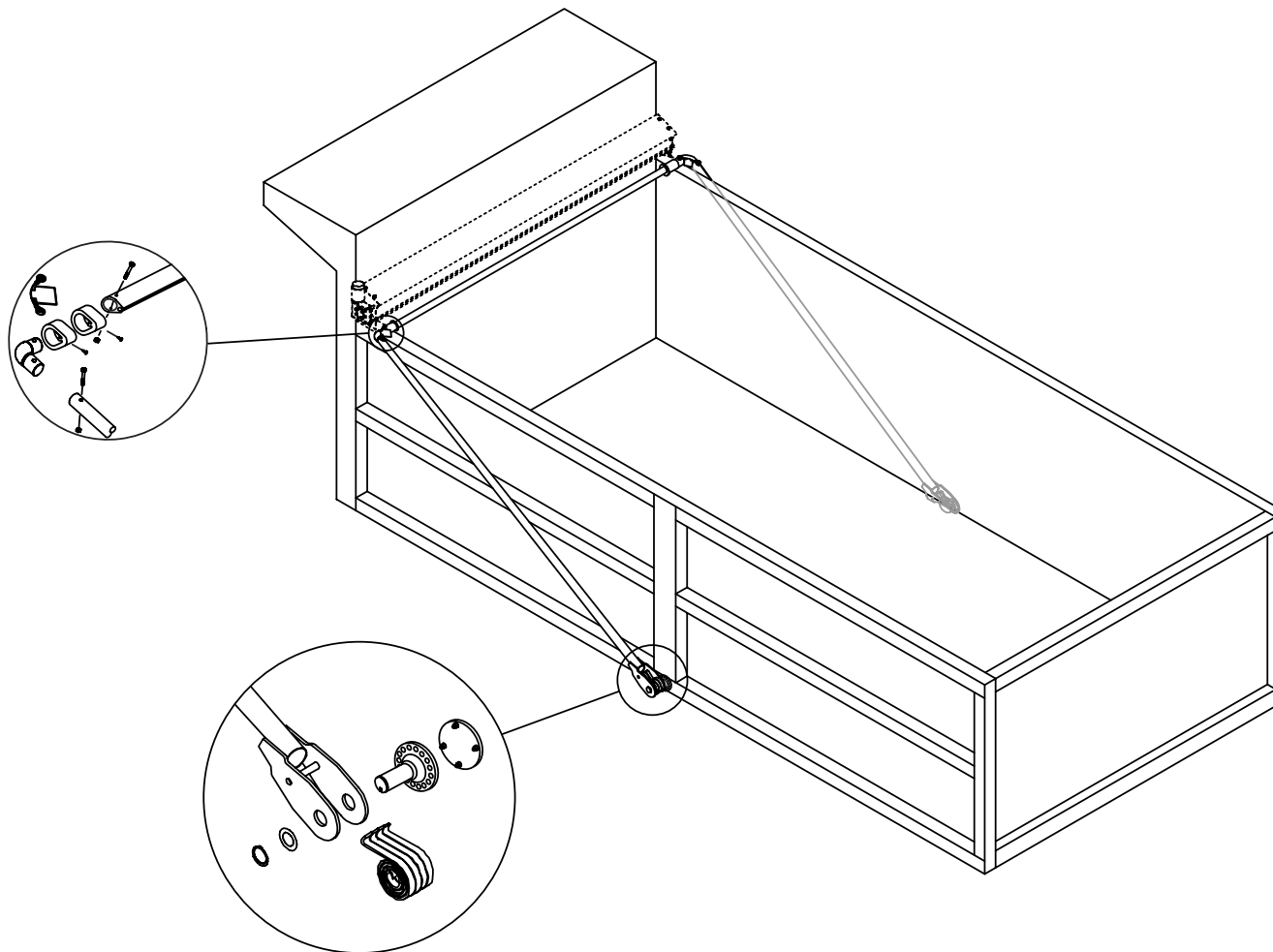

Document #: 607-0141
Revised: 10/08/25 WLH

DURING INSTALLATION, SOME FABRICATION MAY BE REQUIRED.



A Roll-Rite Brand



Table of Contents

Tools & Parts

Recommended Tools 2

Steel Arms to 22' #501-1756, 501-1755..... 3

4 Spring Housing Assembly #501-2207 (Driver-Opposite), 501-2208 (Pass.-Shown). . 4

Installation

Pivot Points and Mounting Locations 6

Arm Alignment, Tarp and Pullbar Installation..... 7

Quick Disconnect Plug Assembly 8

Flap Tarp, Rope & Hook Installation

Optional Flap Tarp, Rope and Hook Installation 10

Bungree Cord Installation 11

Flap, Rope and Rope Hook Placement 12





A Roll-Rite Brand



INSTALLATION INSTRUCTIONS

Steel Four (4) Spring Arm Adjustable System

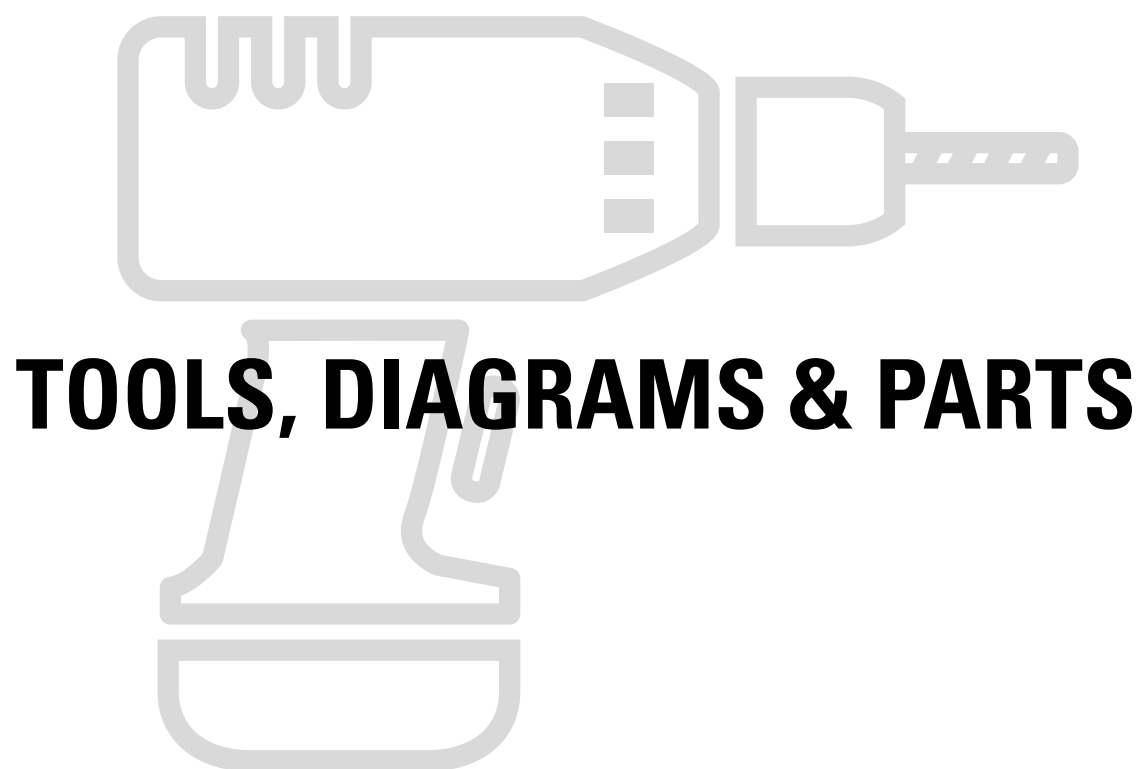



A Roll-Rite Brand



INSTALLATION INSTRUCTIONS

Steel Four (4) Spring Arm Adjustable System

Recommended Tools



Safety Glasses and Gloves

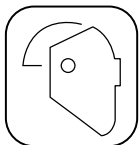

Welding Equipment & Helmet

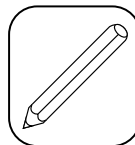

Pencil or Marker



Metal File



Hacksaw



Tape Measure



Rubber Mallet

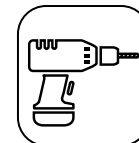

Impact Drill (Optional)



Adjustable Wrench

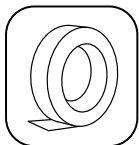

Masking Tape

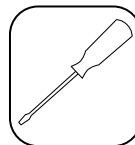

Flathead Screwdriver



INSTALLATION INSTRUCTIONS

Steel Four (4) Spring Arm Adjustable System

Steel Arms to 22' #501-1756, 501-1755

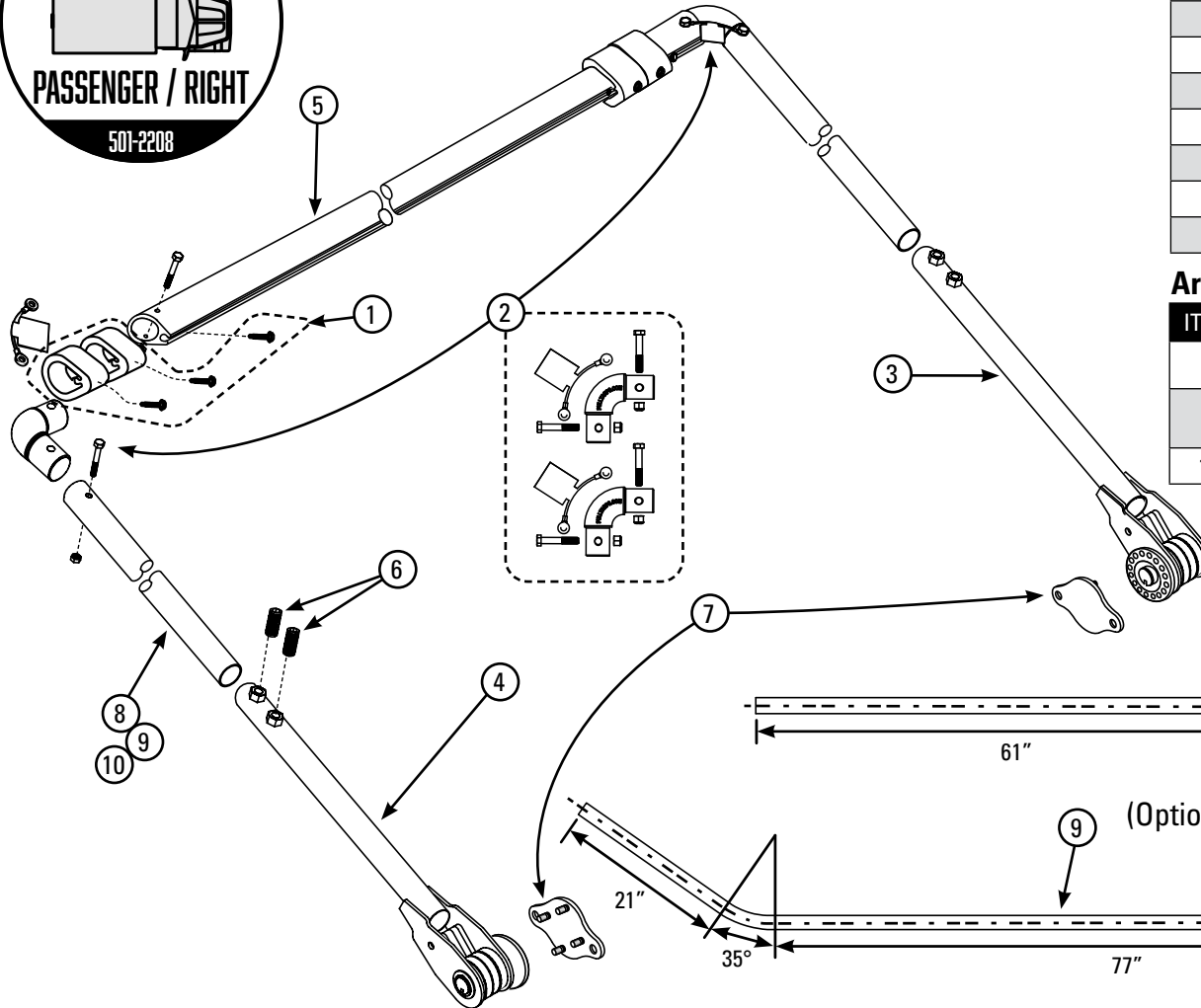

ITEM	PART #	DESCRIPTION	QTY
1	501-1293	Teardrop Bumper Kit	1
2	501-1251	Elbow Kit (For Steel)	1
3	501-2207	4 Spring Housing (Driver Side)	1
4	501-2208	4 Spring Housing (Pass. Side)	1
5	501-0430	Universal Teardrop Pullrod	1
6	506-5008	1/2" - 13 x 3/4"lg. Set Screw	4
7	501-2235	EZ-Mount Assembly	1
--	514-0120	6 Ga. Electric Wire	60'

Arm Options

ITEM	PART #	DESCRIPTION	QTY
8	501-1202	Steel Upper Arm Tubing (Included in 501-0782)	2
9	501-1205	Upper Arm Tubing, Drilled and Bent (Included in 501-0749)	2
10	501-1207	Offset Upper Arm Tube	2

REV. 09/05/25 WLH

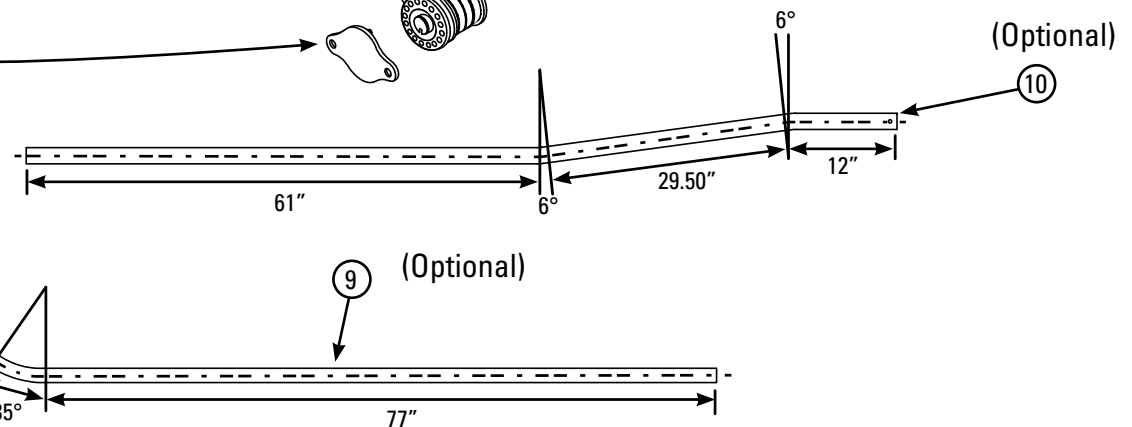



INSTALLATION INSTRUCTIONS

Steel Four (4) Spring Arm Adjustable System

4 Spring Housing Assembly #501-2207 (Driver-Opposite), 501-2208 (Pass.-Shown)

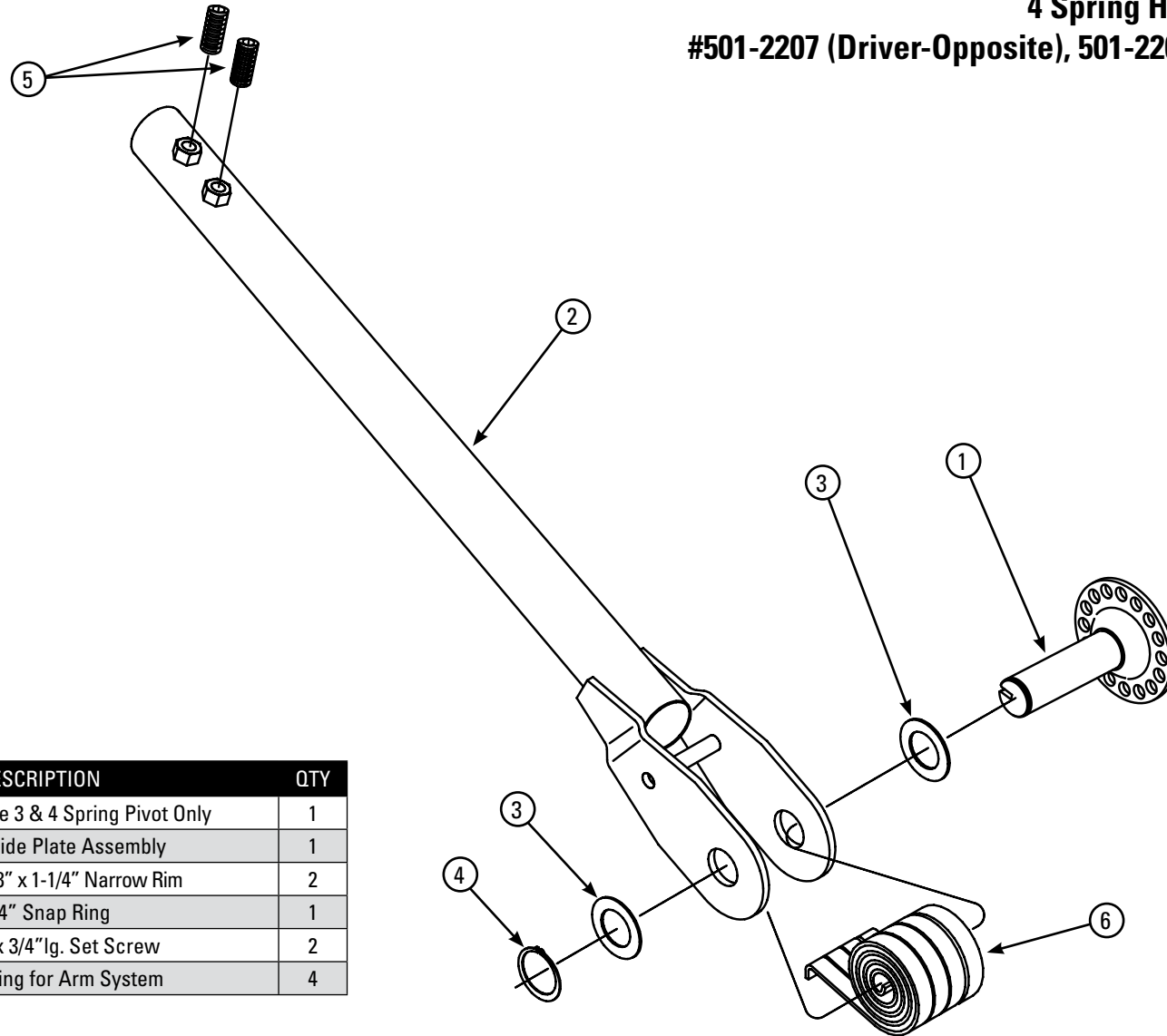

ITEM	PART #	DESCRIPTION	QTY
1	501-2243	Steel Adjustable 3 & 4 Spring Pivot Only	1
2	501-1110	4 Spring Side Plate Assembly	1
3	501-1162	Washer, 1 7/8" x 1-1/4" Narrow Rim	2
4	506-0101	1 1/4" Snap Ring	1
5	506-5008	1/2" - 13 x 3/4"lg. Set Screw	2
6	517-9921	Small Spring for Arm System	4

REV. 05/07/25 WLH



A Roll-Rite Brand



INSTALLATION INSTRUCTIONS

Steel Four (4) Spring Arm Adjustable System

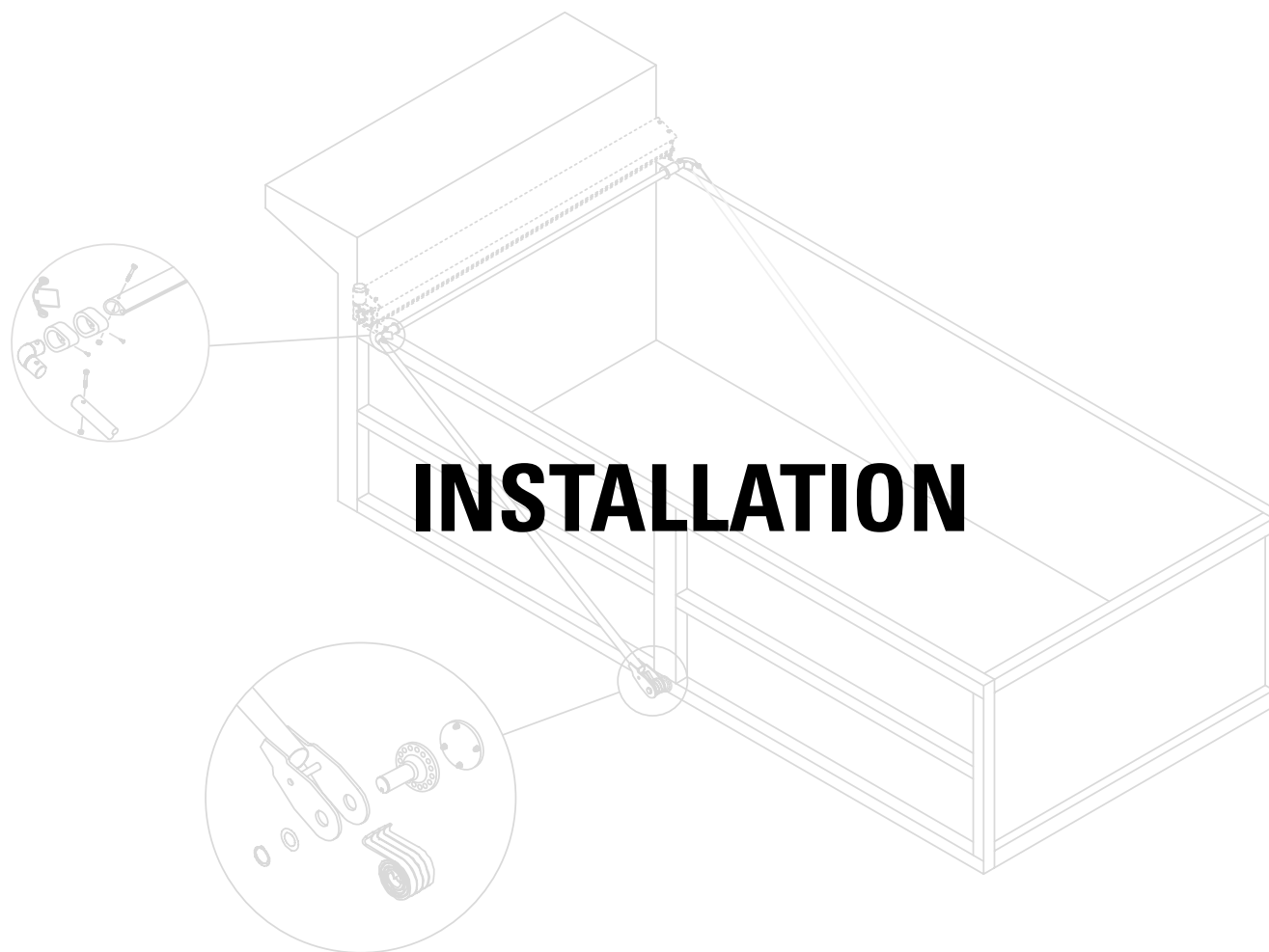



INSTALLATION INSTRUCTIONS

Steel Four (4) Spring Arm Adjustable System

Pivot Points and Mounting Locations

Step 1: Determining the Pivot Points and Mounting Locations on each side, careful measurement must be taken to insure that the arm and pivot assemblies are mounted square and parallel to the truck or trailer body. Locate the proper mounting positions by determining Point "A" and Point "B" and insuring measurement "D" and "E" are equal (Fig. 1). Point "C" must be located as low as possible and be the same on both sides.

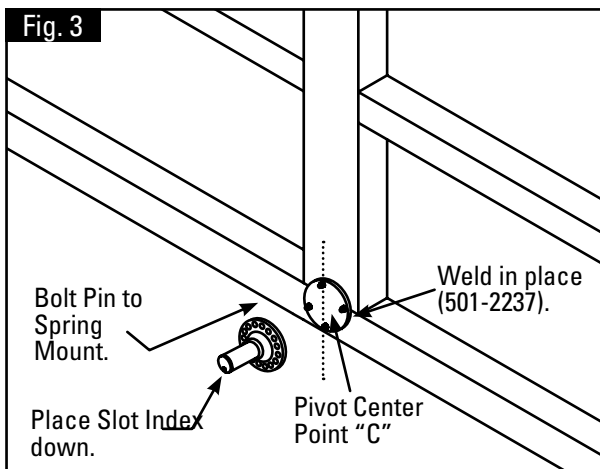
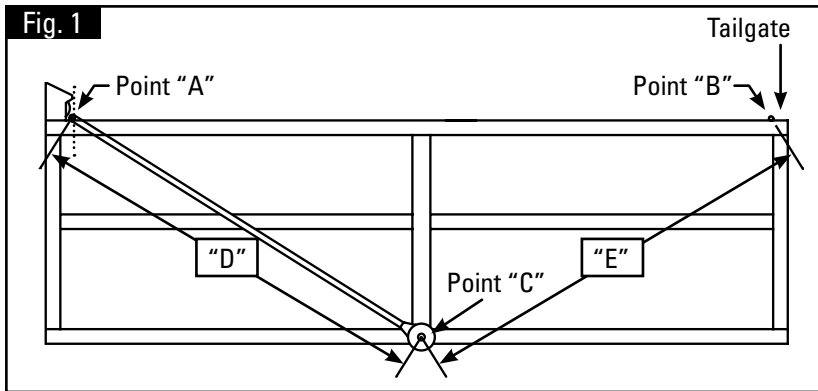

Step 3 - Mounting the Pivot: Locate the Pivot pin with marks made in Step 2. Weld the Spring Mounting in place and then bolt on the Steel Adjustment Pin with the Slot Index down (Fig. 3).

Step 2 - Arm Preload: Install Arm and Pivot assemblies with Arm indexed (Fig. 2). Arms must be indexed with no spring load on pivots. Index Arm at 180 degrees of travel from the Roller Mechanism for proper preload of the spring. The dotted lines represent proper 180 degree preload position for applications with Bent Arms. Mark pivot pin location on box.

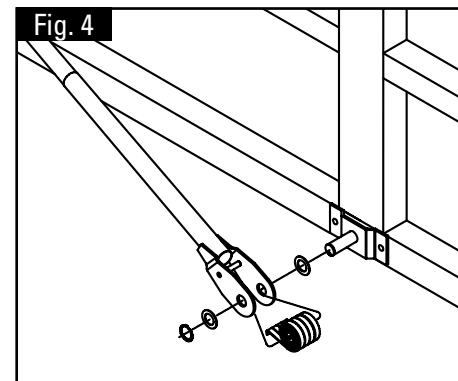
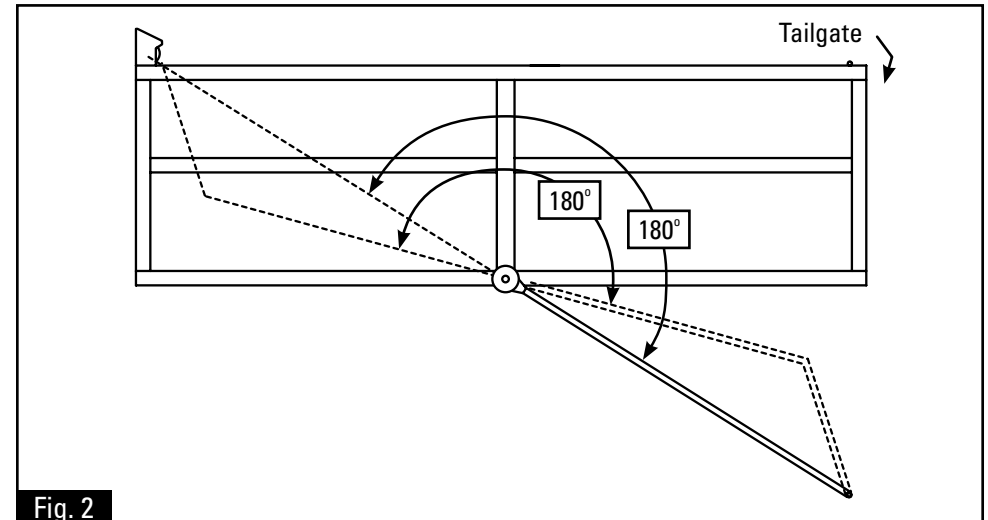

Step 4 - Pivot & Spring Assembly: Assemble the springs and pivot assembly (Fig. 4).

Make sure assembly moves freely.



INSTALLATION INSTRUCTIONS

Steel Four (4) Spring Arm Adjustable System

Arm Alignment, Tarp and Pullbar Installation

Fig. 5

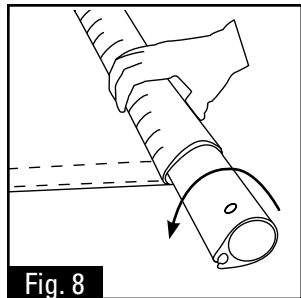
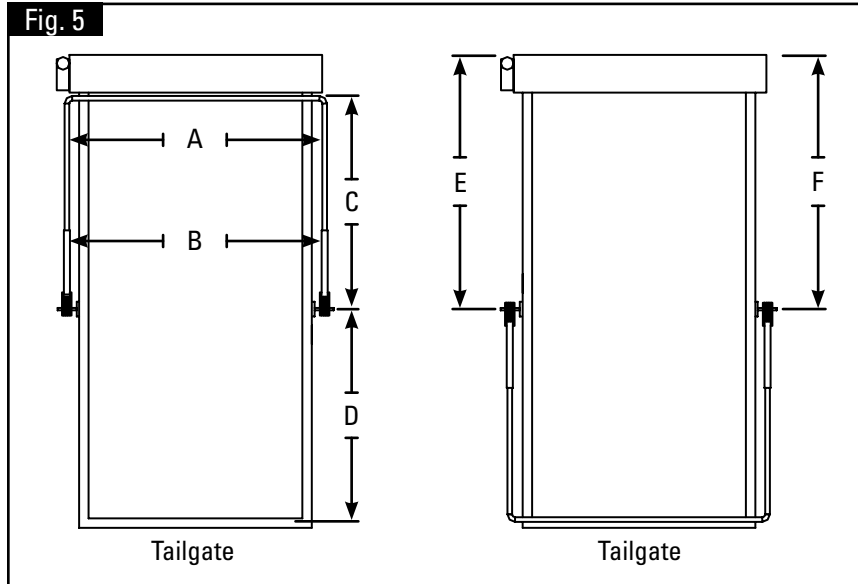

Step 8 - Installing The Pullbar:
Cut the pullbar to length making sure the arms remain parallel and square to the body.

Slide the tarp into groove in the pullbar and center the tarp.

Roll the tarp up on the pullbar two revolutions (Fig. 8).

Note: Tarp must be retracted when dumping.

Step 5 - Correct Alignment of arm to truck:

Arms and pivots must be square and parallel to truck (Fig. 5).

(Dimension "A" must equal "B" - Dimension "C" must equal "D" - Dimension "E" must equal "F")

Fig. 6

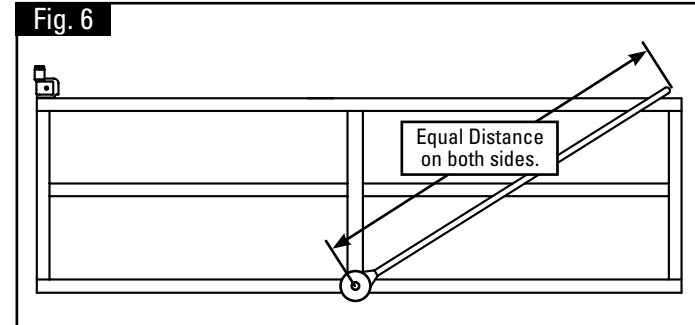

Step 6: Adjust the Arms on both sides to be the same length (Fig. 6).

Fig. 7

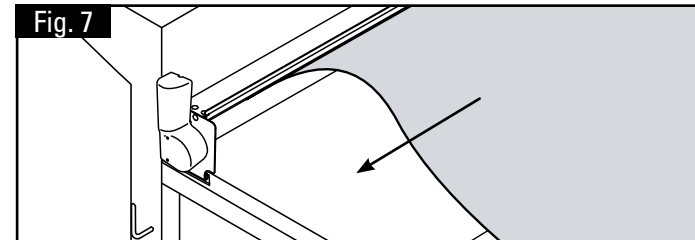

Step 7 - Tarp Installation:
Slide Tarp into Groove on roller tube and center (Fig. 7).

Fig. 9

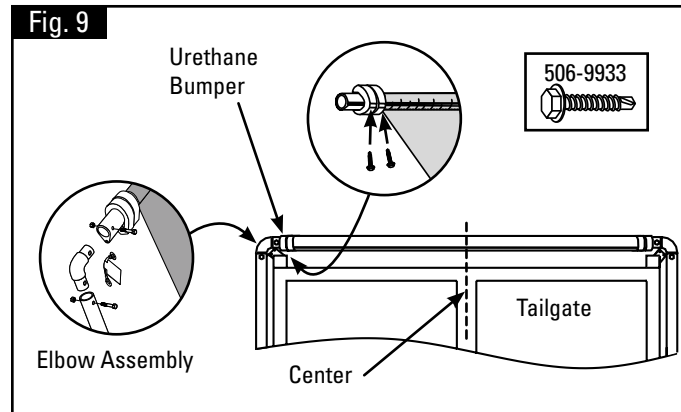

Step 9: Fasten the tarp in place by sliding the two urethane bumpers on to the pullbar far enough to touch the edges of the tarp. Lock in place by installing a 1-1/2" long (506-9933) self drilling screw through the bumper and into the hem tube groove of the pullbar (Fig. 9).

For elbows, use the long bolts provided in the kit, when deployed to catch the rope on flap tarps.



INSTALLATION INSTRUCTIONS

Steel Four (4) Spring Arm Adjustable System

Quick Disconnect Plug Assembly

Step 10: Assemble the Quick Disconnect (Fig. 10, 11 & 12).

Option #1, Plug Assembly - Part # 514-0505.

Fig. 10

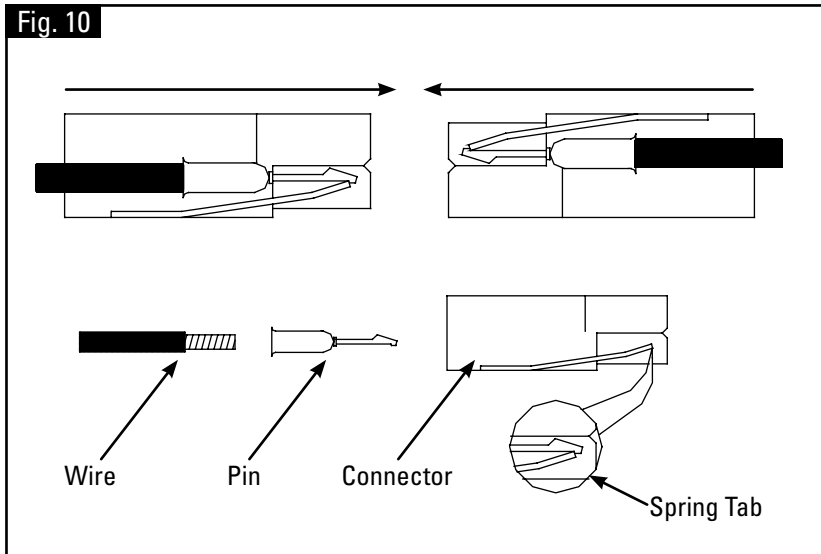
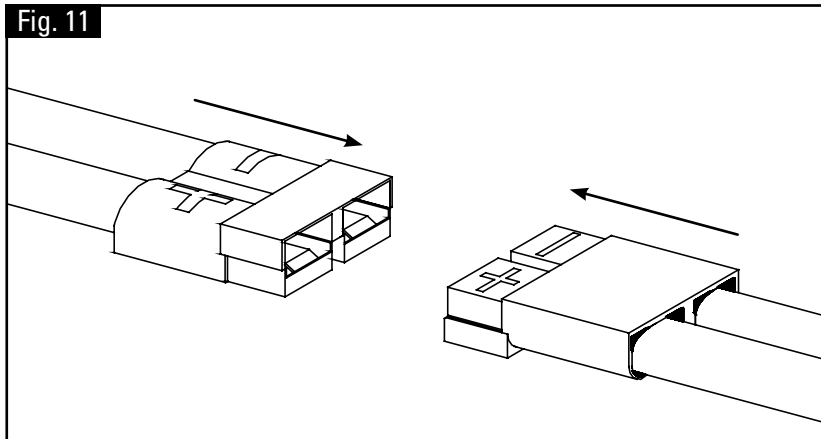
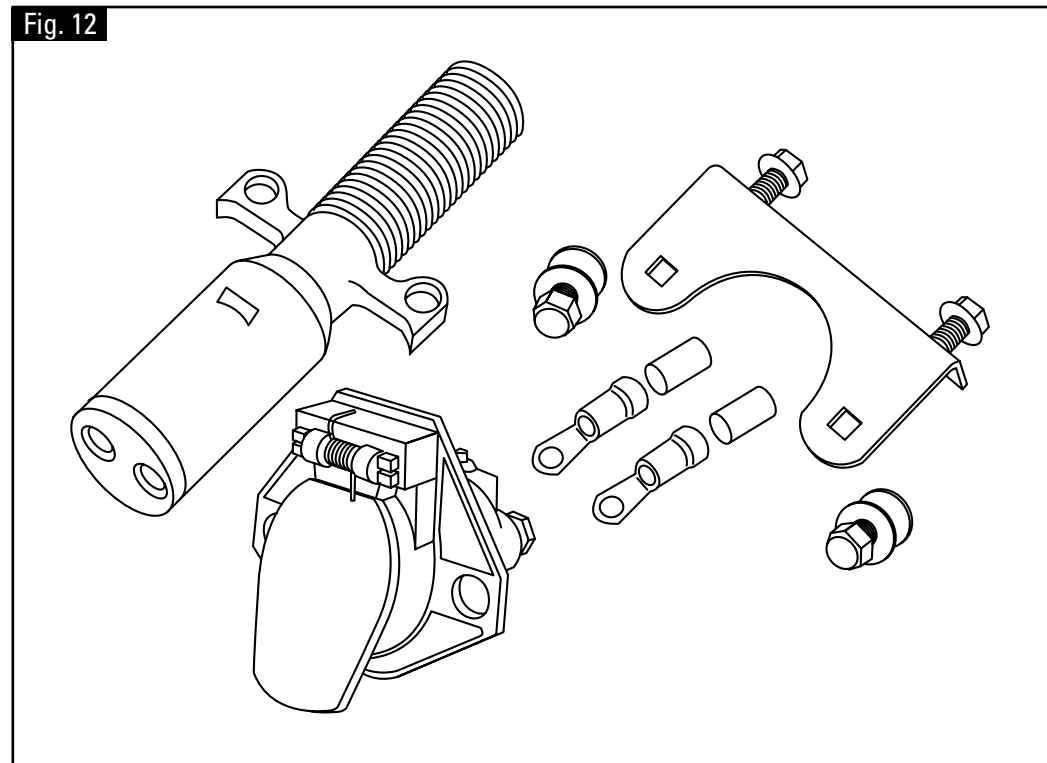

Fig. 11



Option #2, Plug Assembly - Part # 514-0501.

Fig. 12





A Roll-Rite Brand



INSTALLATION INSTRUCTIONS

Steel Four (4) Spring Arm Adjustable System

A technical line drawing of a flap tarp system. It shows a horizontal tarp flap supported by a series of four spring arms. The arms are connected to a vertical support structure on the left and a horizontal beam on the right. The text 'FLAP TARP, ROPE & HOOK INSTALLATION' is overlaid in large, bold, black letters across the center of the diagram.

FLAP TARP, ROPE & HOOK INSTALLATION



INSTALLATION INSTRUCTIONS

Steel Four (4) Spring Arm Adjustable System

Optional Flap Tarp, Rope and Hook Installation

Parts:

Tie Down Hooks (Steel or Alum.)

Pull Down Hook

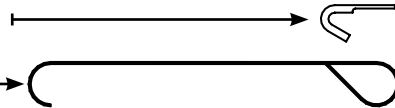

Note: The Location Of The Tie Down Hooks Is Critical!

Step 1: Flip the braided rope over the corner so that the flaps and tie down ropes hang over each side of the box. The number of tie down hooks vary depending on the length of your tarp. One pull down hook is included with your Pulltarp system. If needed. Use the hook to pull the braided rope and flaps over the side of the box.

The tie down hooks must be positioned so that:

1. The tie down rope can be reached from the ground.
2. The bungee cord has to be stretched to reach the last hook (see **Step 2**).
3. The rope has no slack.
4. The tie down hooks are level with one another.

To ensure proper hook placement, first duct tape the rope to the box in place of the tie down hooks. Start with hook closest to the cab.

1. Position the first hook 6" (15.24cm) down and 12" (30.48cm) forward (toward the cab) from the first grommet (Fig. 13).
2. Position 2nd hook straight down from 1st grommet. This hook should be reached from ground (Fig. 14).
3. Place middle hooks equal distances from grommet (Fig. 15). These hooks should be placed at the same height as the second hook.
4. Position last hook (closest to the tailgate) below the last grommet at the same height as the others (Fig. 16).
5. Weld hooks in place.

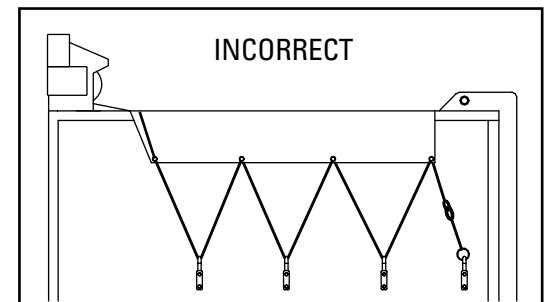
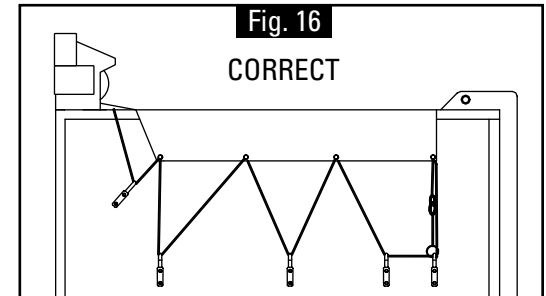
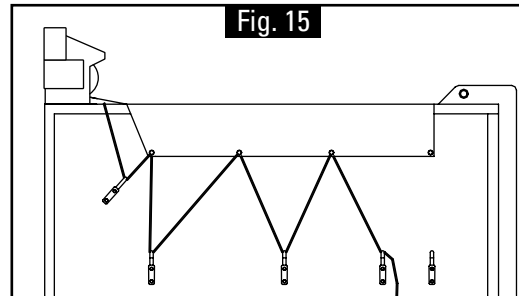
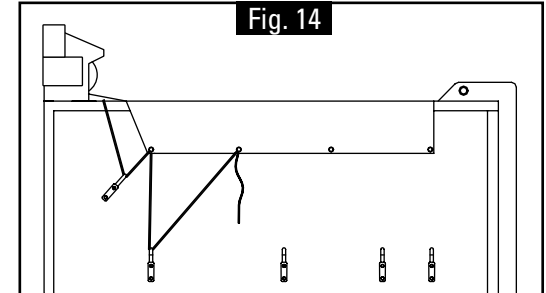
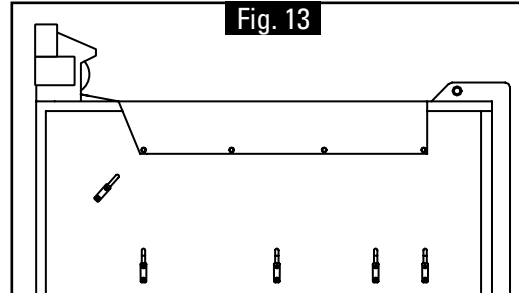



INSTALLATION INSTRUCTIONS

Steel Four (4) Spring Arm Adjustable System

Bungee Cord Installation

Parts:

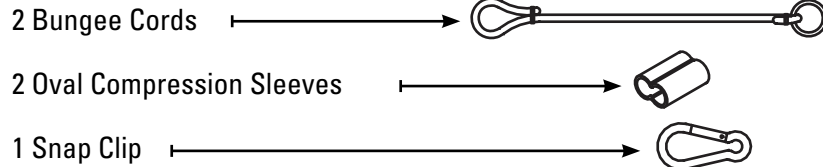

Step 2: After side hooks are installed, the tie down rope must be installed and cut to proper length. It is important to get all of the slack out of the rope to prevent blowing and rubbing of flaps in windy conditions.

Tarps with Side Flaps

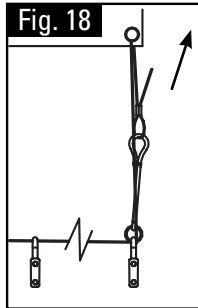
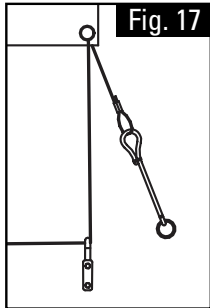

To tighten, pull loose end of rope through the Oval Compression Sleeve (Fig. 17). Stretch the bungee cord making sure all slack is taken out of the rope, crimp compression sleeve (Fig. 18). Be sure to keep flaps even on sides so Tie Down Ropes remain equal in length.

Note: Check for proper placement of rope through the last two hooks.

Snap Clip Installation

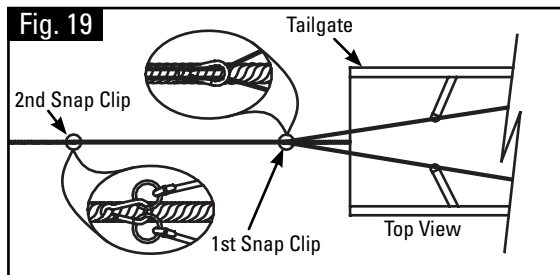

Flip the rope back on top of the tarp, making sure to hold the bungee at all times. The first snap clip is factory installed 5'-6" from the pullrod. Open the clip and enclose the rope. Weave the second clip through the main pullrope where the ends of the bungee cords meet the main pullrope. Make sure the rope is taught when clipped (Fig. 19).

Note: First snap clip should not be used on long wheel base belly dumps.

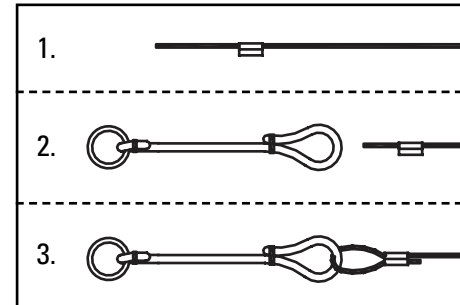

Connect Bungee Cord to Rope

1. Thread braided rope through Oval Compression Sleeve.
2. Feed rope through the eye of the bungee cord.
3. Thread the rope back through the oval compression sleeve. Adjust for proper length. Crimp compression sleeve.

Excess Rope

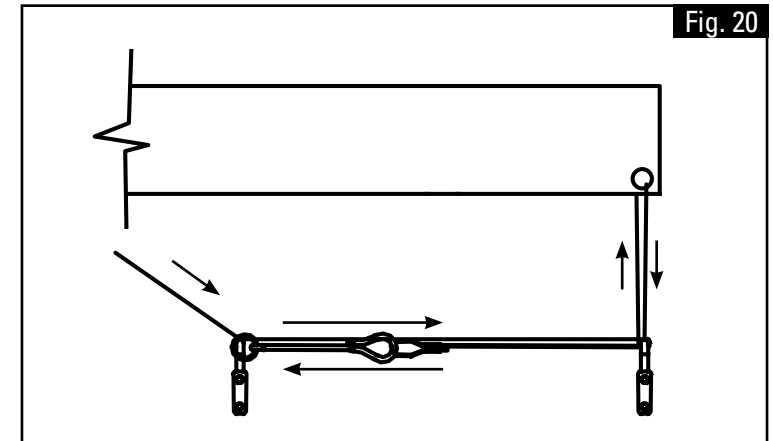

You may need extra rope to keep the side flap system ground operated. If your application requires extra rope, the slack needs to be taken up by attaching the end of the bungee cord to an alternate hook (Fig. 20).



INSTALLATION INSTRUCTIONS

Steel Four (4) Spring Arm Adjustable System

Flap, Rope and Rope Hook Placement

Step 3: Flap/Tie Down Rope placement and installation (Fig. 21).

Fig. 21

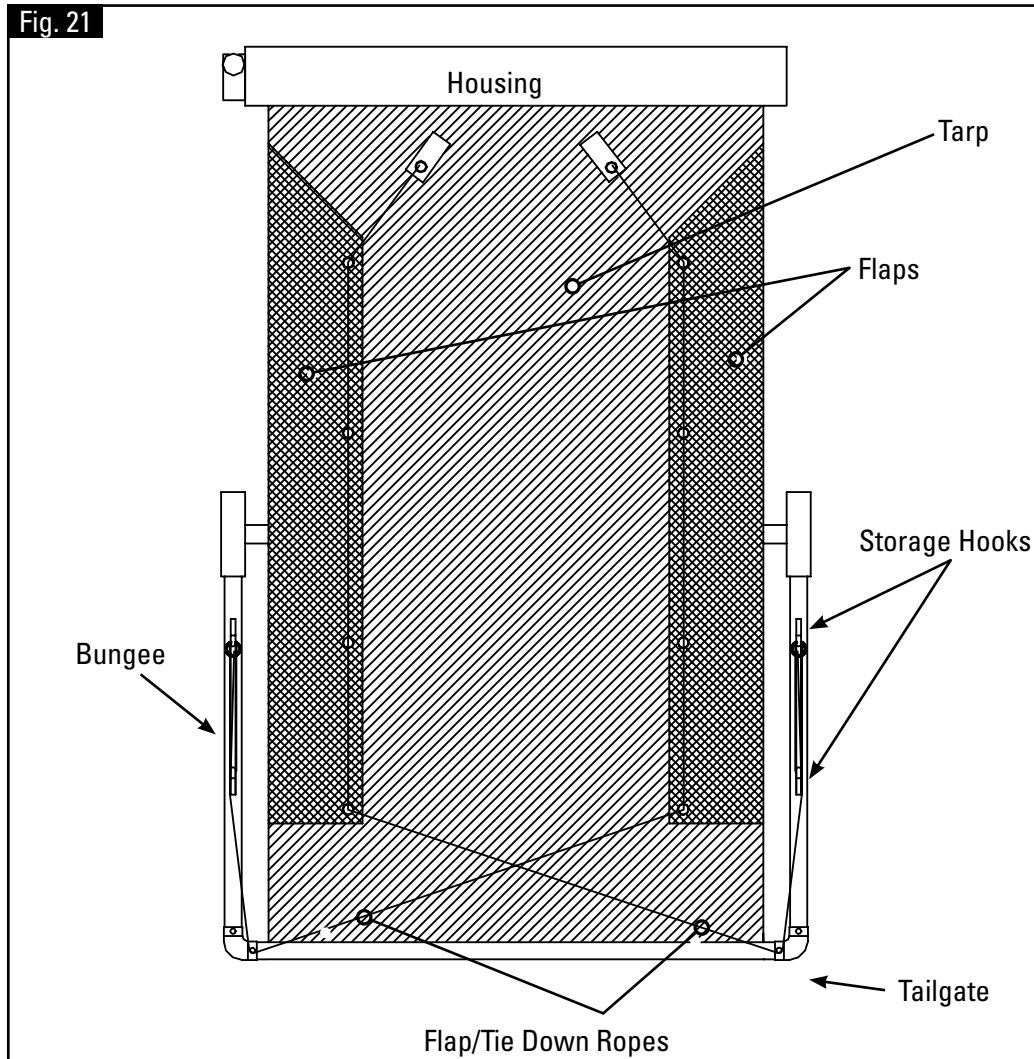

Step 5: Rope Hook Placement For Steel Arms

Weld rope storage hook on the top of the arms approximately 32" apart (Fig. 22).

Fig. 22

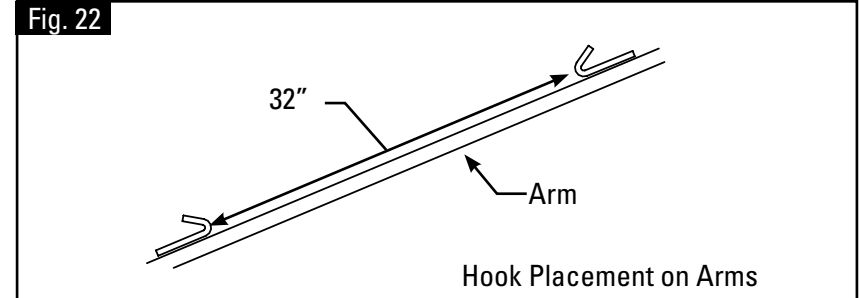

Step 6: Rope Hook Placement For Aluminum Arms

Use Self Drilling screws (part #506-9933) to install Hooks (Fig. 23A & B).

Fig. 23A

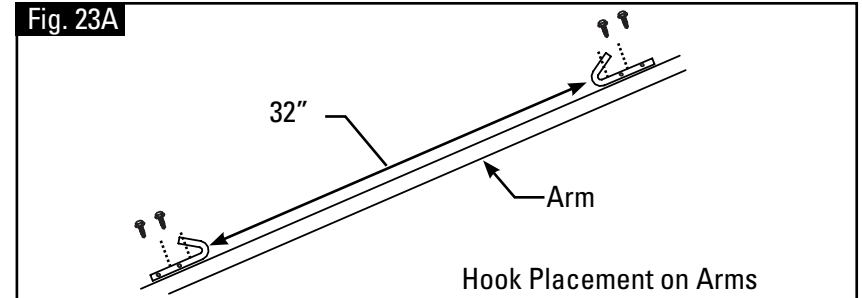

Fig. 23B

