



1404 N. Marshall Ave. El Cajon CA. 92020

Steel Four (4) Spring Arm Adjustable System Installation Instructions

WLH 05/02/16

501-1755, 501-1756

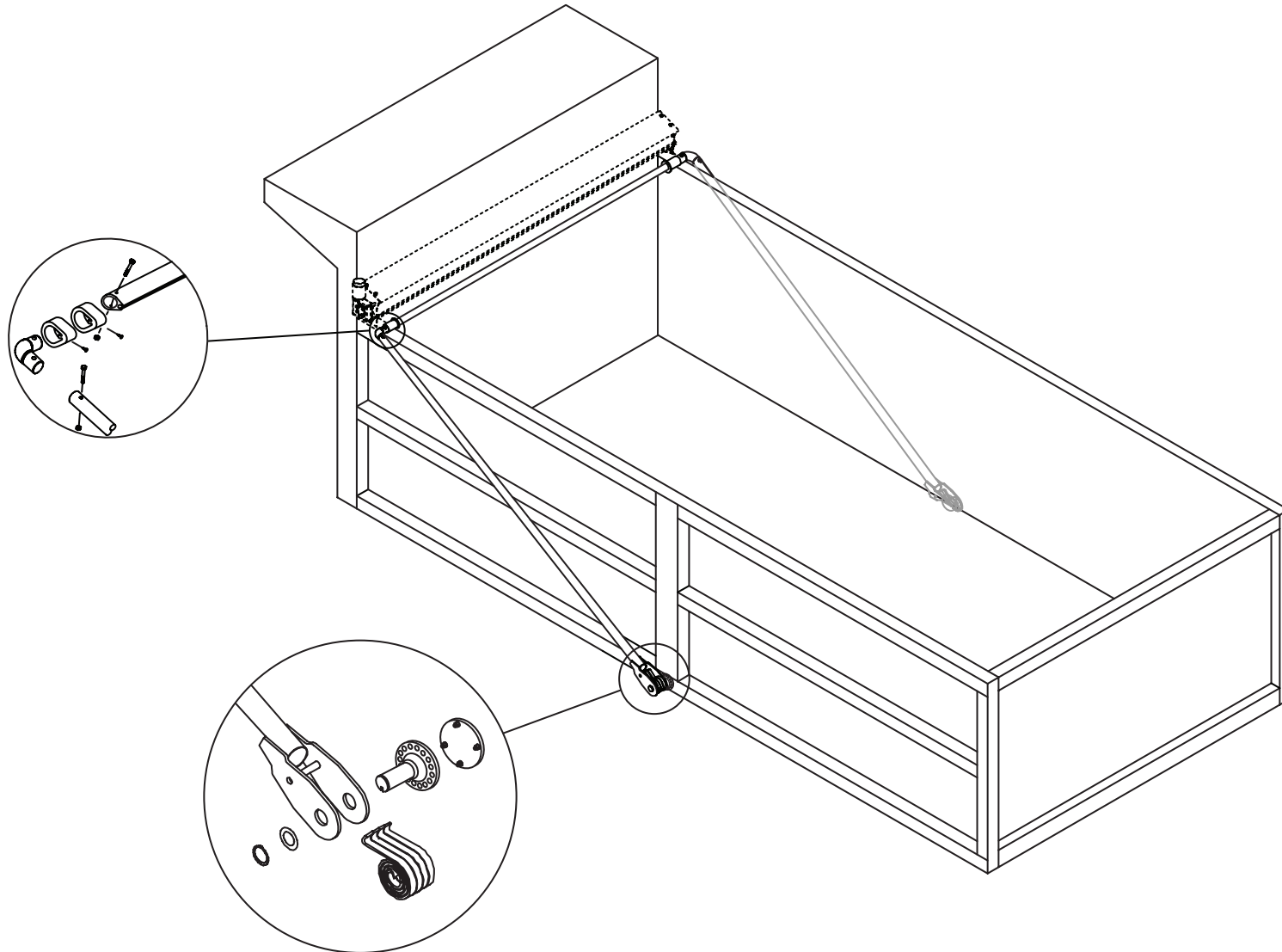

607-0141

For technical support call us at (800) 368-3075 or visit our website at Pulltarps.com.



1404 N. Marshall Ave. El Cajon CA. 92020

Steel Four (4) Spring Arm Adjustable System Installation Instructions

TABLE OF CONTENTS

Assembly

Pivot Points and Mounting Locations	1
Arm Alignment, Tarp and Pull Bar Installation	2
Optional Flap Tarp, Rope and Hook Installation	3
Bungee Cord Installation	4
Flap, Rope and Rope Hook Placement	5
Plug Assembly	6

Parts

Steel Arms to 22'	7
4 Spring Housing Assembly	8

Pivot Points and Mounting Locations

Step 1: Determining the Pivot Points and Mounting Locations on each side, careful measurement must be taken to insure that the arm and pivot assemblies are mounted square and parallel to the truck or trailer body. Locate the proper mounting positions by determining Point "A" and Point "B" and insuring measurement "D" and "E" are equal (Fig. 1). Point "C" must be located as low as possible and be the same on both sides.

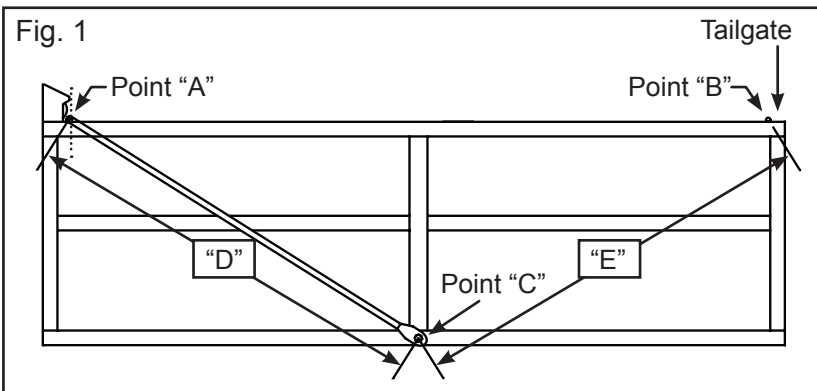

Step 2 - Arm Preload: Install Arm and Pivot assemblies with Arm indexed (Fig. 2). Arms must be indexed with no spring load on pivots. Index Arm at 180 degrees of travel from the Roller Mechanism for proper preload of the spring. The dotted lines represent proper 180 degree preload position for applications with Bent Arms. Mark pivot pin location on box.

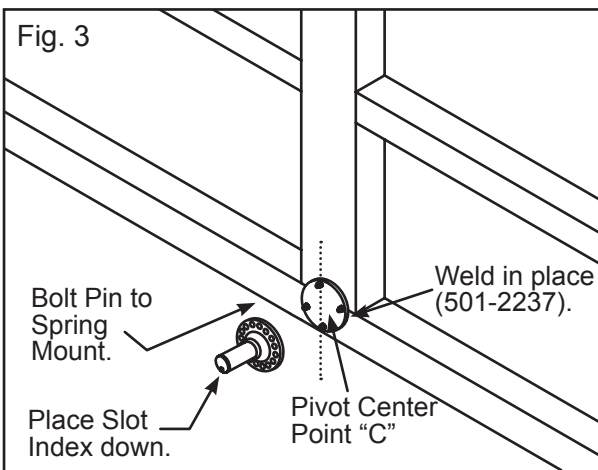
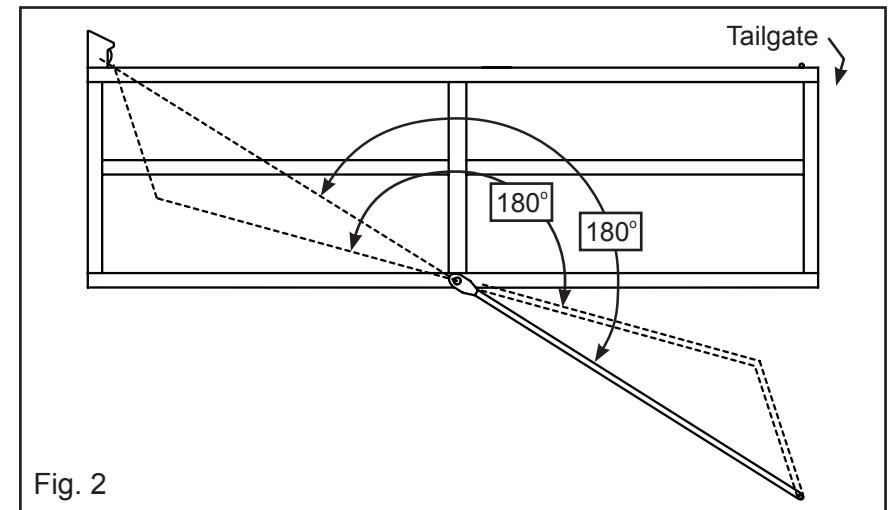

Step 3 - Mounting the Pivot:

Locate the Pivot pin with marks made in step 2. Weld the Spring Mounting in place and then bolt on the Steel Adjustment Pin with the Slot Index down (Fig. 3).

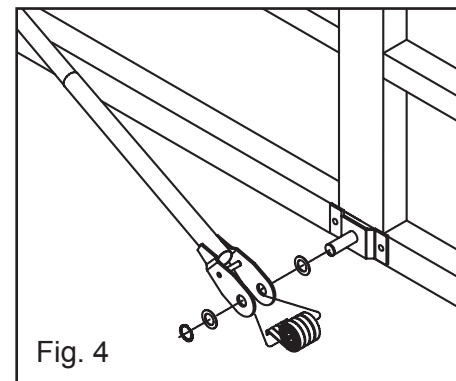

Step 4 - Pivot & Spring Assembly:

Assemble the springs and pivot assembly (Fig. 4). Make sure assembly moves freely.

Arm Alignment, Tarp and Pull Bar Installation

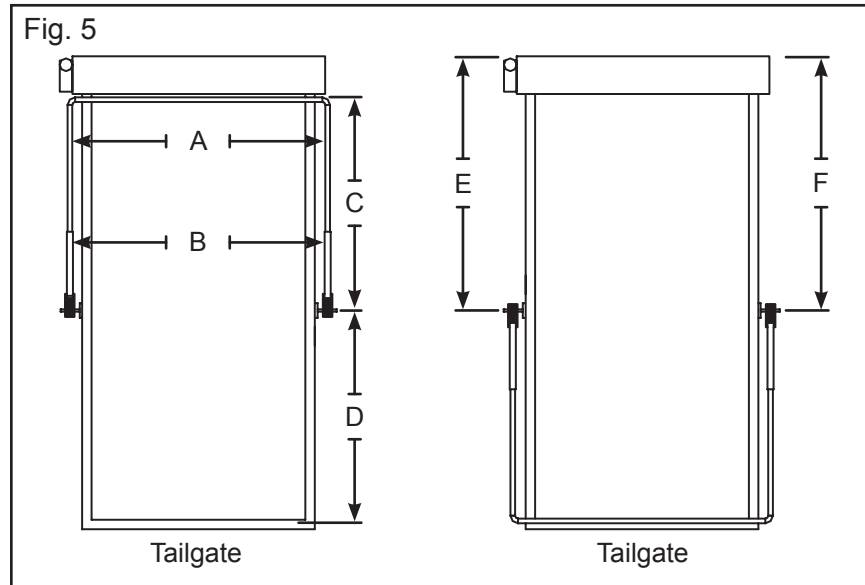

Step 5 - Correct Alignment of arm to truck:

Arms and pivots must be square and parallel to truck (Fig. 5).

(Dimension "A" must equal "B" - Dimension "C" must equal "D" - Dimension "E" must equal "F")

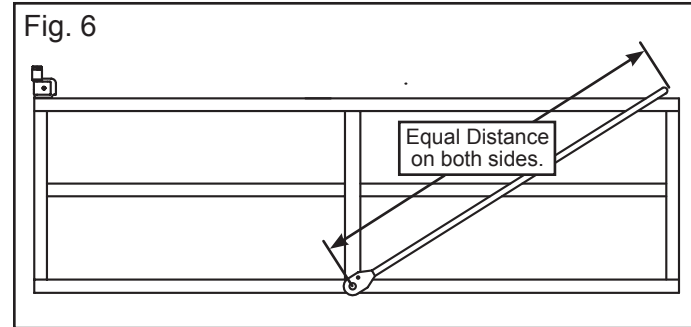

Step 6: Adjust the Arms on both sides to be the same length (Fig. 6).

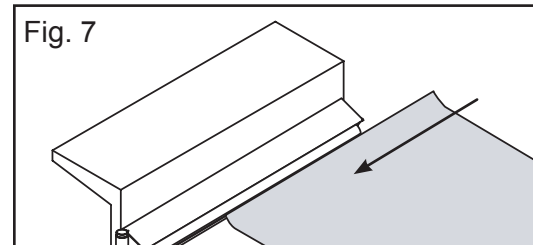

Step 7 - Tarp Installation:

Slide Tarp into Groove on roller tube and center (Fig. 7).

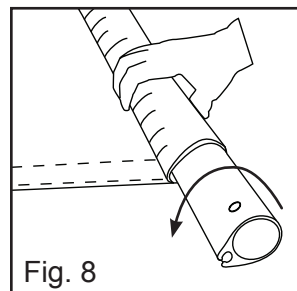

Step 8 - Installing The Pull Bar:

Cut the pull bar to length making sure the arms remain parallel and square to the body.

Slide the tarp into groove in the pull bar and center the tarp.

Roll the tarp up on the pull bar two revolutions (Fig. 8).

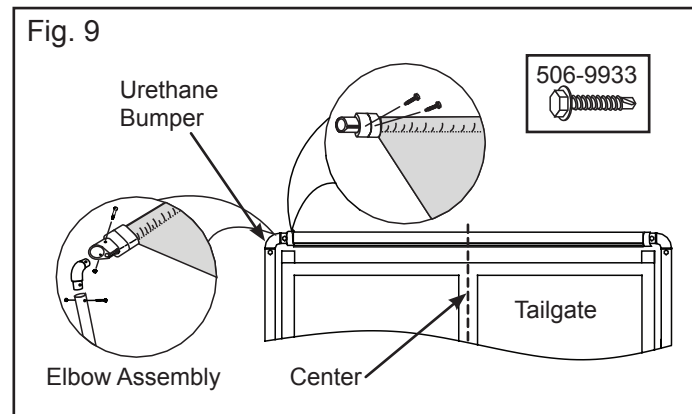

Step 9: Fasten the tarp in place by sliding the two urethane bumpers on to the pull bar far enough to touch the edges of the tarp. Lock in place by installing a 1 1/2" long (506-9933) self drilling screw through the bumper and into the hem tube groove of the pull bar. (Fig. 9)

Note: Tarp must be retracted when dumping.

Optional Flap Tarp, Rope and Hook Installation

Parts:

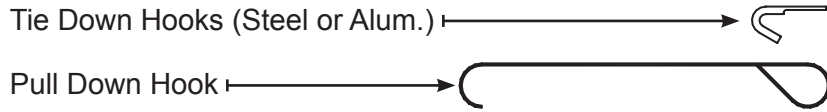

Note: The Location Of The Tie Down Hooks Is Critical!

Step 10: Flip the braided rope over the corner so that the flaps and tie down ropes hang over each side of the box. The number of tie down hooks vary depending on the length of your tarp. One pull down hook is included with your Pulltarp system. If needed. Use the hook to pull the braided rope and flaps over the side of the box.

The tie down hooks must be positioned so that:

1. The tie down rope can be reached from the ground.
2. The bungee cord has to be stretched to reach the last hook (see **Step 11**).
3. The rope has no slack.
4. The tie down hooks are level with one another.

To ensure proper hook placement, first duct tape the rope to the box in place of the tie down hooks. Start with hook closest to the cab.

1. Position the first hook 6" (15.24cm) down and 12" (30.48cm) forward (toward the cab) from the first grommet (Fig. 10).
2. Position 2nd hook straight down from 1st grommet. This hook should be reached from ground (Fig.11).
3. Place middle hooks equal distances from grommet (Fig.12). These hooks should be placed at the same height as the second hook.
4. Position last hook (closest to the tailgate) below the last grommet at the same height as the others (Fig.13).
5. Weld hooks in place.

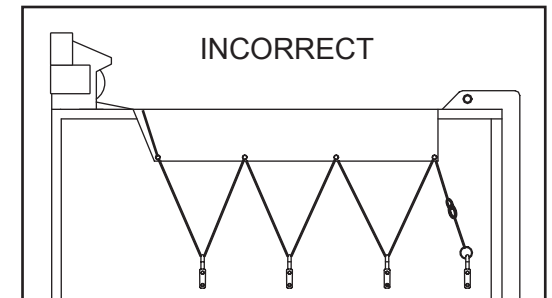
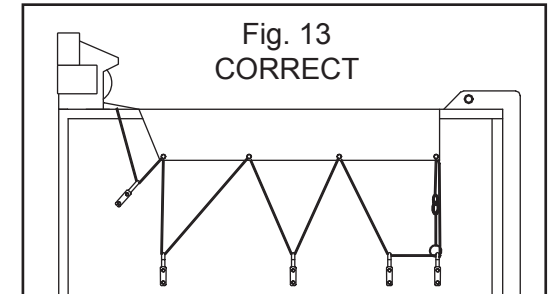
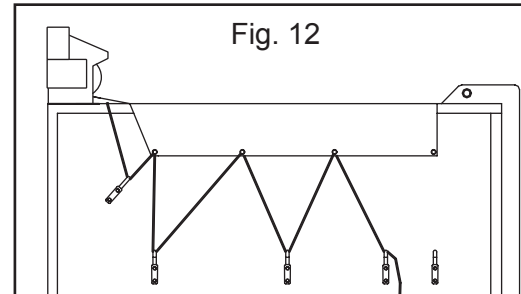
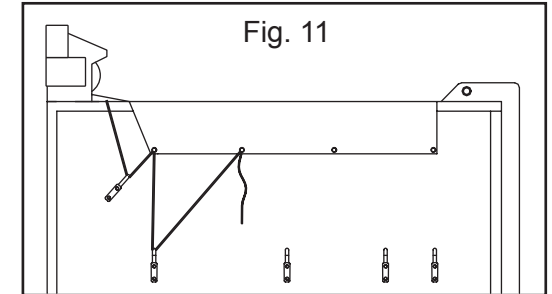
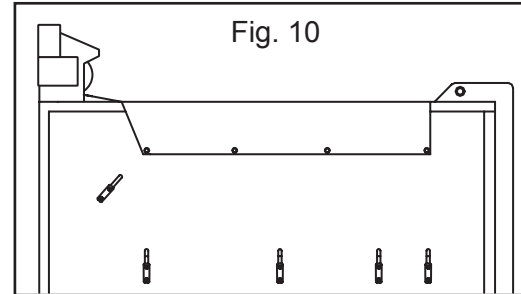

Bungee Cord Installation

Parts:

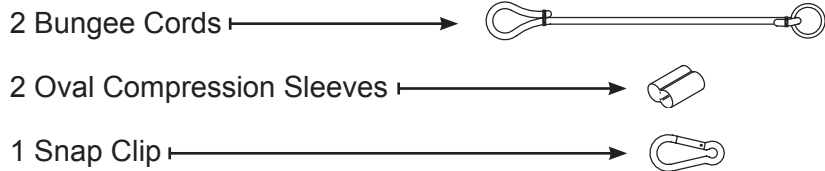

Step 11: After side hooks are installed, the tie down rope must be installed and cut to proper length. It is important to get all of the slack out of the rope to prevent blowing and rubbing of flaps in windy conditions.

Tarps with Tie Downs

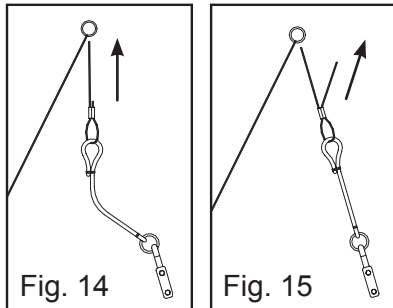

To tighten, pull loose end of rope through the Oval Compression Sleeve (Fig. 14). Stretch the bungee cord making sure all slack is taken out of the rope, crimp compression sleeve (Fig. 15).

Snap Clip Installation

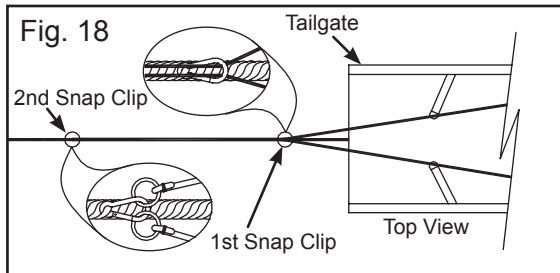

Flip the rope back on top of the tarp, making sure to hold the bungee at all times. The first snap clip is factory installed 5'-6" from the pullrod. Open the clip and enclose the rope. Weave the second clip through the main pullrope where the ends of the bungee cords meet the main pullrope. Make sure the rope is taught when clipped (Fig. 18).

Note: First snap clip should not be used on long wheel base belly dumps.

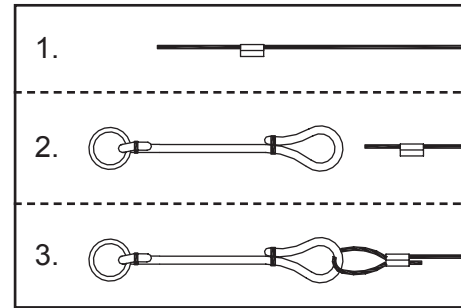

Connect Bungee Cord to Rope

1. Thread braided rope through Oval Compression Sleeve.
2. Feed rope through the eye of the bungee cord.
3. Thread the rope back through the oval compression sleeve. Adjust for proper length. Crimp compression sleeve.

Tarps with Side Flaps

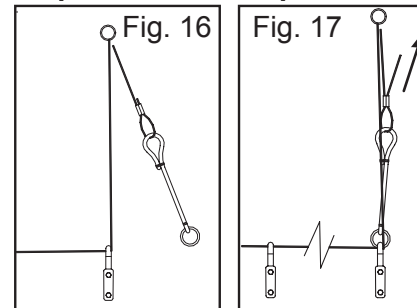

To tighten, pull loose end of rope through the Oval Compression Sleeve (Fig. 16). Stretch the bungee cord making sure all slack is taken out of the rope, crimp compression sleeve (Fig. 17).

Note: Check for proper placement of rope through the last two hooks.

Excess Rope

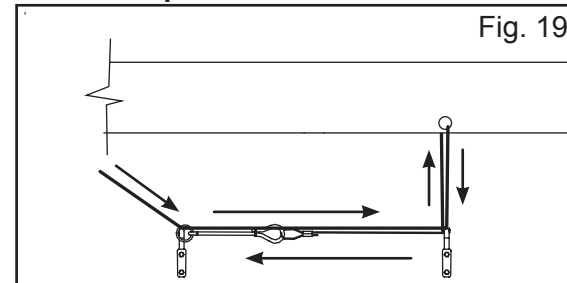

You may need extra rope to keep the side flap system ground operated. If your application requires extra rope, the slack needs to be taken up by attaching the end of the bungee cord to an alternate hook (Fig. 19).

Flap, Rope and Rope Hook Placement

Step 12 - Flap / Tie Down Rope Placement and Installation (Fig. 20).

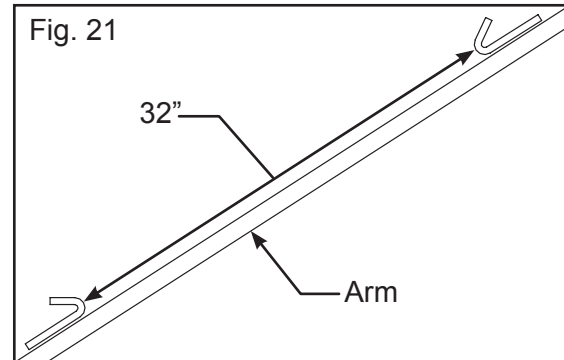
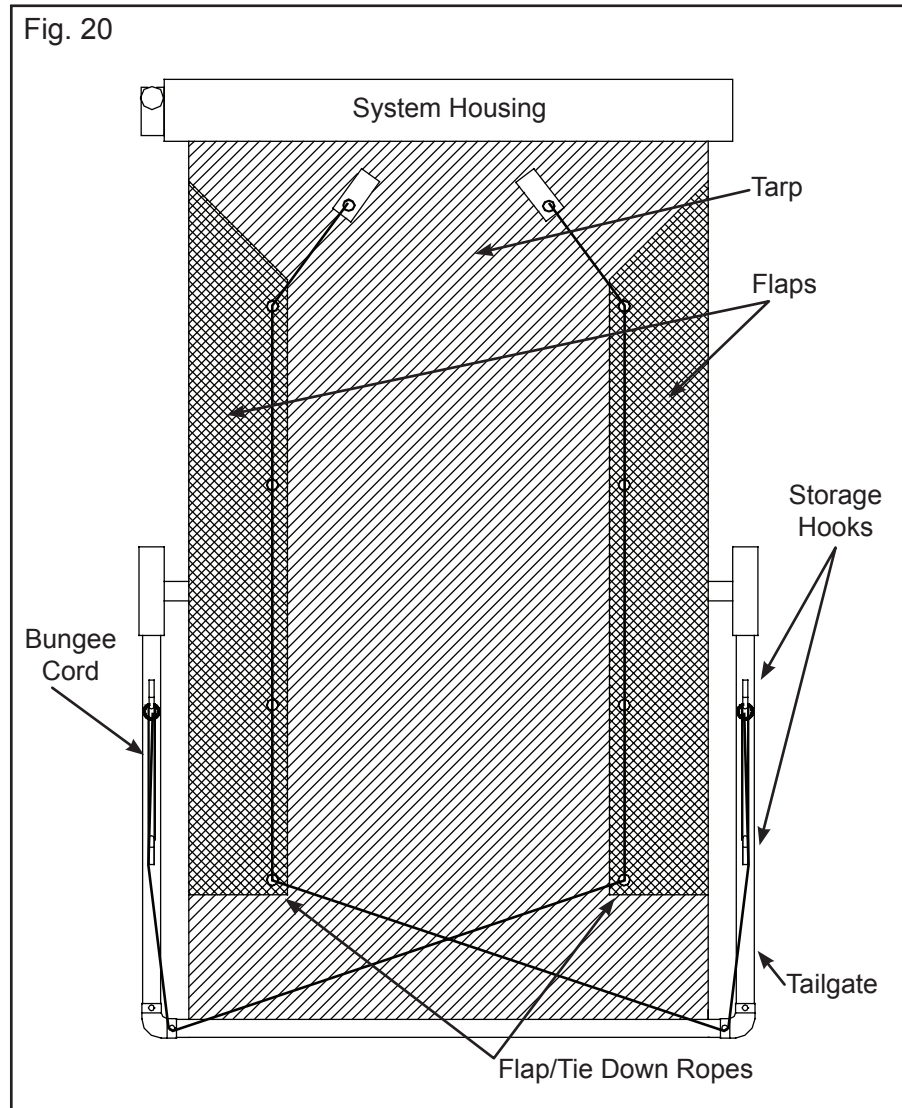

Step 13 - Rope Hook Placement: Weld rope storage hook on the top of the arms approx. 32" apart (Fig. 21).

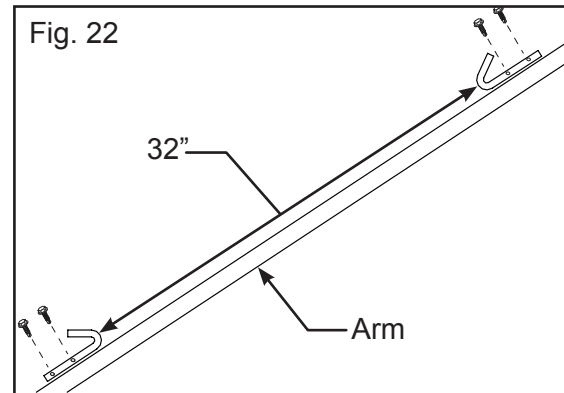

Step 14 - Rope Hook Placement For Aluminum Arms: Use Self Drilling screws (part #506-9933) to install hooks (Fig. 22).

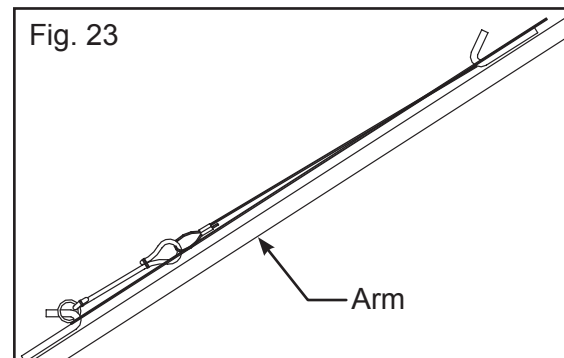

Step 15 - Rope storage on Arms (Fig. 23).

Plug Assembly

Step 16: Assemble the Quick Disconnect (Fig. 24, 25 & 26).
Option #1, Plug Assembly - Part # 514-0505.

Fig. 24

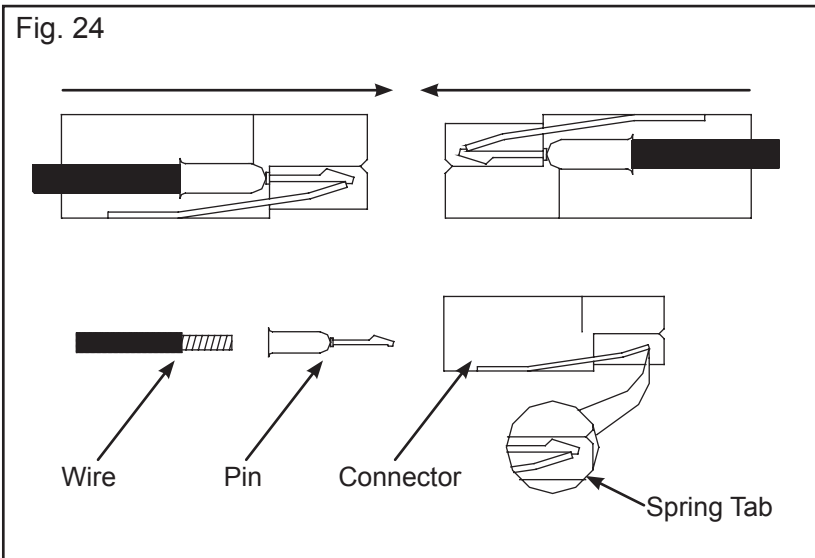
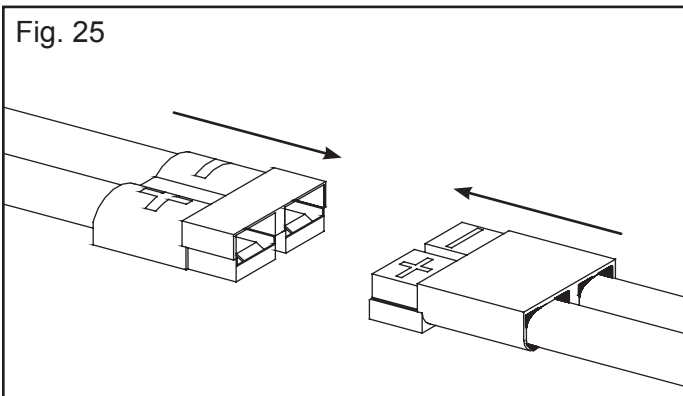
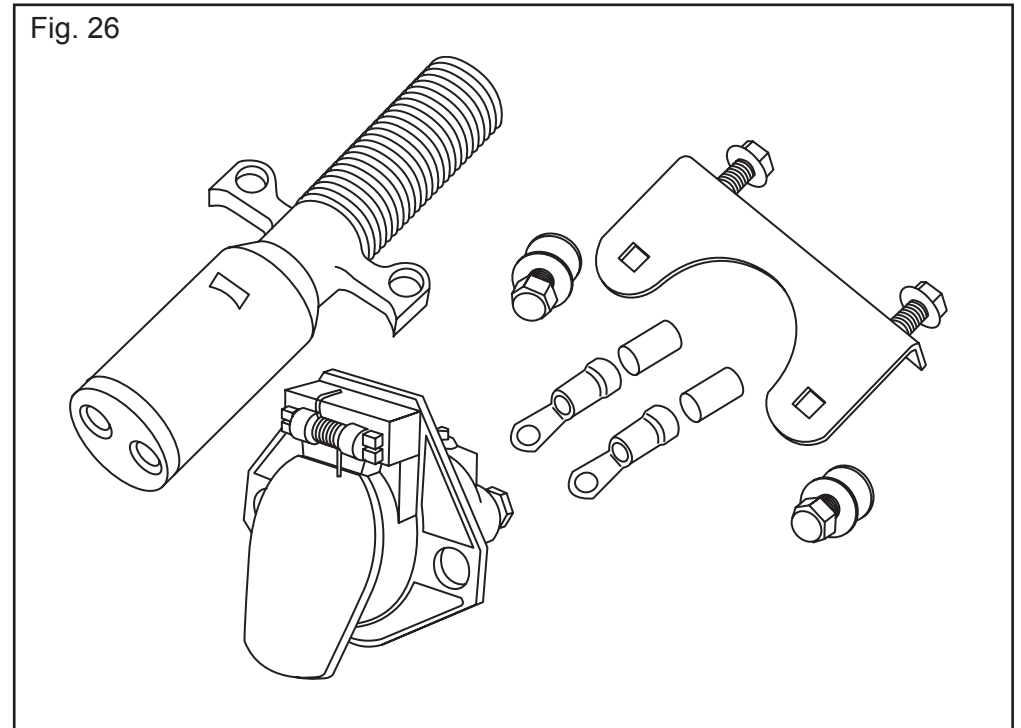

Fig. 25



Option #2, Plug Assembly - Part # 514-0501.

Fig. 26



Steel Four (4) Spring Arm Adjustable System Installation Instructions

Steel Arms to 22' (Part # 501-1755, 501-1756)

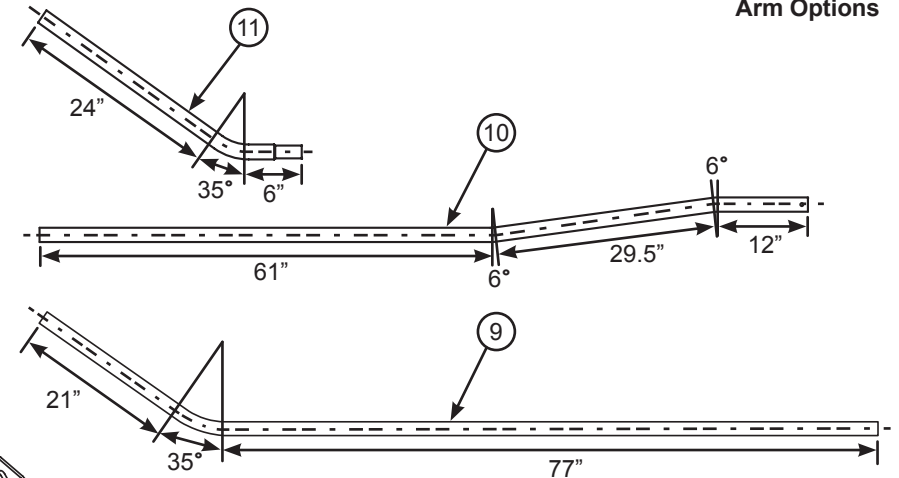
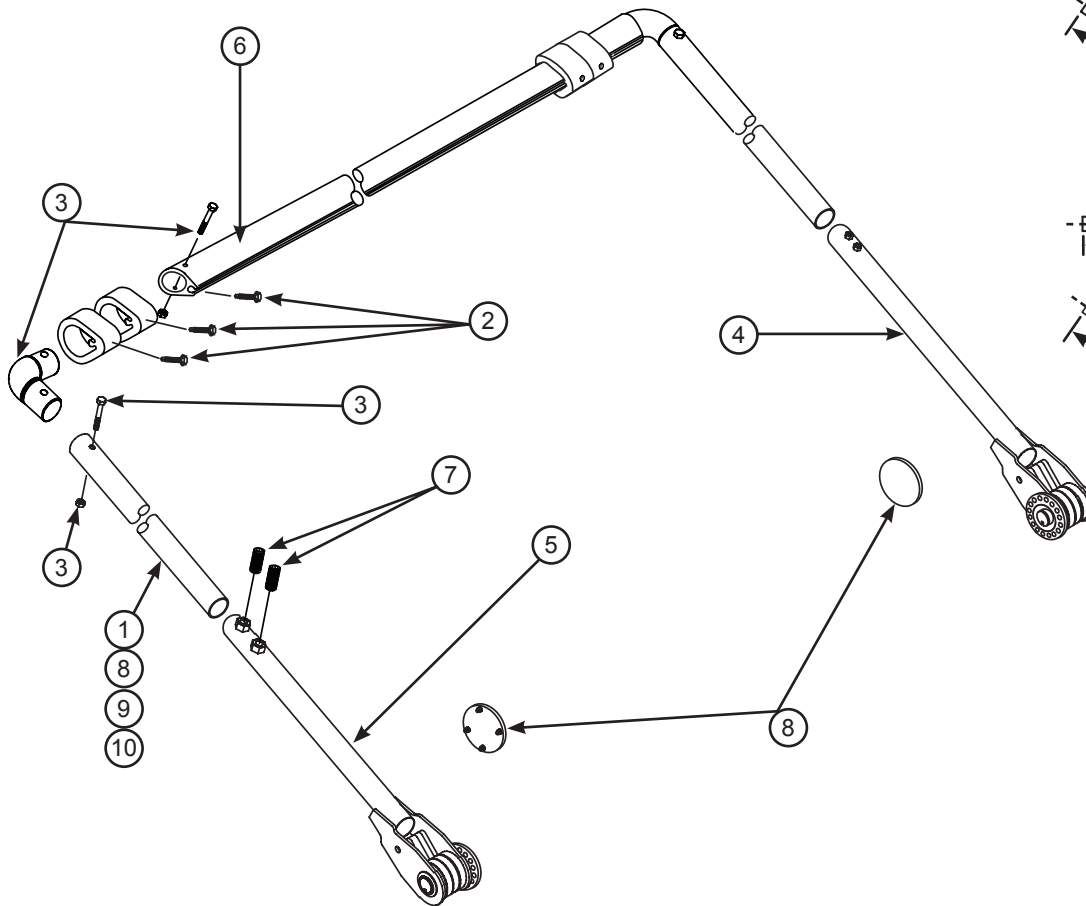

ITEM	PART #	DESCRIPTION	QTY
1	501-1202	Steel Upper Arm Tubing	2
2	501-1293	Tear Drop Bumper Kit	1
3	501-1251	Elbow Kit (For Steel)	1
4	501-2207	4-Spring Housng-Driver Side	1
5	501-2208	4-Spring Housing-Passenger Side	1
6	501-0430	Universal Tear Drop Pullrod	1
7	501-0430	1/2" - 13 x 3/4" Set Screw	4
8	501-2237	3/8" Spring Mounting	2
ITEM	PART #	ARM OPTIONS - DESCRIPTION	QTY
9	501-1205	Upper Arm Tubing, Drilled and Bent	2
10	501-1207	Offset Upper Arm Tube	2
11	501-1230	Upper Arm Bent Extension - 35°	2

Illustration view shown looking from passenger side to rear of vehicle.

GR REV. 8/2/12

4 Spring Housing Assembly (Part # 501-2207 Opposite & 501-2208 Shown)

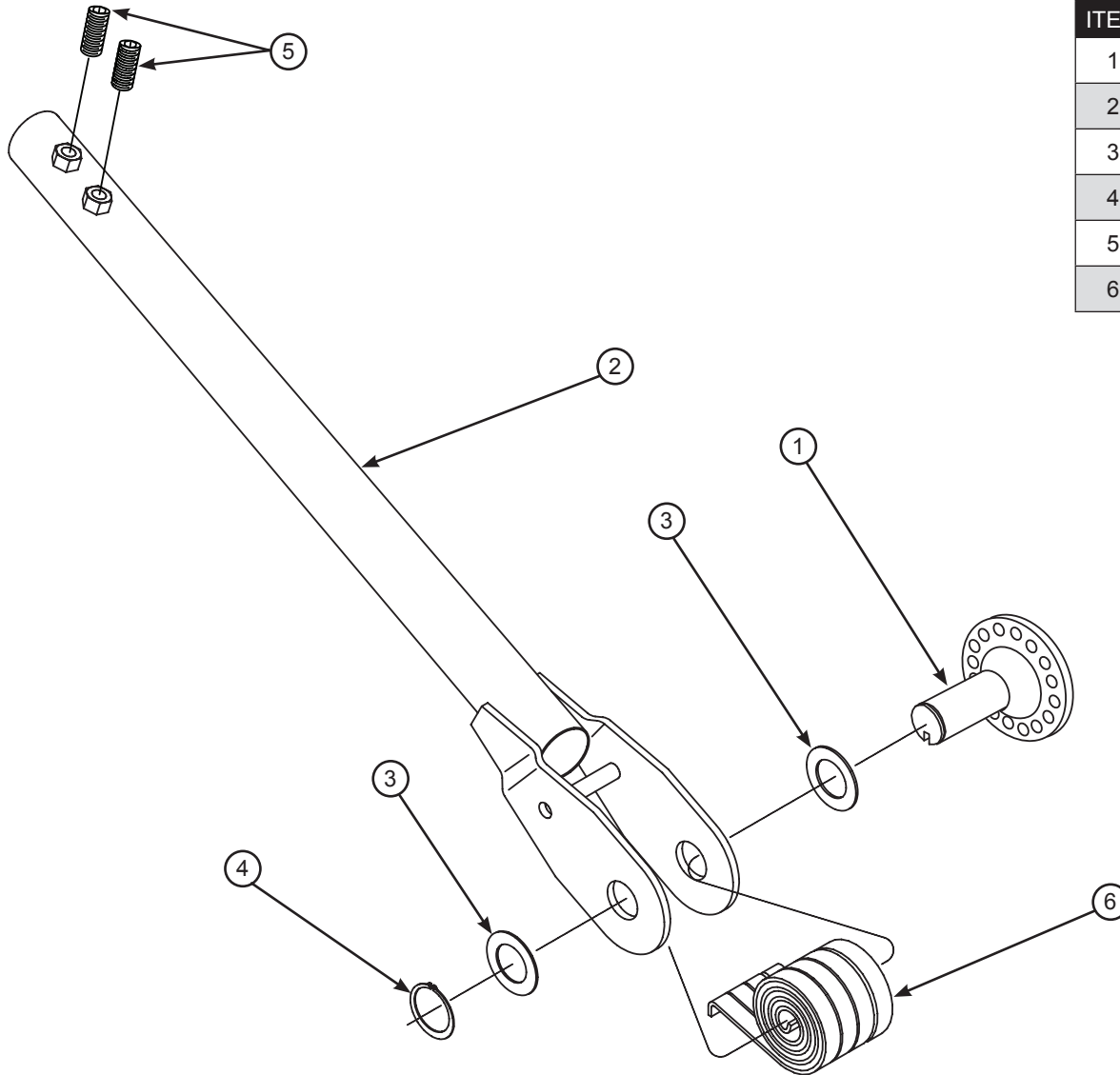

ITEM	PART #	DESCRIPTION	QTY
1	501-2243	Pivot Assembly, Steel Adj. 4 Spring	1
2	501-1110	4-Spring Side Plate Assembly	1
3	501-1162	Washer, 1 7/8" x 1 1/4" Narrow Rim	2
4	506-0101	1 1/4" Snap Ring	1
5	503-5008	1/2" - 13 x 3/4" Set Screw	4
6	517-9921	Small Spring for Arm System	4

BAB REV. 12/3/08