



INSTALLATION INSTRUCTIONS

EZ-Mount 4 Spring Enclosed System to 22'(Low & High Mount Applications)

Related Instructions,
How-To Videos & More

501-1768 (With Wire)
501-1769 (No Wire)

501-1766 (With Wire)
501-1767 (No Wire)



[PDF: Optional Tarp Tamer](#)



[PDF: Bolt-On Mounting System](#)



[PDF: Deluxe High Amp Switch - 12V](#)



[PDF: Cab External Switch - 12V](#)



[PDF: 12V Smart Switch w/ External Switch](#)

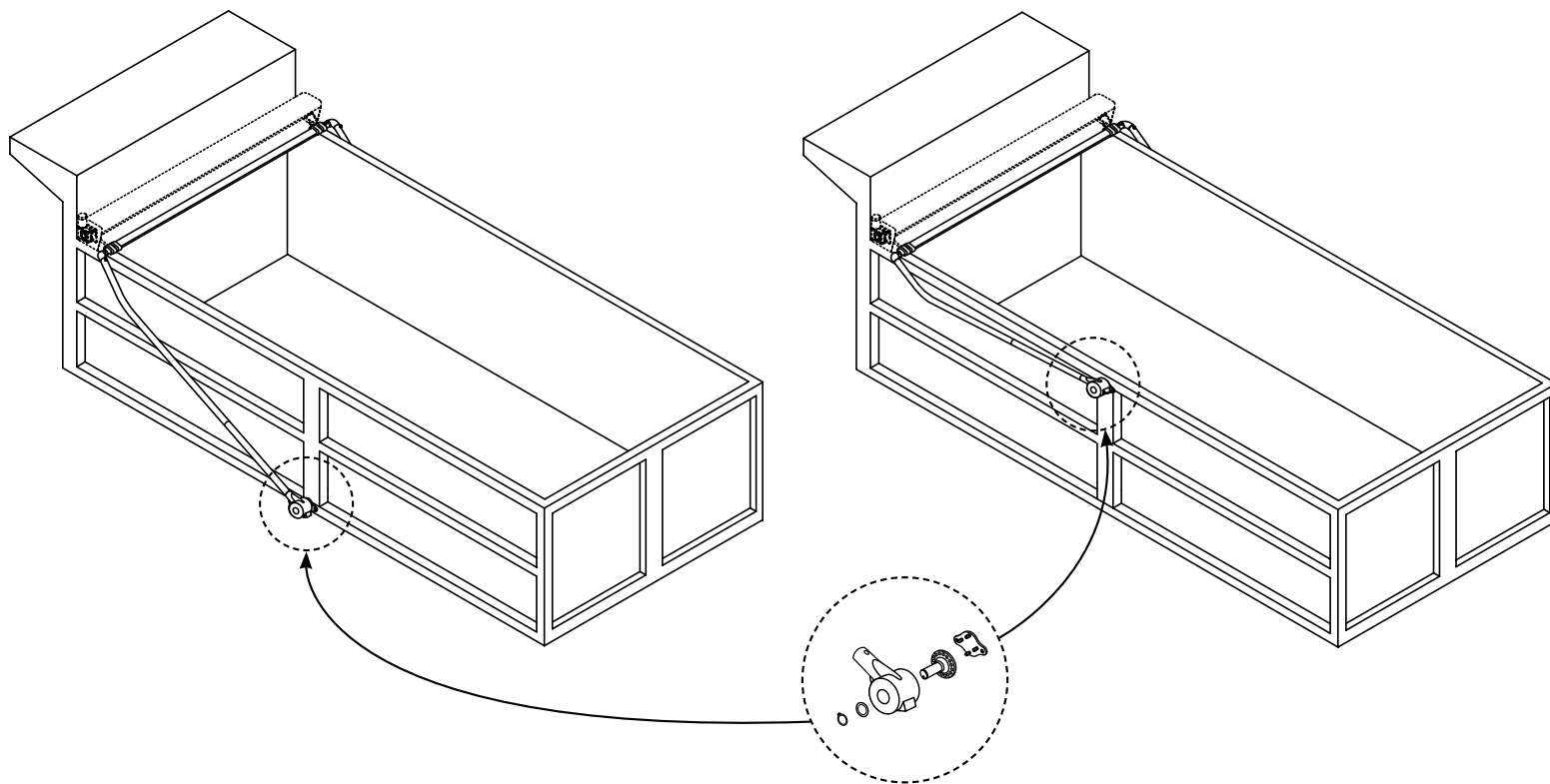

Document #: 607-0145
Revised: 10/01/25 WLH

DURING INSTALLATION, SOME FABRICATION MAY BE REQUIRED.



A Roll-Rite Brand



INSTALLATION INSTRUCTIONS

EZ-Mount 4 Spring Enclosed System to 22'(Low & High Mount Applications)

Table of Contents

Tools & Parts

Recommended Tools 2

High Mount Extended Reach Arm System #501-1766 (With Wire) #501-1767 (No Wire) 3

EZ-Mount 4 Spring Arm System #501-1768 (With Wire) #501-1769 (No Wire) 4

4 Spring Enclosed Housing Assembly Right #501-2204 (not shown) & Left #501-2203 (shown) 5

Installation

Pivot Points and Mounting Locations (Low Mount) 7

Pivot Points and Mounting Locations (High Mount) 8

Arm Alignment, Tarp and Pullbar Installation..... 9

Quick Disconnect Plug Assembly 10

Flat Tarp, Rope & Hook Installation

Optional Flap Tarp, Rope and Hook Installation 12

Bungee Cord Installation 13

Flap, Rope and Rope Hook Placement 14





A Roll-Rite Brand



INSTALLATION INSTRUCTIONS

EZ-Mount 4 Spring Enclosed System to 22' (Low & High Mount Applications)

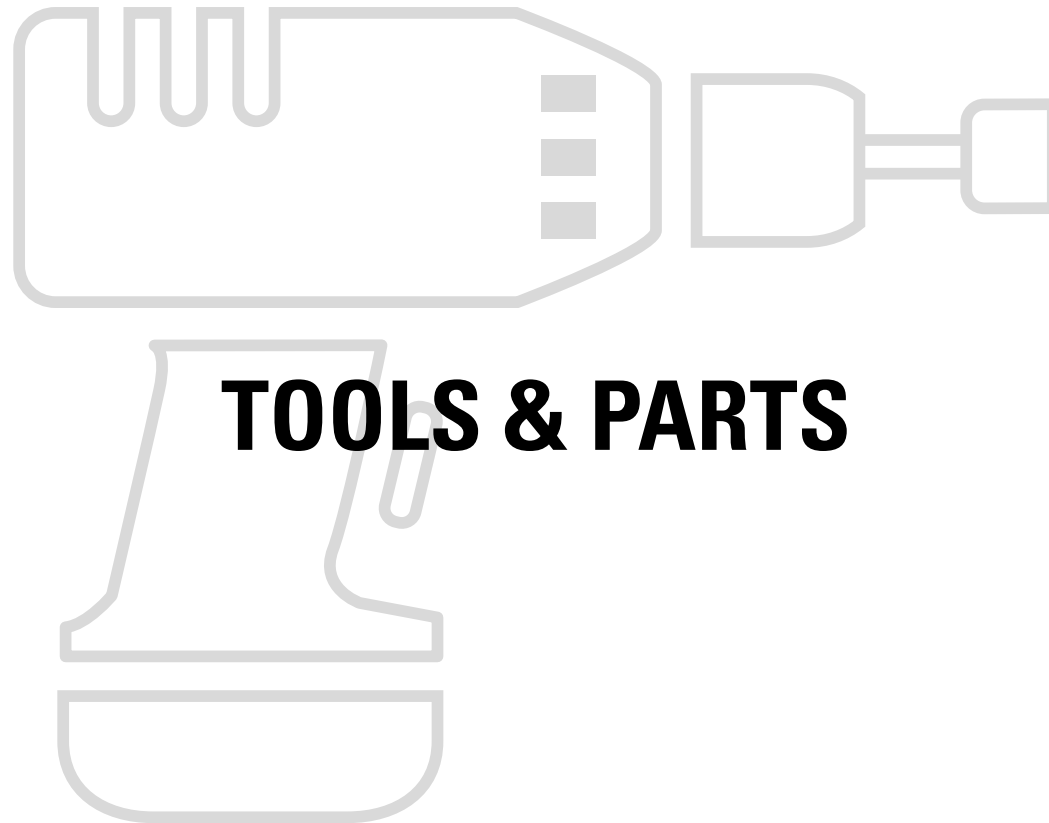

TOOLS & PARTS



A Roll-Rite Brand



INSTALLATION INSTRUCTIONS

EZ-Mount 4 Spring Enclosed System to 22'(Low & High Mount Applications)

Recommended Tools



Safety Glasses and Gloves



Welding Equipment & Helmet

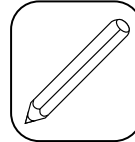

Pencil or Marker



Metal File



Hacksaw



Tape Measure



Rubber Mallet

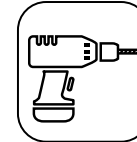

Impact Drill (Optional)



Adjustable Wrench

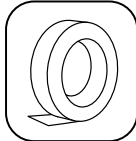

Masking Tape

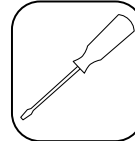

Flathead Screwdriver



INSTALLATION INSTRUCTIONS

EZ-Mount 4 Spring Enclosed System to 22'(Low & High Mount Applications)

High Mount Extended Reach Arm System #501-1766 (With Wire)

#501-1767 (No Wire)

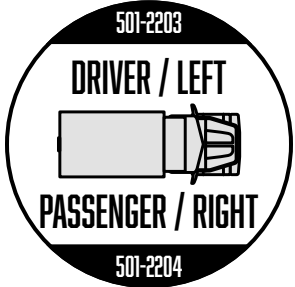
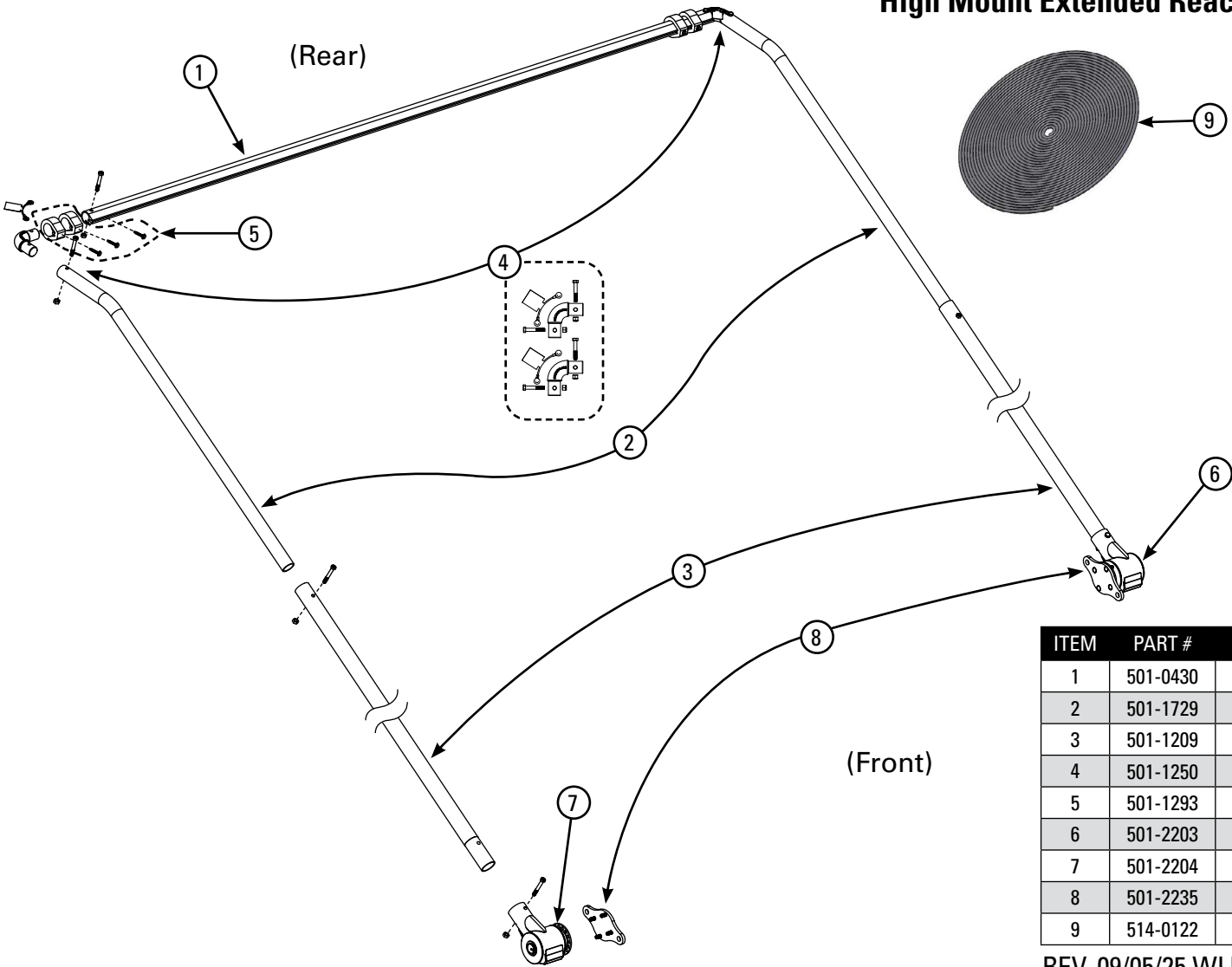

ITEM	PART #	DESCRIPTION	QTY
1	501-0430	103" Teardrop Pull Bar	1
2	501-1729	51" Aluminum Bent Upper Arm	2
3	501-1209	103" Aluminum Lower Arm	2
4	501-1250	Aluminum Elbow & Upper Connection	2
5	501-1293	Teardrop Bumper Kit	1
6	501-2203	4 Spring Enclosed Housing Assembly (Left)	1
7	501-2204	4 Spring Enclosed Housing Assembly (Right)	1
8	501-2235	EZ-Mount Assembly	2
9	514-0122	6GA. Wire 80' Long (For 501-1766)	1

REV. 09/05/25 WLH



INSTALLATION INSTRUCTIONS

EZ-Mount 4 Spring Enclosed System to 22'(Low & High Mount Applications)

EZ-Mount 4 Spring Arm System #501-1768 (With Wire)

#501-1769 (No Wire)

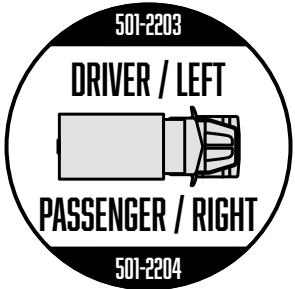
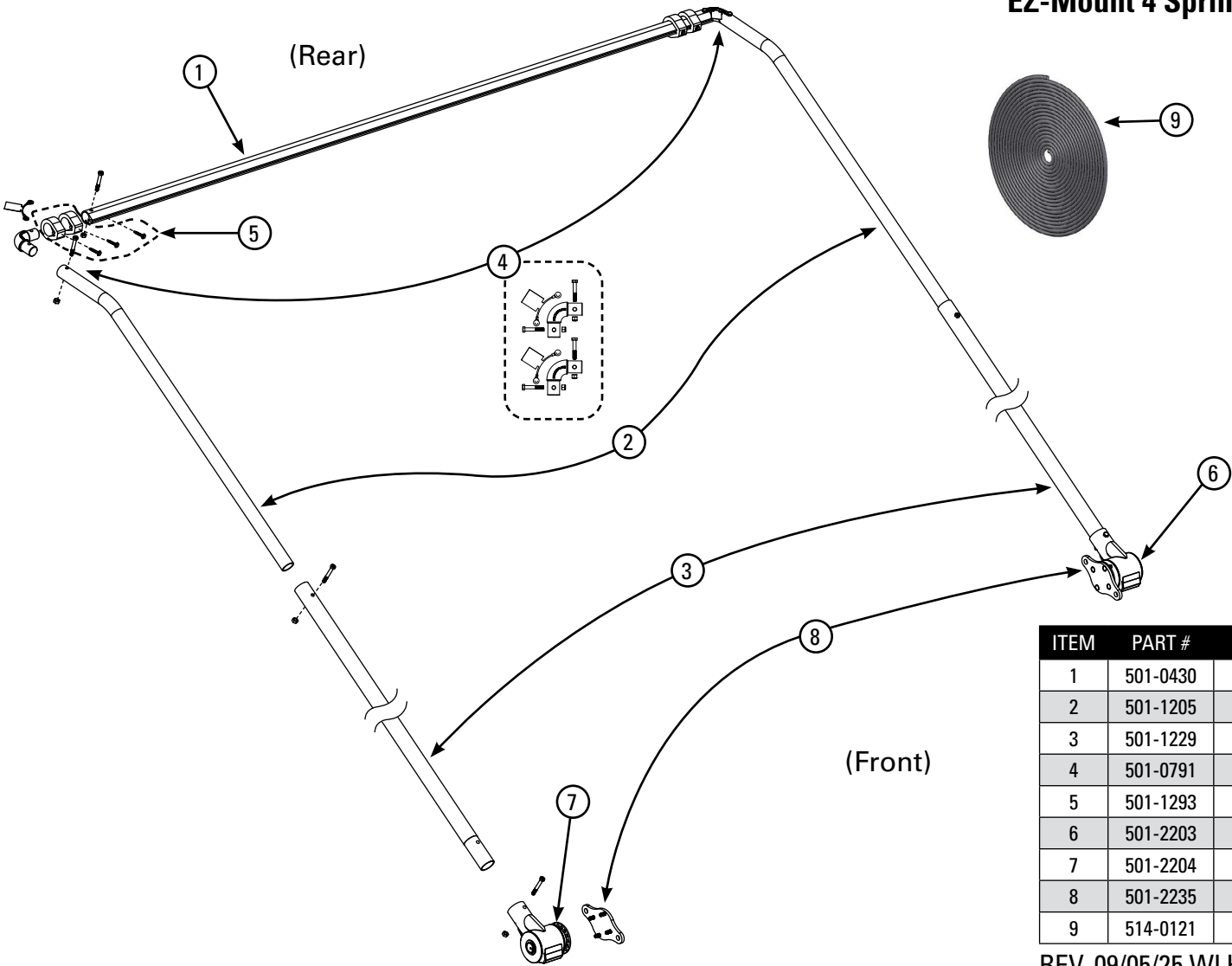

ITEM	PART #	DESCRIPTION	QTY
1	501-0430	103" Teardrop Pull Bar	1
2	501-1205	103" Steel Upper Arm Bent	2
3	501-1229	Lower Connection Arm Tube	2
4	501-0791	Steel/Aluminum Elbow & Upper Connection	2
5	501-1293	Teardrop Bumper Kit	1
6	501-2203	4 Spring Enclosed Housing Assembly (Left)	1
7	501-2204	4 Spring Enclosed Housing Assembly (Right)	1
8	501-2235	EZ-Mount Assembly	2
9	514-0121	6GA. Wire 70' Long (For 501-1768)	1

REV. 09/05/25 WLH



INSTALLATION INSTRUCTIONS

EZ-Mount 4 Spring Enclosed System to 22'(Low & High Mount Applications)

4 Spring Enclosed Housing Assembly Right #501-2204 (not shown) & Left #501-2203 (shown)

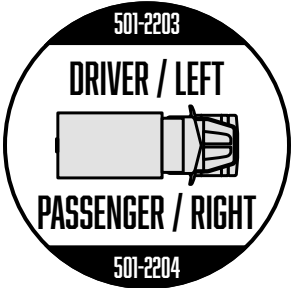

ITEM	PART #	DESCRIPTION	QTY
1	501-1162	Washer 1-7/8" x 1-1/4" Narrow Rim Bushing	2
2	501-2122	UHMW Enclosed Spring End Cap	2
3	501-2210	Enclosed 4 Spring Housing	1
4	501-2242	Steel Adjustable Enclosed 4 Spring Pivot Only	1
5	503-3712	3/8" - 16 x 3" Hex Head Bolt	1
6	504-3702	3/8" - 16 Nyloc Hex Nut Zinc Plt	1
7	506-0101	1-1/4" Snap Ring	2
8	517-9966	Spring, Underbody Arm System	4

REV. 08/27/19 WLH

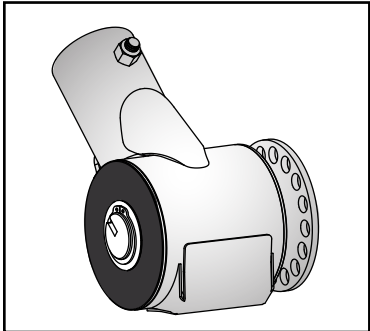

Assembled View of 501-2203

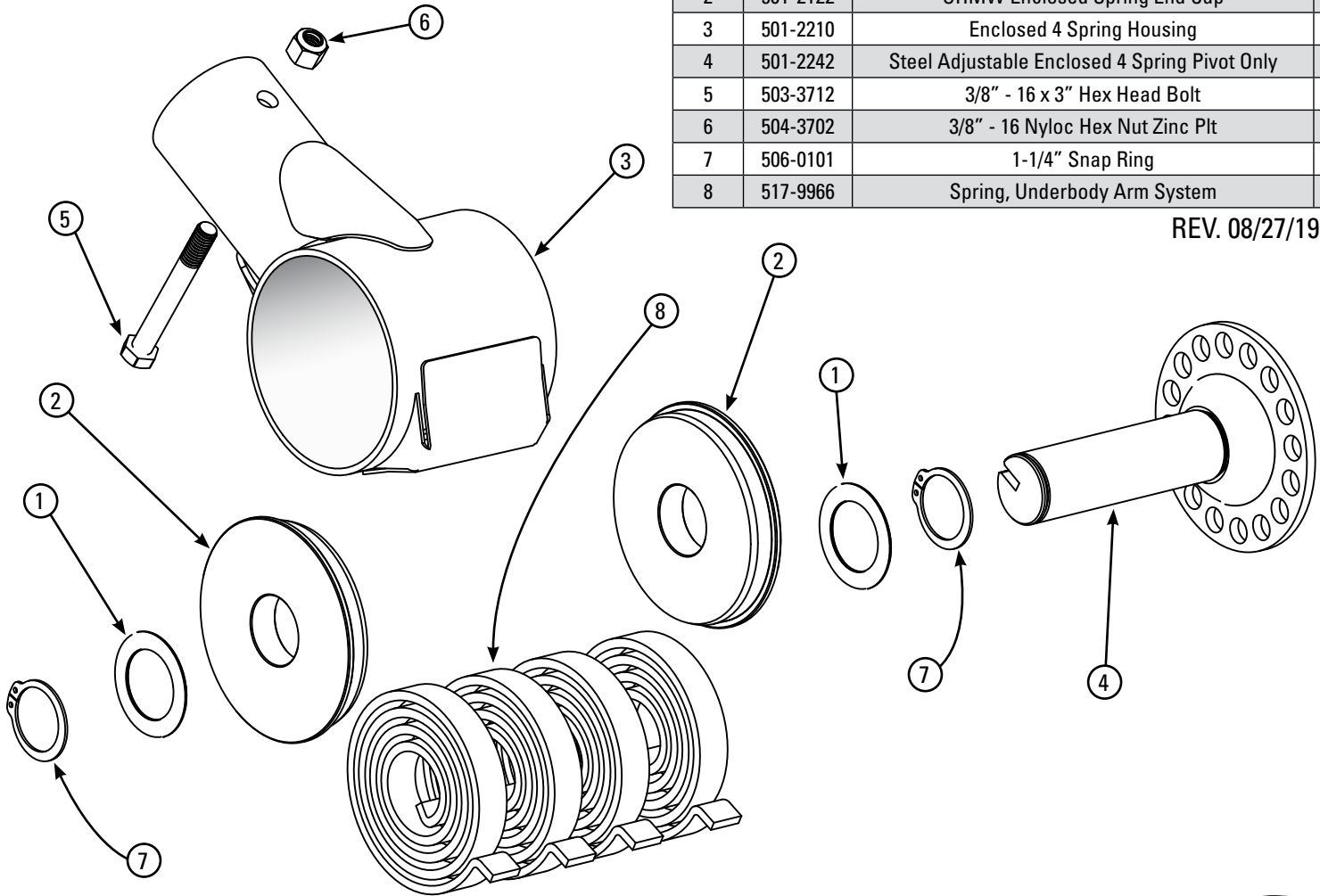



A Roll-Rite Brand



INSTALLATION INSTRUCTIONS

EZ-Mount 4 Spring Enclosed System to 22' (Low & High Mount Applications)

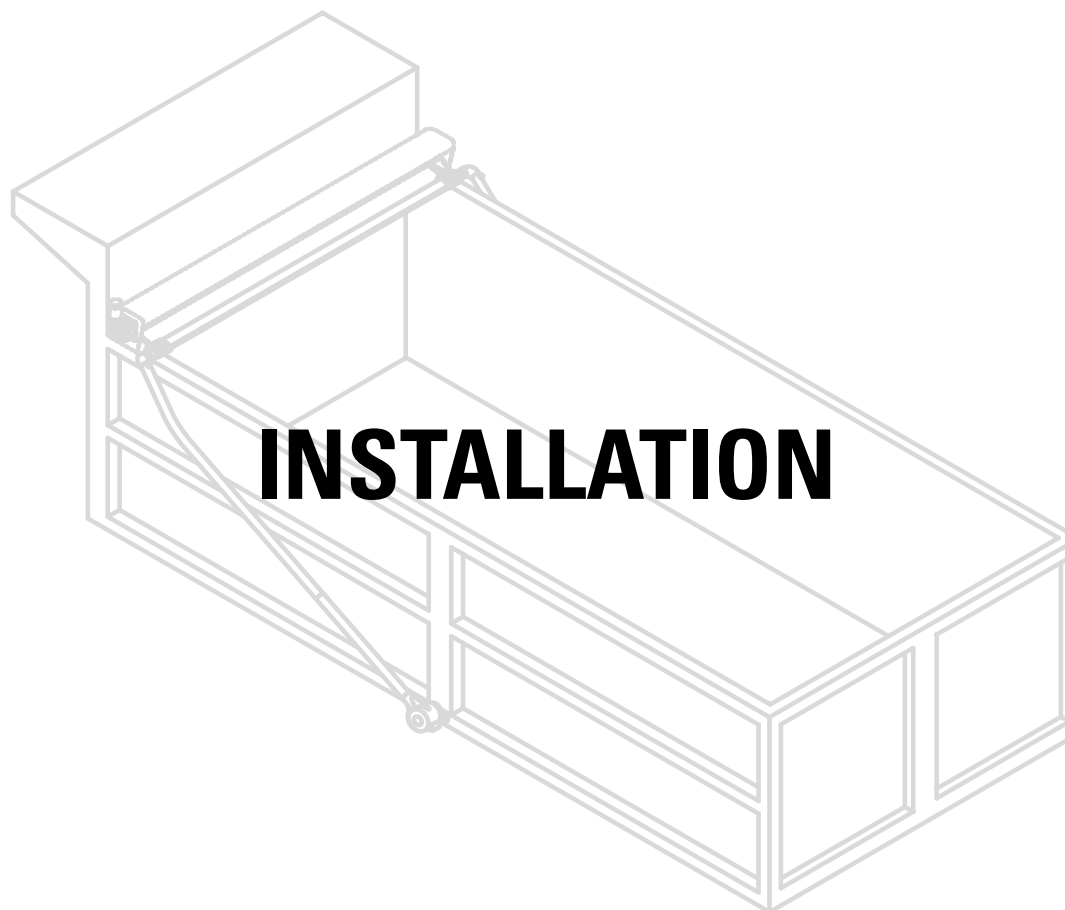



INSTALLATION INSTRUCTIONS

EZ-Mount 4 Spring Enclosed System to 22'(Low & High Mount Applications)

Pivot Points and Mounting Locations (Low Mount)

Step 1: Determining the Pivot Points and Mounting Locations on each side, careful measurement must be taken to insure that the arm and pivot assemblies are mounted square and parallel to the truck or trailer body. Locate the proper mounting positions by determining Point "A" and Point "B" and insuring measurement "D" and "E" are equal (Fig. 1). Point "C" must be located as low as possible and be the same on both sides.

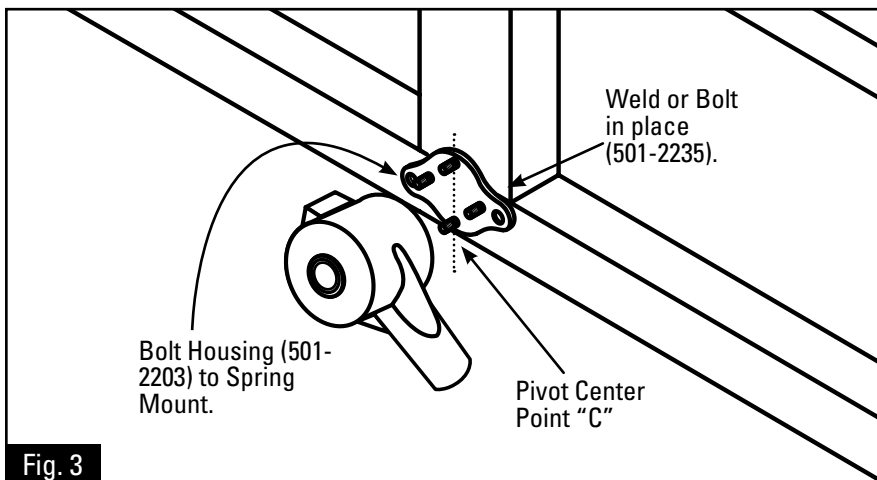
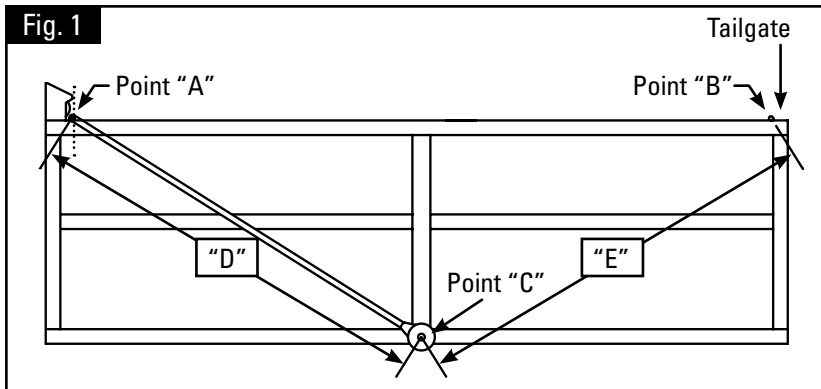

Step 2 - Arm Preload: Install Arm and Pivot assemblies with Arm indexed (Fig. 2). Arms must be indexed with no spring load on pivots. Index Arm at 180 degrees of travel from the Roller Mechanism for proper preload of the spring. The dotted lines represent proper 180 degree preload position for applications with Bent Arms. Mark pivot pin location on box.

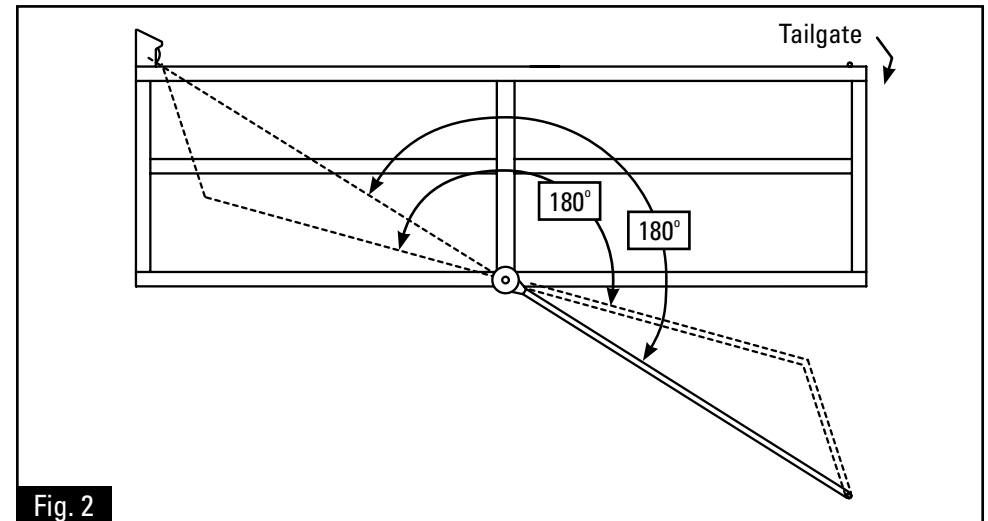

Step 3 - Mounting the Pivot Mount:

Locate the 4 Spring Housing with marks made in Step 5. Weld the Spring Mounting in place and then bolt on the Spring Housing 180° from Housing Location (Fig. 3).

Note: Applies to Lower Mounting.



INSTALLATION INSTRUCTIONS

EZ-Mount 4 Spring Enclosed System to 22'(Low & High Mount Applications)

Pivot Points and Mounting Locations (High Mount)

Step 4: Careful measurements must be taken to insure that the arm and pivot assemblies are mounted square and parallel to the truck or trailer body. Locate the proper mounting positions by determining Point "A" and Point "B" and insuring measurement "D" and "E" are equal (Fig. 4). The pivot "C" should be 1/2 way between Point "A" and Point "B" and 7" below the top rail on both sides (Fig. 5).

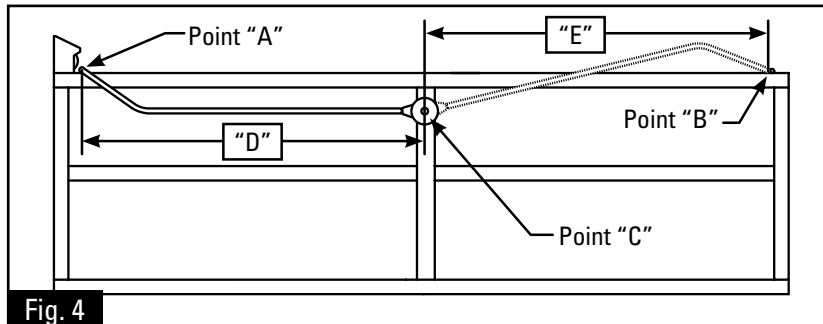

Fig. 4

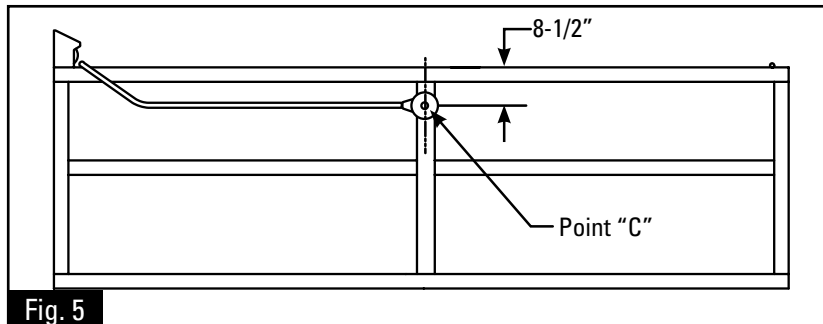

Fig. 5

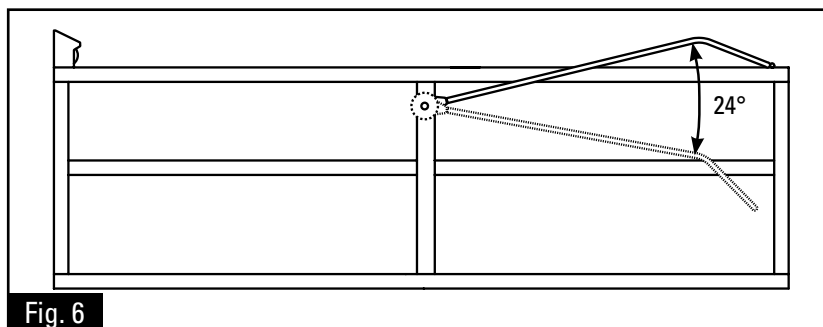

Fig. 6

Step 5 - Arm Preload:

Arm must be indexed with no load at 24 degrees to top rail for proper preload of springs (Fig. 6).

Step 6 - Setting the Index for EZ-Mount System (High Mount Only):

Indexing illustrations are for DRIVER SIDE index (Fig. 7A, B, & C).

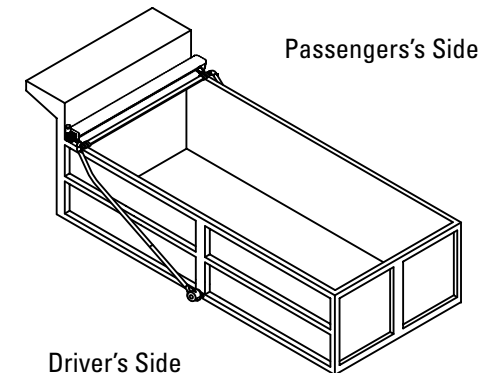
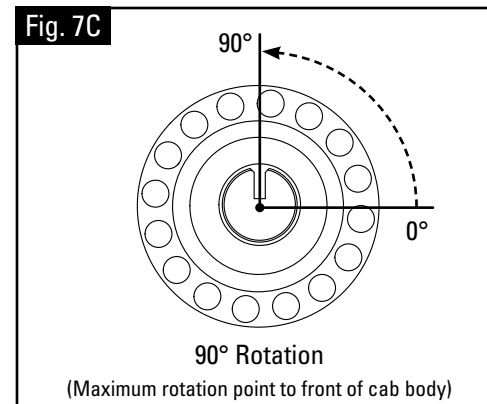
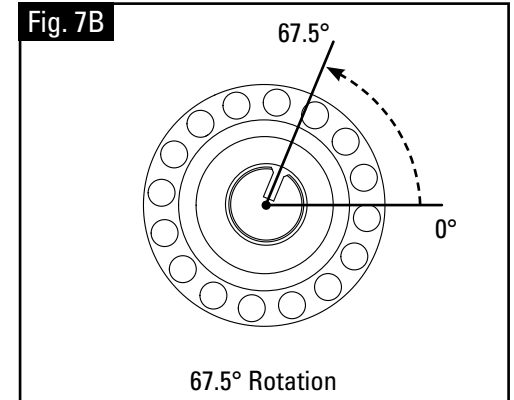
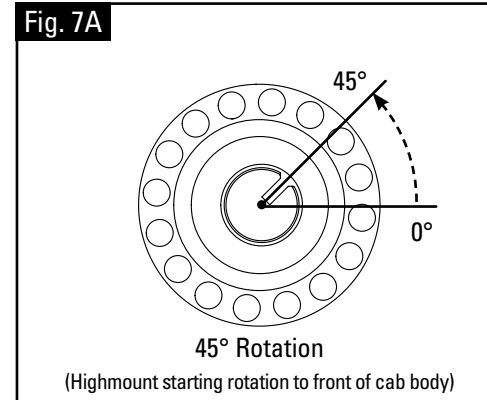



INSTALLATION INSTRUCTIONS

EZ-Mount 4 Spring Enclosed System to 22'(Low & High Mount Applications)

Arm Alignment, Tarp and Pullbar Installation

Fig. 8

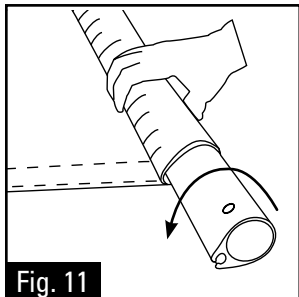
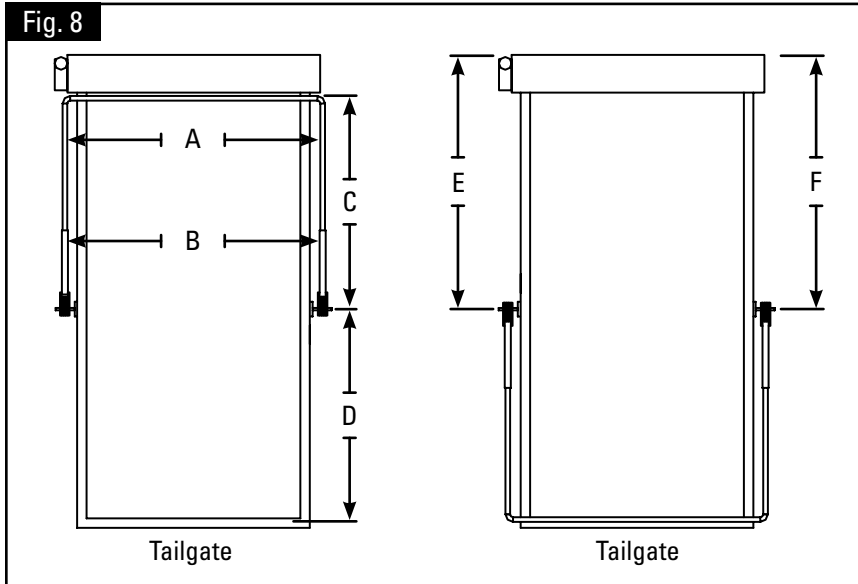

Fig. 11

Step 10 - Installing The Pullbar:
Cut the pullbar to length making sure the arms remain parallel and square to the body.

Slide the tarp into groove in the pullbar and center the tarp.

Roll the tarp up on the pullbar two revolutions (Fig. 11).

Fig. 12

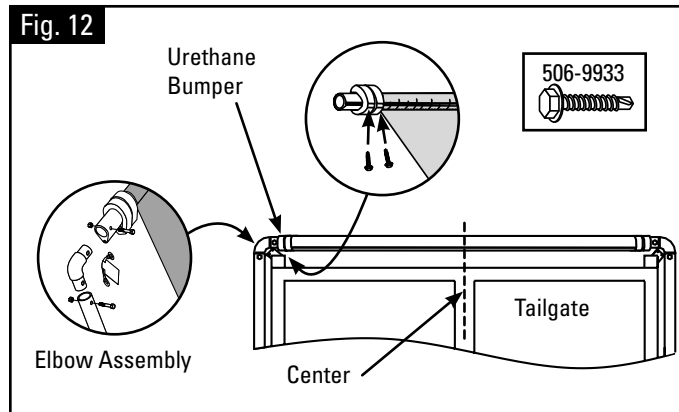

Step 11: Fasten the tarp in place by sliding the two urethane bumpers on to the pullbar far enough to touch the edges of the tarp. Lock in place by installing a 1-1/2" long (506-9933) self drilling screw through the bumper and into the hem tube groove of the pullbar (Fig. 12).

For elbows, use the long bolts provided in the kit, when deployed to catch the rope on flap tarps. Install tether onto elbows as shown.

Step 7 - Correct Alignment of arm to truck:

Arms and pivots must be square and parallel to truck (Fig. 8).

(Dimension "A" must equal "B" - Dimension "C" must equal "D" - Dimension "E" must equal "F")

Fig. 9

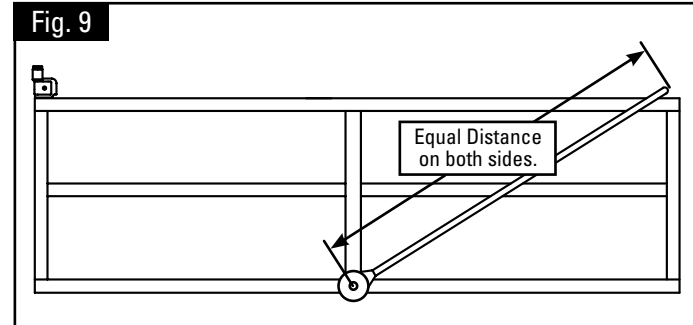

Step 8: Adjust the Arms on both sides to be the same length (Fig.9).

Fig. 10

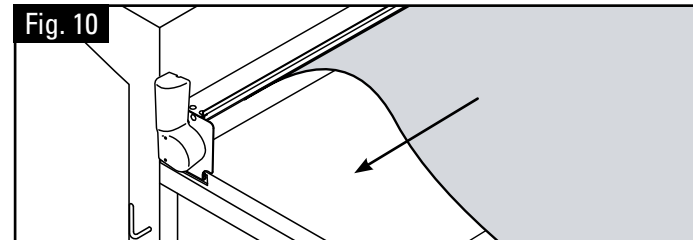

Step 9 - Tarp Installation:
Slide Tarp into Groove on roller tube and center (Fig. 10).

Note: Tarp must be retracted when dumping.



INSTALLATION INSTRUCTIONS

EZ-Mount 4 Spring Enclosed System to 22'(Low & High Mount Applications)

Quick Disconnect Plug Assembly

Step 12: Assemble the Quick Disconnect (Fig. 13, 14, & 15).

Option #1, Plug Assembly - Part # 514-0505.

Fig. 13

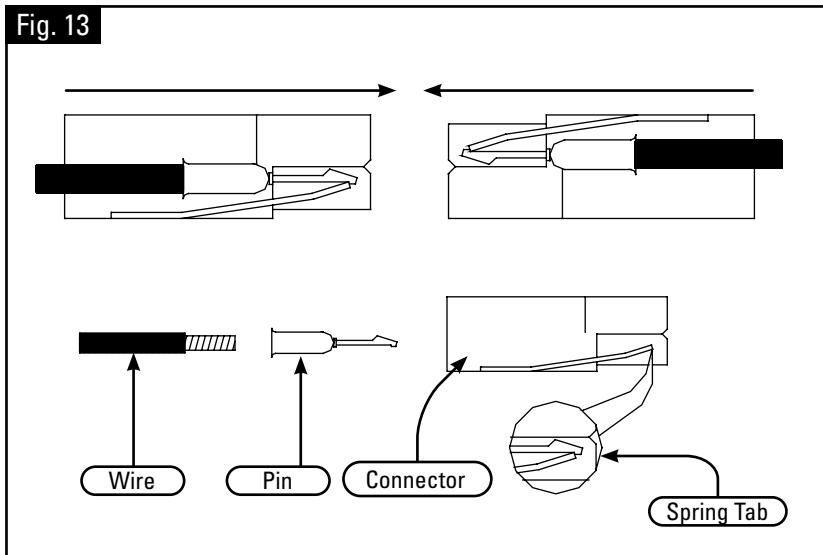
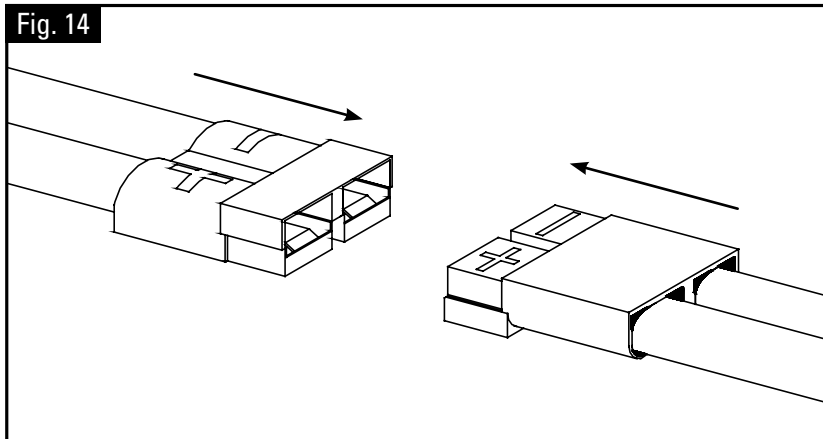
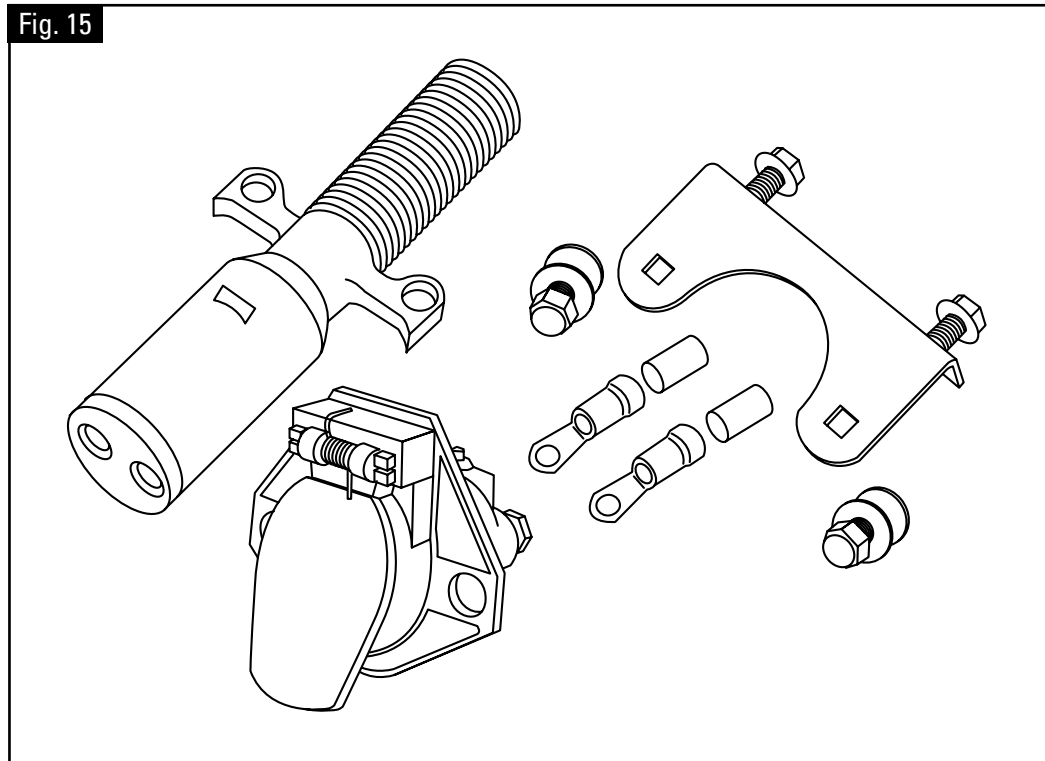

Fig. 14



Option #2, Plug Assembly - Part # 514-0501.

Fig. 15





A Roll-Rite Brand



INSTALLATION INSTRUCTIONS

EZ-Mount 4 Spring Enclosed System to 22'(Low & High Mount Applications)

FLAP TARP, ROPE & HOOK INSTALLATION





INSTALLATION INSTRUCTIONS

EZ-Mount 4 Spring Enclosed System to 22' (Low & High Mount Applications)

Optional Flap Tarp, Rope and Hook Installation

Parts:

Tie Down Hooks (Steel or Alum.)

Pull Down Hook

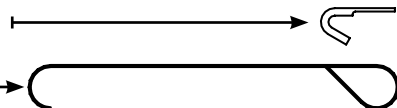

Note: The Location Of The Tie Down Hooks Is Critical!

Step 1: Flip the braided rope over the corner so that the flaps and tie down ropes hang over each side of the box. The number of tie down hooks vary depending on the length of your tarp. One pull down hook is included with your Pulltarp system. If needed. Use the hook to pull the braided rope and flaps over the side of the box.

The tie down hooks must be positioned so that:

1. The tie down rope can be reached from the ground.
2. The bungee cord has to be stretched to reach the last hook (see Step 2 in **Bungee Cord Installation** section).
3. The rope has no slack.
4. The tie down hooks are level with one another.

To ensure proper hook placement, first duct tape the rope to the box in place of the tie down hooks. Start with hook closest to the cab.

1. Position the first hook 6" (15.24cm) down and 12" (30.48cm) forward (toward the cab) from the first grommet (Fig. 16).
2. Position 2nd hook straight down from 1st grommet. This hook should be reached from ground (Fig. 17).
3. Place middle hooks equal distances from grommet (Fig. 18). These hooks should be placed at the same height as the second hook.
4. Position last hook (closest to the tailgate) below the last grommet at the same height as the others (Fig. 19A & B).
5. Weld hooks in place.

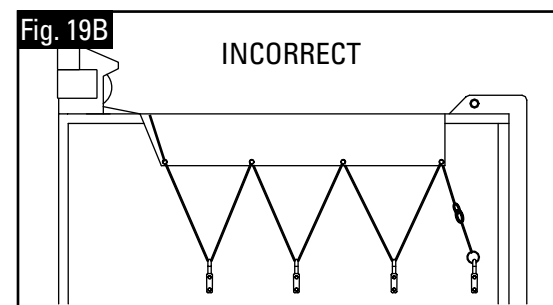
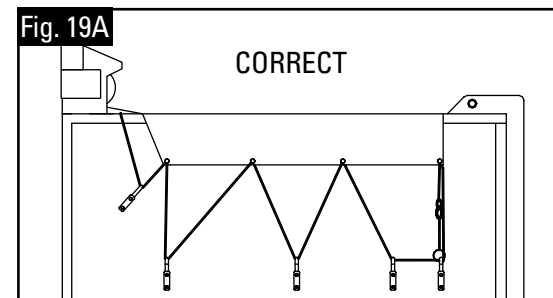
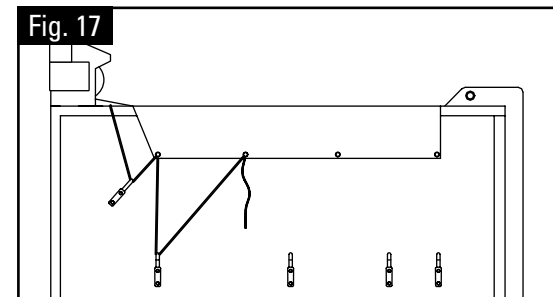
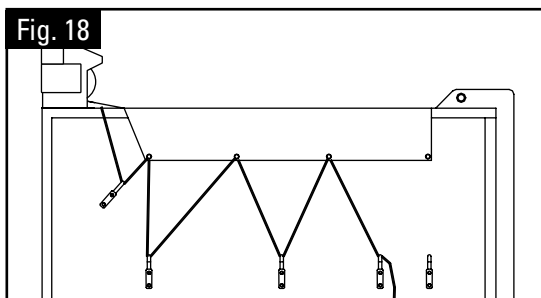
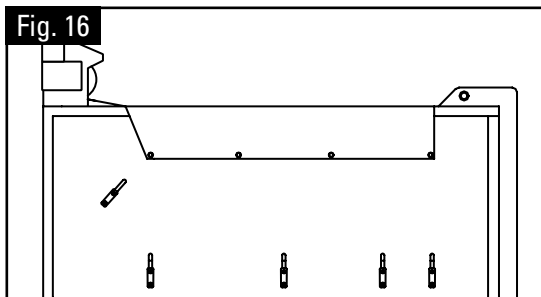



INSTALLATION INSTRUCTIONS

EZ-Mount 4 Spring Enclosed System to 22'(Low & High Mount Applications)

Bungee Cord Installation

Parts:

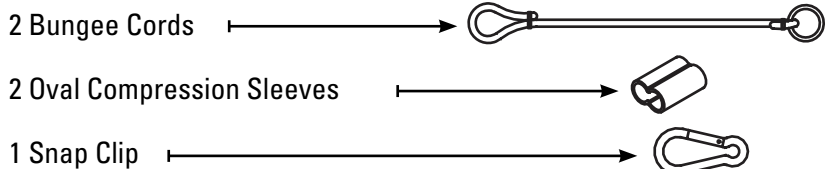

Step 2: After side hooks are installed, the tie down rope must be installed and cut to proper length. It is important to get all of the slack out of the rope to prevent blowing and rubbing of flaps in windy conditions.

Tarps with Side Flaps

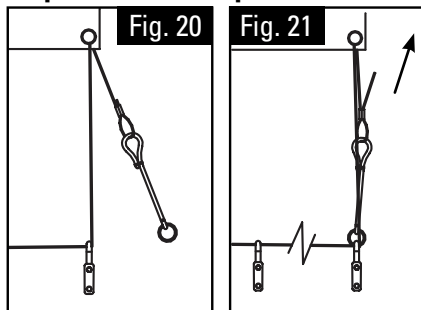

To tighten, pull loose end of rope through the Oval Compression Sleeve (Fig. 20). Stretch the bungee cord making sure all slack is taken out of the rope, crimp compression sleeve (Fig. 21). Be sure to keep flaps even on sides so Tie Down Ropes remain equal in length.

Note: Check for proper placement of rope through the last two hooks.

Snap Clip Installation

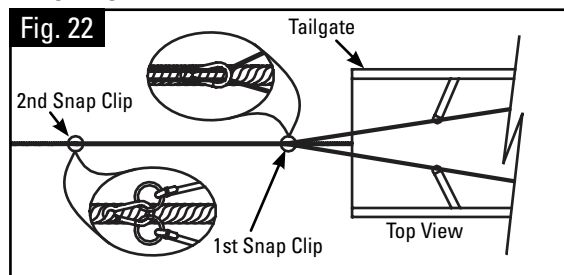

Flip the rope back on top of the tarp, making sure to hold the bungee at all times. The first snap clip is factory installed 5'-6" from the pullrod. Open the clip and enclose the rope. Weave the second clip through the main pullrope where the ends of the bungee cords meet the main pullrope. Make sure the rope is taught when clipped (Fig. 22).

Note: First snap clip should not be used on long wheel base belly dumps.

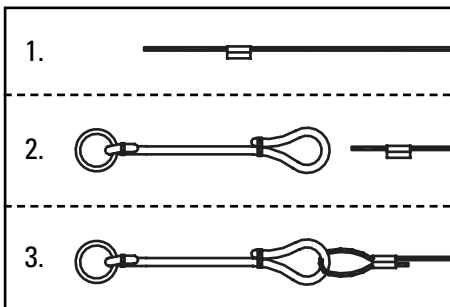

Connect Bungee Cord to Rope

1. Thread braided rope through Oval Compression Sleeve.
2. Feed rope through the eye of the bungee cord.
3. Thread the rope back through the oval compression sleeve. Adjust for proper length. Crimp compression sleeve.

Excess Rope

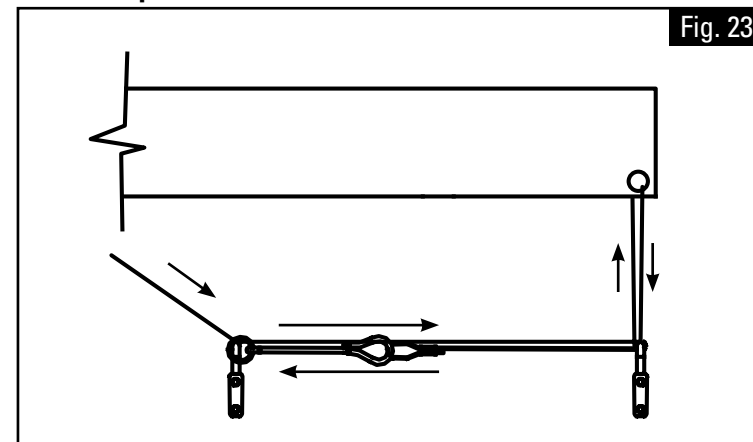

You may need extra rope to keep the side flap system ground operated. If your application requires extra rope, the slack needs to be taken up by taching the end of the bungee cord to an alternate hook (Fig. 23).



INSTALLATION INSTRUCTIONS

EZ-Mount 4 Spring Enclosed System to 22'(Low & High Mount Applications)

Flap, Rope and Rope Hook Placement

Step 3 - Flap / Tie Down Rope Placement and Installation (Fig. 24).

Fig. 24

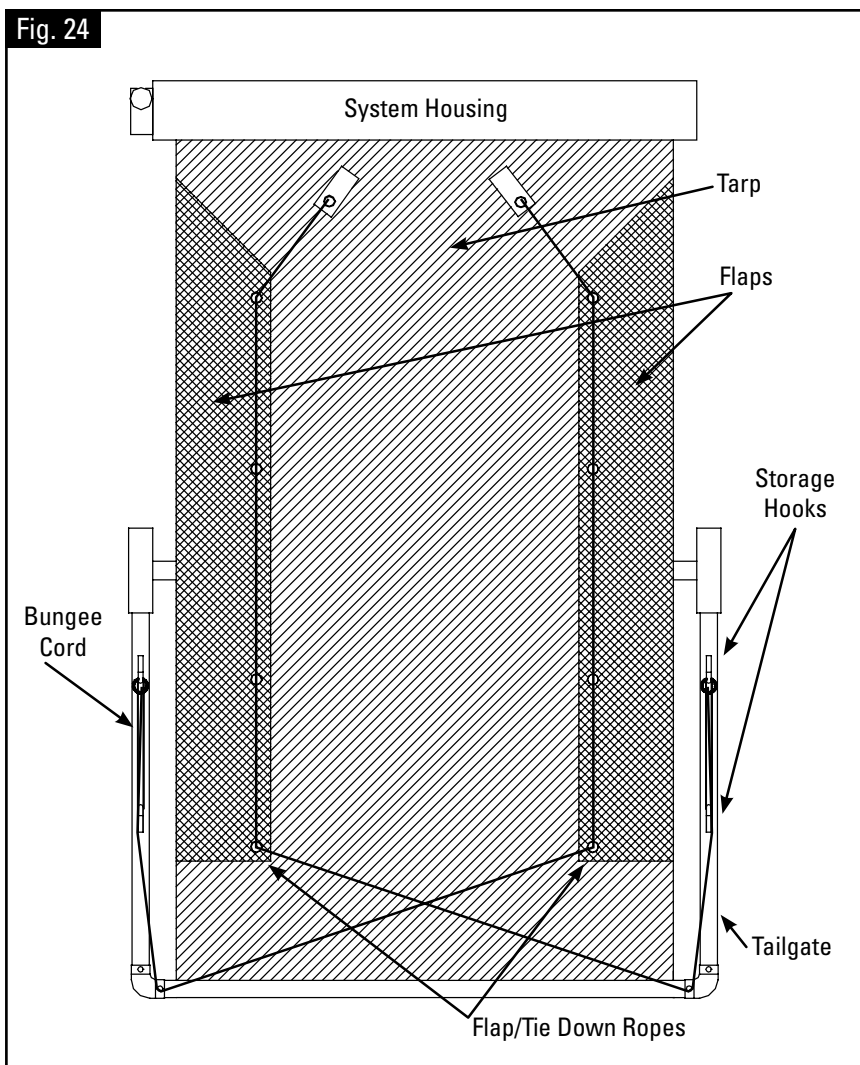
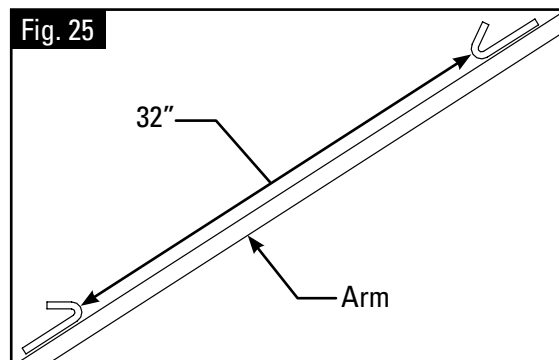
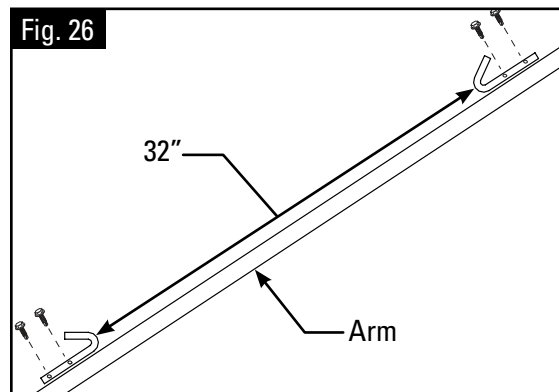

Fig. 25



Step 4 - Rope Hook Placement: Weld rope storage hook on the top of the arms approx. 32" apart (Fig. 25).

Fig. 26



Step 5 - Rope Hook Placement For Aluminum Arms: Use Self Drilling screws (part #506-9933) to install hooks (Fig. 26).

Fig. 27

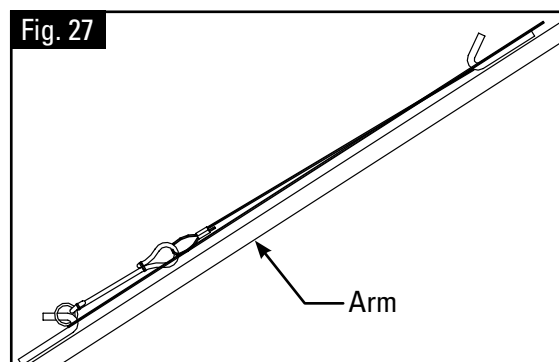

Step 6 - Rope storage on Arms (Fig. 27).