



1404 N. Marshall Ave. El Cajon CA. 92020

Demonstration Rack Installation Instructions

501-0682



607-0148

WLH 02/20/18

For technical support call us at (877) 861-6265 or visit our website at Pulltarps.com.



1404 N. Marshall Ave. El Cajon CA. 92020

Demonstration Rack Installation Instructions

TABLE OF CONTENTS

Assembly

Assemble Display Mounting Base & Vertical Mounts.....	1
Assembling Demo Shelf Supports & Display Cross Braces.	2
Attach Display Pivot Display Shelf & Housings.....	3-4
Mounting the EZ Mount Brackets.....	5
Mounting the Display Pivots.....	6
Attaching Tarps to the Housings.....	7-8

Parts

Display Rack #501-1901.....	9
Display Housings & Pivots #501-1900.....	10
Display Rack Parts & Tools Required #501-0682.....	11



1404 N. Marshall Ave. El Cajon CA. 92020

Demonstration Rack Installation Instructions

Assemble Display Mounting Base & Vertical Mounts



Step 1: With the Display Mounting Base raised off the ground (use wood blocks), place the Display Mounting Brackets on each corner and align holes (Fig. 1).

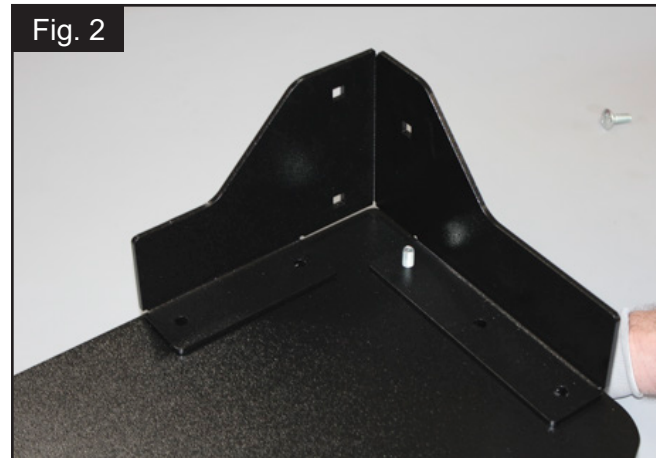

Step 2: Insert the 1" carriage bolts into the holes from below (Fig. 2). Place the 3/8" washer and 3/8" hex nut onto the bolts and hand tighten (Fig. 3). Repeat on other side.



NOTE: Hand tighten all nuts and bolts until unit is fully assembled.

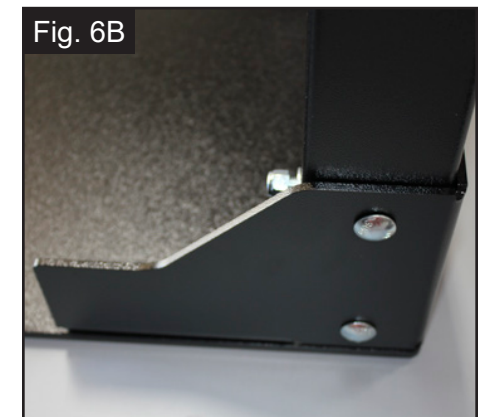
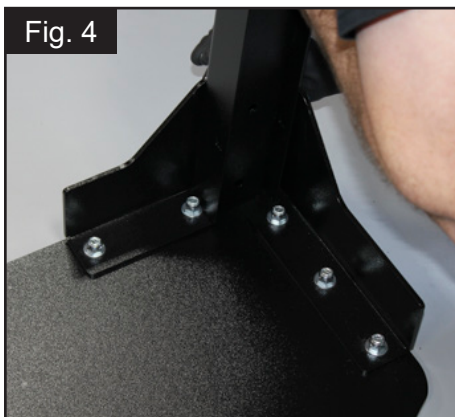

Step 3: With both Display Mounting Base parts secure and the wooden blocks removed from underneath (Display Mounting Base), attach one of two of the Display Vertical Mounts (Fig. 4). Secure with a 3-3/4" carriage bolt, 3/8" washer and 3/8" hex nut (Fig. 5) and do the same on the other side. Once secure, attached the four (4) 2" carriage bolts, 3/8" washers and 3/8" hex nuts (Fig 6A & B).

Assembling Demo Shelf Supports & Display Cross Braces

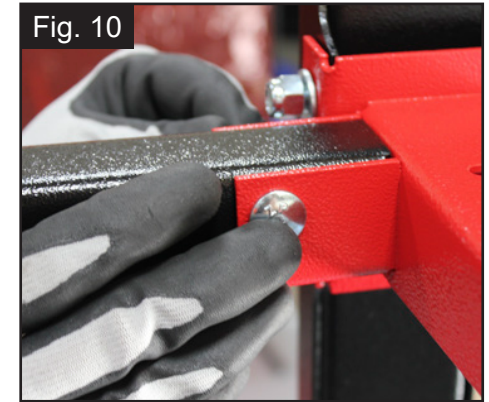
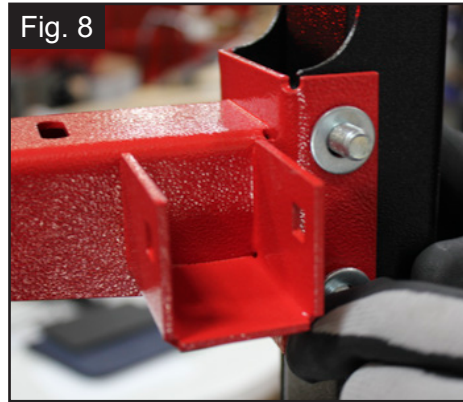
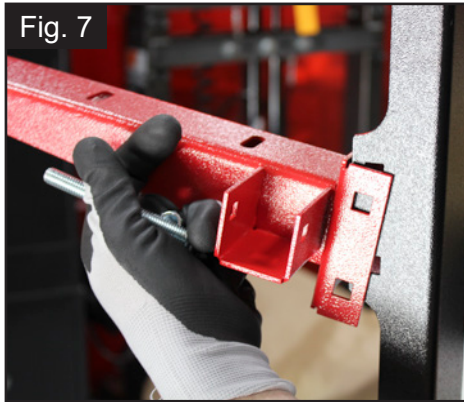

Step 4: Starting at the top and working your way down, mount the Demo Shelf Supports (A, B & C).

Place Demo Support “A” on the raised flange on the Vertical Mounts (Fig. 7). Insert the 3-3/4” carriage bolts, from the outside. Attached the 3/8” washer and 3/8” hex nut (Fig. 8). Insert the first Display Cross Brace. Lightly tap into place with hand or rubber mallet (Fig. 9). Secure with 2” carriage bolts, 5/16” washers and 5/16” nylock nuts (Fig. 10).

NOTE: Hand tighten bolts and nuts.



Step 5: Place the Demo Shelf Supports “A” on the raised flange, 2nd from the top (Fig. 11A). Repeat the process securing Shelf Supports to Vertical Mounts and adding Display Cross Braces (Fig. 11B).

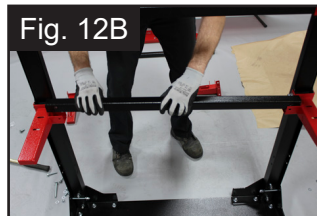

Step 6: Place Demo Shelf Supports “B” on the third raised flange and repeat the process of securing to Vertical Mounts (Fig. 12A). Repeat the process of adding the Cross Braces (Fig. 12B).



Step 7: Place the Demo Shelf Supports “D” on the bottom flange and repeat the process of securing to the Vertical Mounts (Fig. 13A). Repeat the process of adding the Cross Braces (Fig. 13B).



1404 N. Marshall Ave. El Cajon CA. 92020

Demonstration Rack Installation Instructions

Attach Display Pivot Display Shelf & Housings



Fig. 14

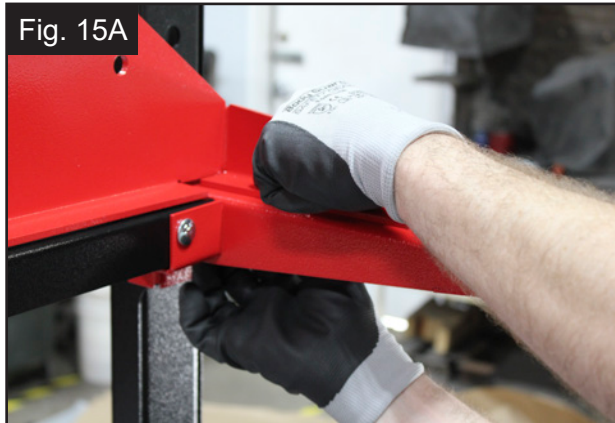

Fig. 15A

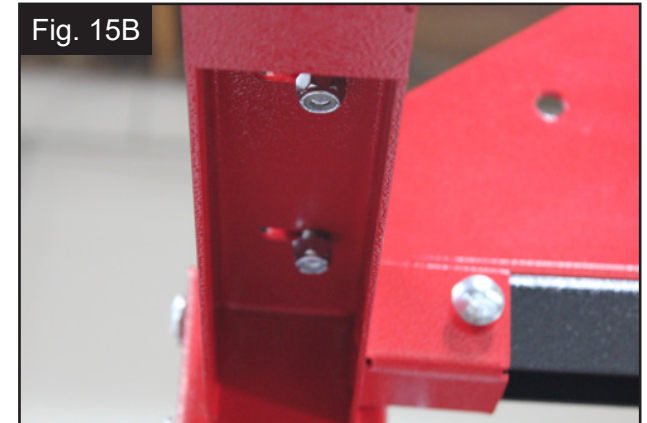

Fig. 15B

Step 8: Starting at the top and working your way down, mount the Pivot Display Shelf & Housing Systems.

Place the Pivot Display Shelf on the top Demo Shelf Supports "A" and make sure Pivot Display is centered (Fig. 14). Secure with four (4) 3/4" carriage bolts and four (4) 5/16" nylock nuts (Fig. 15A & B).



Fig. 16



Fig. 17A



Fig. 17B

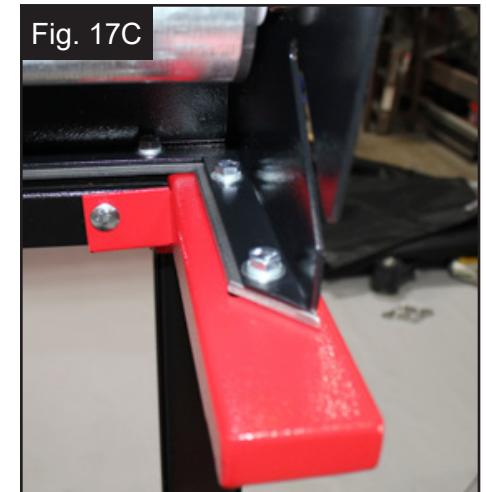

Fig. 17C

Step 9: On the next Demo Shelf Supports "A", place the SuperShield 9500 M-Series housing (Fig. 16). Secure with the preinstalled bolts and nuts (Fig. 17A-C).

NOTE: You will need to remove the preinstalled nuts on the SuperShield mounting bolts to mount on the Demo Shelf Supports.

Attach Display Pivot Display Shelf & Housings



Fig. 18



Fig. 19A



Fig. 19B

Step 10: On Demo Shelf Support “B” place the X-Pando housing (Fig. 18). Secure with the supplied nuts (Fig. 19A & B).

NOTE: You will need to remove the preinstalled nuts on the X-Pando mounting bolts to mount on the Demo Shelf Supports.

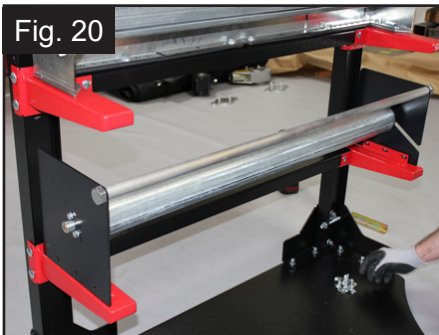

Fig. 20

Step 11: Place the 9” Open housing on the final set of Display Mounting Supports “C” and position so holes match. Loosely secure with bolt and nuts on each side until crossbar length can be verified (Fig. 20).



Fig. 22A



Fig. 22B

Step 12: Hand tighten housing to Demo Shelf Supports using included carriage bolts and nuts. (Fig 22A & B).



Fig. 21

NOTE: When installing the 9” Open System, it may come with mounting brackets installed (Fig. 21). You will need to remove the bracket before mounting.



Fig. 23A

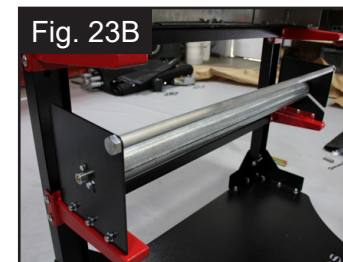

Fig. 23B

NOTE: If the 9” Open’s crossbar is 40” in length, then cut to 39-3/4” to get the best fit. Cut an 1/8” of each side to get appropriate length. Reattached the crossbar once completed. (Fig. 23A & B)



1404 N. Marshall Ave. El Cajon CA. 92020

Demonstration Rack Installation Instructions

Mounting the EZ Mount Brackets

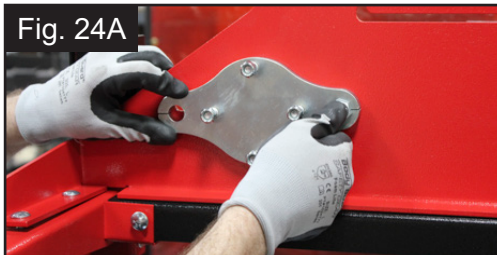

Step 13: Starting on the left side, place the EZ-Mount Brackets over the mounting holes and place the included 1/2" bolts and 1/2" nylock nuts. Tighten fully with wrench or socket. Repeat the steps on the right side (Fig. 24A, B & C).

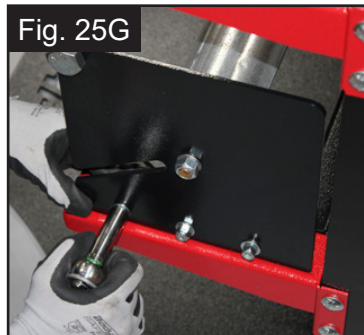
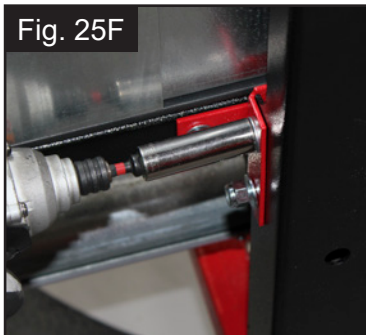
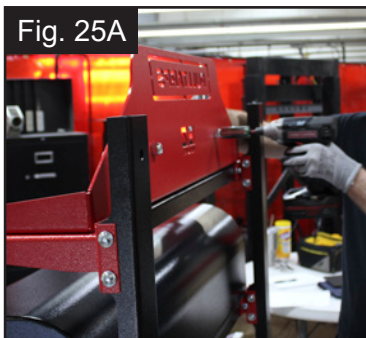

Step 14: Before adding the Display Pivots to the Display, begin the process of tightening all installed bolts, washers and nuts. Start at the top and work your way down (Fig. 25A-J).

Mounting the Display Pivots



Step 15: Before mounting the pivots, remove the nylock nuts that come with the EZ-Mount brackets. Once the nuts are removed, place the first pivot on the display (Fig. 26).

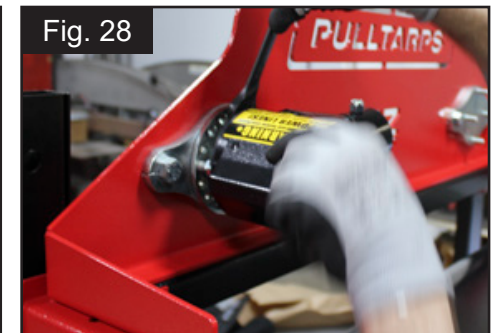

Step 16: Take the 4 Spring Enclosed Pivot and place on EZ-Mount bracket. Position the pivot arm socket facing upward at an approximate 30°- 45° angle (Fig. 27). Secure with nylock nuts (Fig. 28).

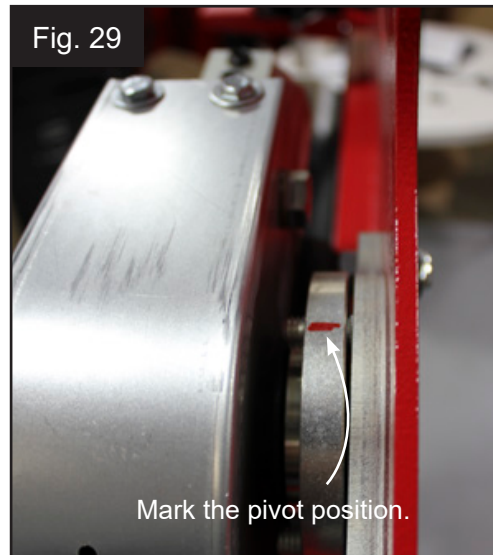

Step 17: Before attaching the Single Spring Pivot to the EZ-Mount bracket, you need to mark the angle of the pivot. In order to get the proper mounting position, place the pivot on the EZ-Mount bracket at an approximate 30°- 45° angle, facing upward, then mark the position at the top of the bracket (Fig. 29).



Step 18: Now that you have the angle marked, remove from EZ-Mount bracket and disassemble the pivot. (Fig. 30).



Step 19: Remove the nylock nut on the Single Spring pivot cover. Slide the Single Spring Cover off of the pivot. (Fig. 31A & B).



Step 20: Attached the Pivot onto the EZ-Mount bracket and secure in place (Fig. 32). Slide the spring housing onto the pivot (Fig 33). Secure the housing onto the pivot with the nylock nut and tighten (Fig 34A-B).

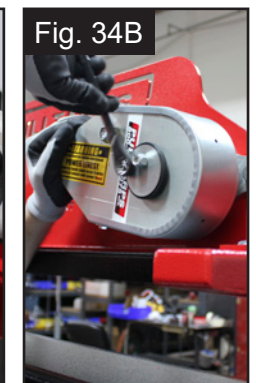

Attaching Tarps to the Housings

NOTE: When installing tarps, the Pulltarps logo on the tarps needs to face up.



Step 21: Starting with the SuperShield, remove the 3/4" ratchet bolt and ratchet lock. With those removed you can now add spring tension to the roller tube (Fig. 35A & B).

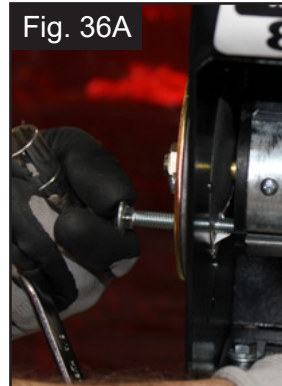

Step 22: Insert a 3/8" bolt (not included) to hold the roller tube in place when adding spring tension (Fig. 36A & B).

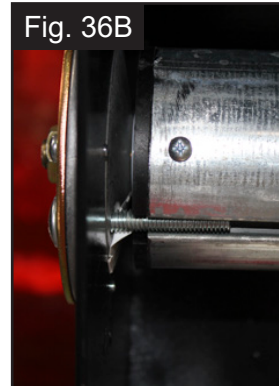

Step 23: Using a socket wrench, turn the ratchet counter clockwise 10 rotations (Fig. 37).



Step 24: With 3/8" bolt still in place, using the Super Mesh Tarp, insert the side with the hemtube into the roller tube slot (Fig. 38). Slide all the way until it reaches the 3/8" bolt (Fig. 39).

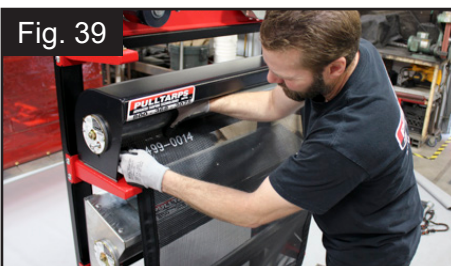

NOTE: Be careful not to push the 3/8" bolt out of tube.



Step 25: While holding the rollertube, remove the 3/8" bolt. With someone else holding the tarp, slowly let the tarp retract into housing (Fig. 40).



Step 26: Reinstall the ratchet lock and 3/4" ratchet bolt (Fig. 41).



1404 N. Marshall Ave. El Cajon CA. 92020

Demonstration Rack Installation Instructions

Attaching Tarps to the Housings

NOTE: When installing tarps, the Pulltarps logo on the tarps needs to face up.

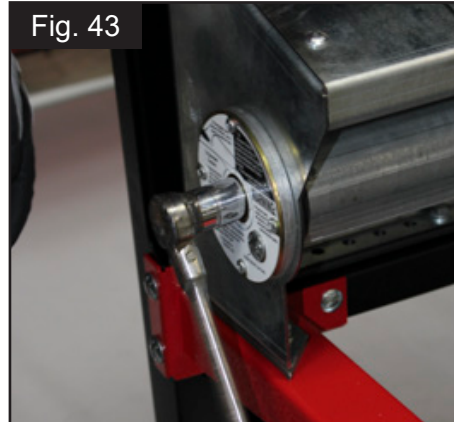

Step 27: For adding spring tension to the X-Pando Housing, repeat the steps for the SuperShield (Fig. 42-45).
NOTE: Use the Vinyl Tarp for the X-Pando.

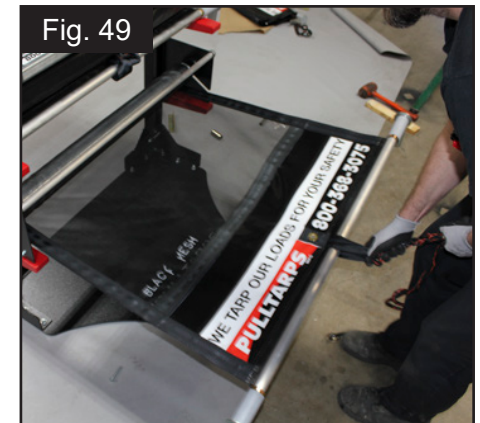
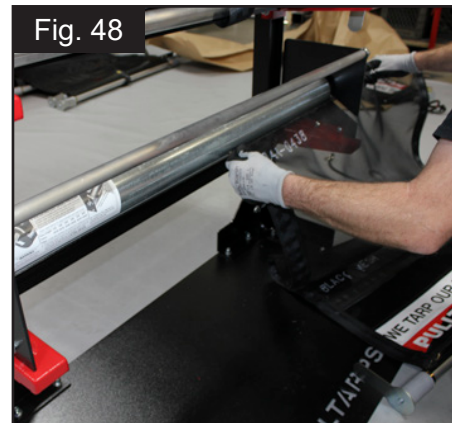

Step 28: To add spring tension to the 9" Open System, you need to wind by hand counter clock wise, with 10 rotations (Fig. 46). Once you've reach the 10 rotation, insert a 3/8" bolt into the roller tube, through the endplate. Hold roller tube in place until the bolt is fully inserted (Fig. 47).

Step 29: Slide the hemtube side of the HD Mesh tarp into the roller tube. Remember to keep the Pulltarps logo facing upward (Fig. 48).

Step 30: With a team member holding the rollertube in place, remove the 3/8" bolt. Now slowly let the tarp retract into the housing. (Fig. 49).



1404 N. Marshall Ave. El Cajon CA. 92020

Demonstration Rack Installation Instructions

Display Rack #501-1901

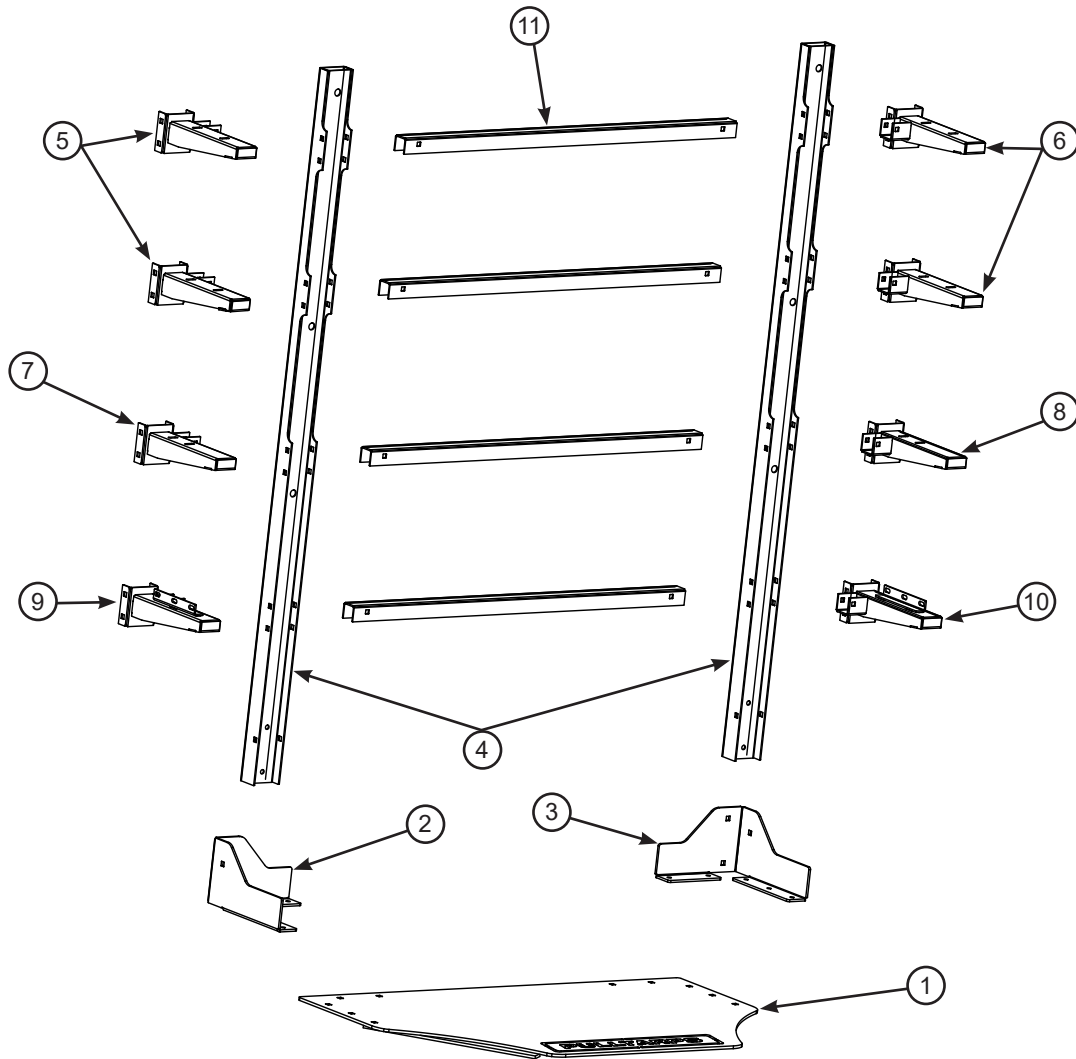

ITEM	PART #	DESCRIPTION	QTY
1	501-1902	Display Mounting Base	1
2	501-1903	Display Mount Bracket (Left)	1
3	501-1904	Display Mount Bracket (Right)	1
4	501-1905	Display Vertical Mounts	2
5	501-1908	Demo Shelf Support "A" (Left)	2
6	501-1909	Demo Shelf Support "A" (Right)	2
7	501-1910	Demo Shelf Support "B" (Left)	1
8	501-1911	Demo Shelf Support "B" (Right)	1
9	501-1912	Demo Shelf Support "C" (Left)	1
10	501-1913	Demo Shelf Support "C" (Right)	1
11	501-1914	Display Cross Brace	4

WLH 02/15/18



1404 N. Marshall Ave. El Cajon CA. 92020

Demonstration Rack Installation Instructions

Display Housings & Pivots #501-1900

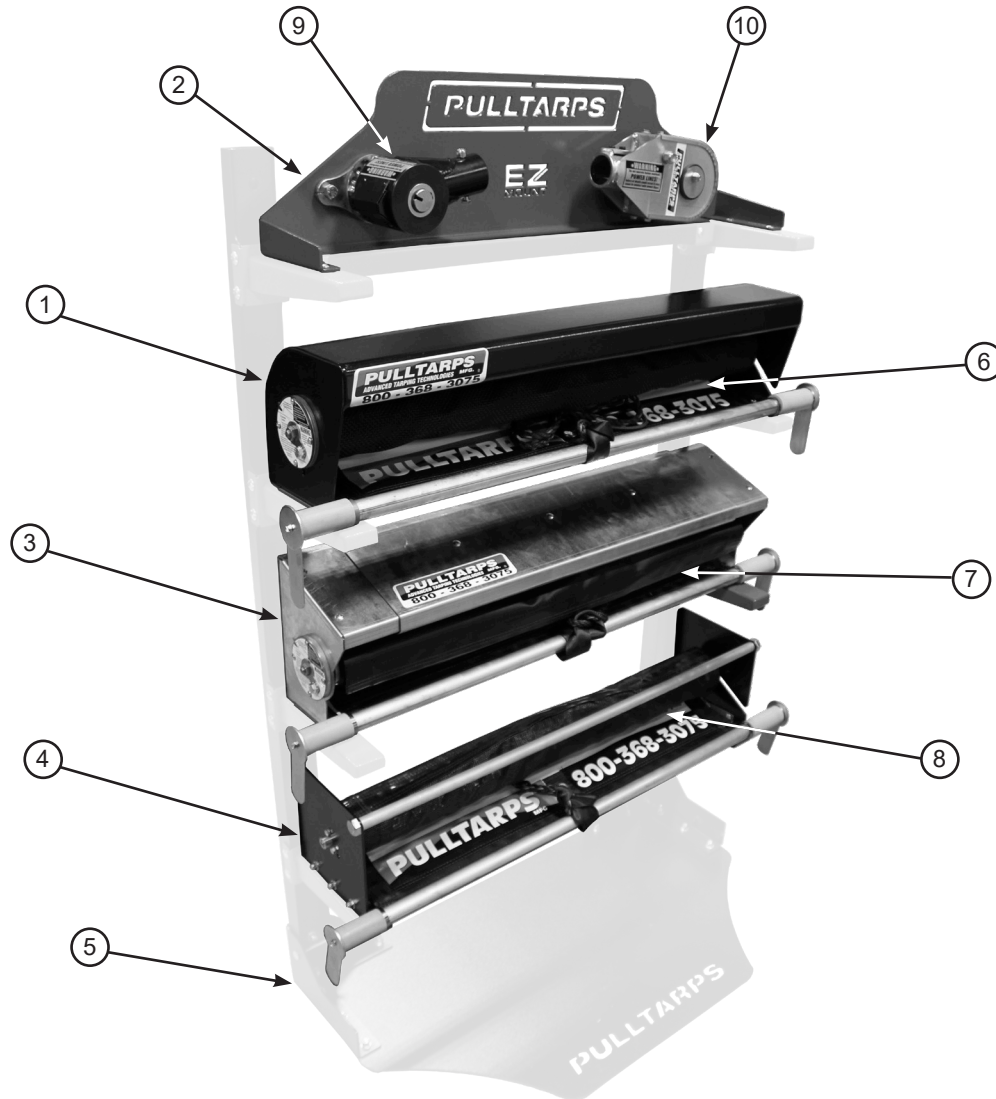

ITEM	PART #	DESCRIPTION	QTY
1	108-4010	SuperShield™ 9500M	1
2	501-1924	Pivot Display Shelf	1
3	116-4010	Mini X-Pando 40"	1
4	105-4010	Open 9000M 40"	1
5	501-1901	Display Rack	1
6	499-0014	4' x 38" Super Mesh Tarp	1
7	711-0438	4' x 38" Vinyl Tarp	1
8	741-0438	4' x 38" Mesh Tarp	1
9	501-2203	4 Spring Enclosed Pivot Housing	1
10	501-1102	Single Spring Pivot Housing	1

WLH 02/16/18



1404 N. Marshall Ave. El Cajon CA. 92020

Demonstration Rack Installation Instructions

Display Rack Hardware #501-0682 & Recommended Tools

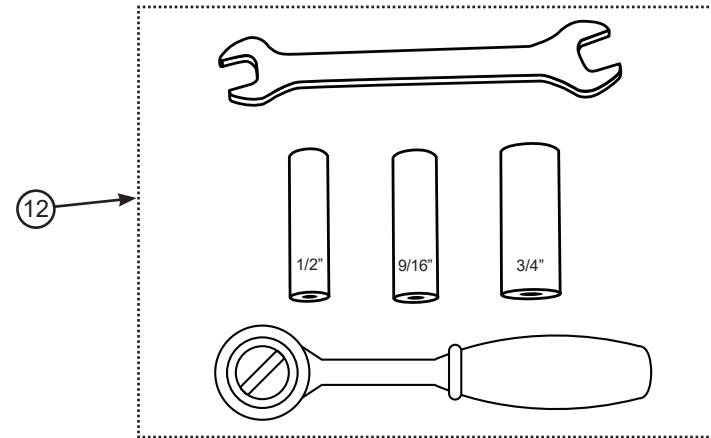
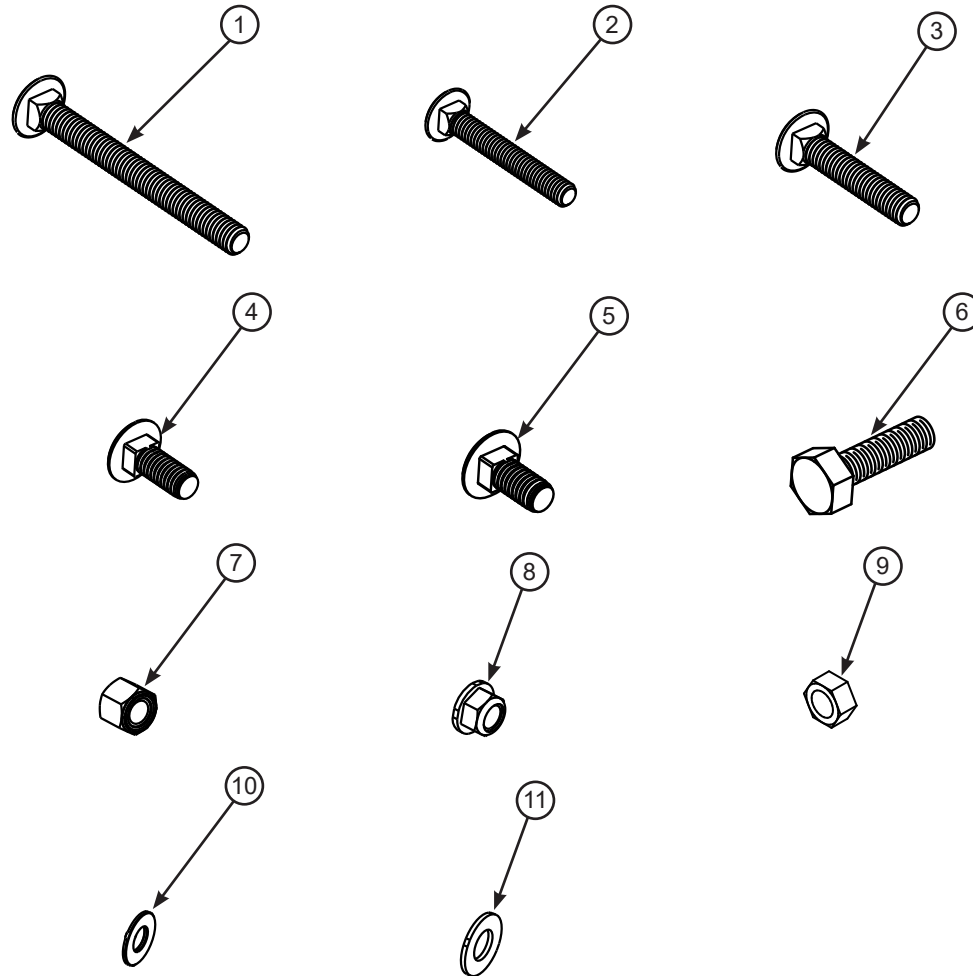

Optional Tools: Power Drill for sockets & Rubber Mallet.

ITEM	PART #	DESCRIPTION	QTY
1	503-3723	3/8" x 3-3/4" Carriage Bolt	18
2	503-3121	Demo Rack 5/16" - 18 x 2-1/4"	8
3	503-3722	3/8" x 2" Carriage Bolt	4
4	503-3720	3/8" - 16 x 1" Carriage Bolt	10
5	503-3104	5/16" - 18 x 3/4" Carriage Bolt	4
6	503-5003	1/2" x 1" USS Bolt	4
7	504-3702	3/8" - 16 Hex Nut	32
8	504-3103	5/16" - 18 Nylock Nut Steel	12
9	504-5004	1/2" - 13 Nylock Nut	4
10	505-3702	Washer 3/8" SAE Flat Zinc	32
11	505-2502	1/4" USS Washer 5/16"	8

ITEM	PART #	TOOLS - DESCRIPTION	QTY
12	--	3/4" Socket or Crescent Wrench	1
--	--	9/16" Socket or Crescent Wrench	1
--	--	1/2" Socket or Crescent Wrench	1

WLH 02/20/18