



INSTALLATION INSTRUCTIONS

Inside Transfer & High Mount Arm Kits

#501-0780, 501-0781, 501-1738 & 501-1799

Related Instructions,
How-To Videos & More



[PDF: Arm Catcher](#)



[PDF: Bolt-On Mounting System](#)



[PDF: Smart Switch Basic Kit](#)



[PDF: High Amp Switch Kit](#)



[Video: Electric Drive Unit Operation](#)

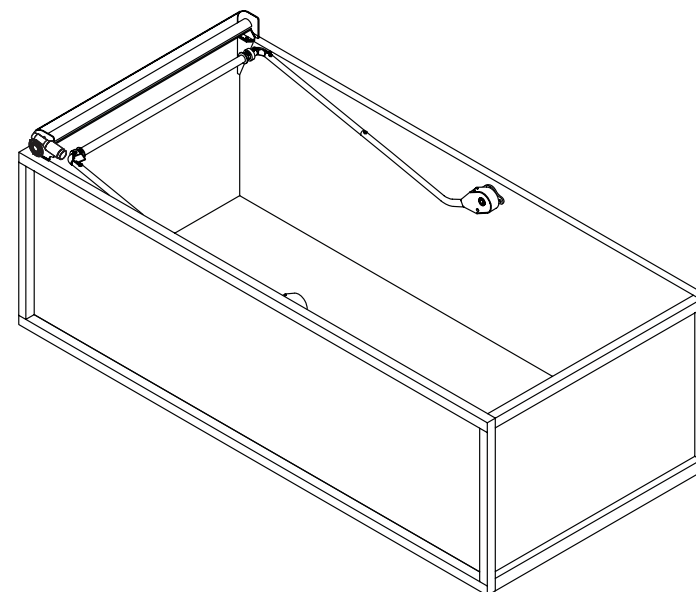
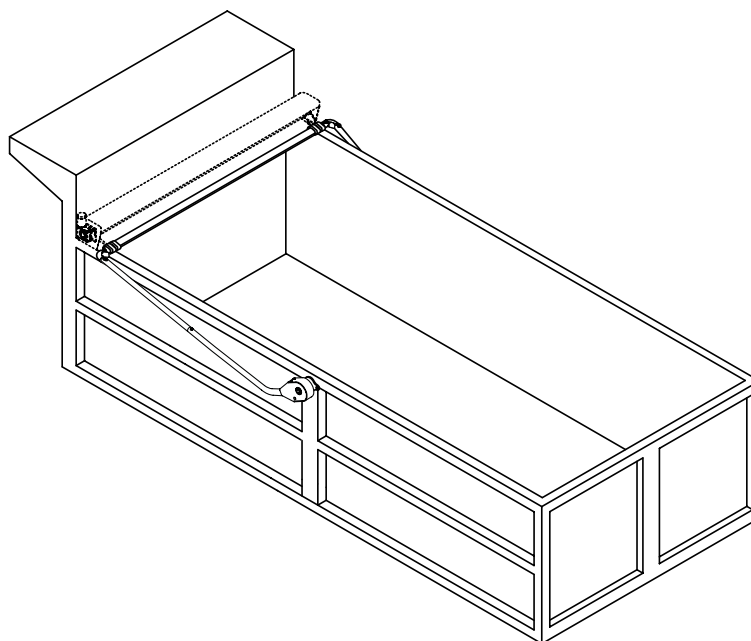

Document #: 607-0109 & 607-0019
Revised: 12/18/25 WLH

DURING INSTALLATION, SOME FABRICATION MAY BE REQUIRED.



A Roll-Rite Brand



INSTALLATION INSTRUCTIONS

Inside Transfer & High Mount Arm Kits

Table of Contents

Tools & Parts

Recommended Tools 2

Rear Transfer Inside Arm System #501-1780..... 3

High Mount Arm System #501-1781..... 4

Installation

Pivot Points and Mounting Locations (Inside Transfer & High Mount) 6

Setting the Index 7

Arm Alignment & Arm Stop 8

Tarp and Pullbar Installation 9

Flat Tarp, Rope & Hook Installation

Optional Flap Tarp, Rope and Hook Installation 11

Bungee Cord Installation 12

Flap, Rope and Rope Hook Placement 13





A Roll-Rite Brand



INSTALLATION INSTRUCTIONS

Inside Transfer & High Mount Arm Kits

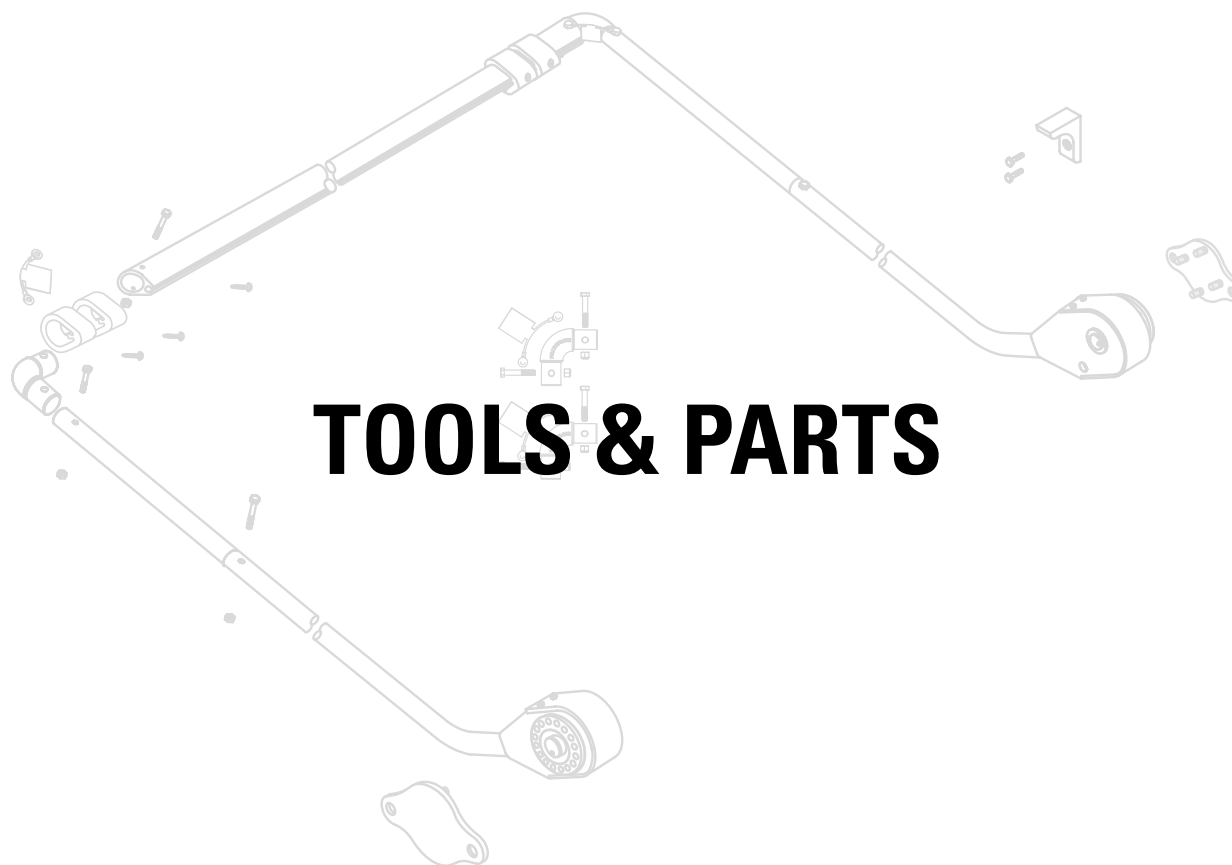

TOOLS & PARTS



A Roll-Rite Brand



INSTALLATION INSTRUCTIONS

Inside Transfer & High Mount Arm Kits

Recommended Tools



Safety Glasses and Gloves



Welding Equipment & Helmet

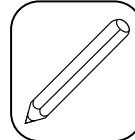

Pencil or Marker

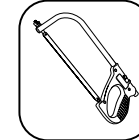

Hacksaw



Tape Measure



Adjustable Wrench



Rubber Mallet

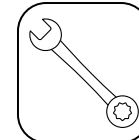

3/4" Box Wrench



Socket Wrench

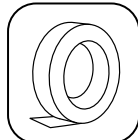

Masking Tape

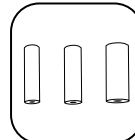

Socket Set

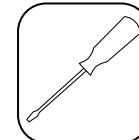

Flathead Screwdriver



Impact Drill (Optional)



INSTALLATION INSTRUCTIONS

Inside Transfer & High Mount Arm Kits

Rear Transfer Inside Arm System #501-1780

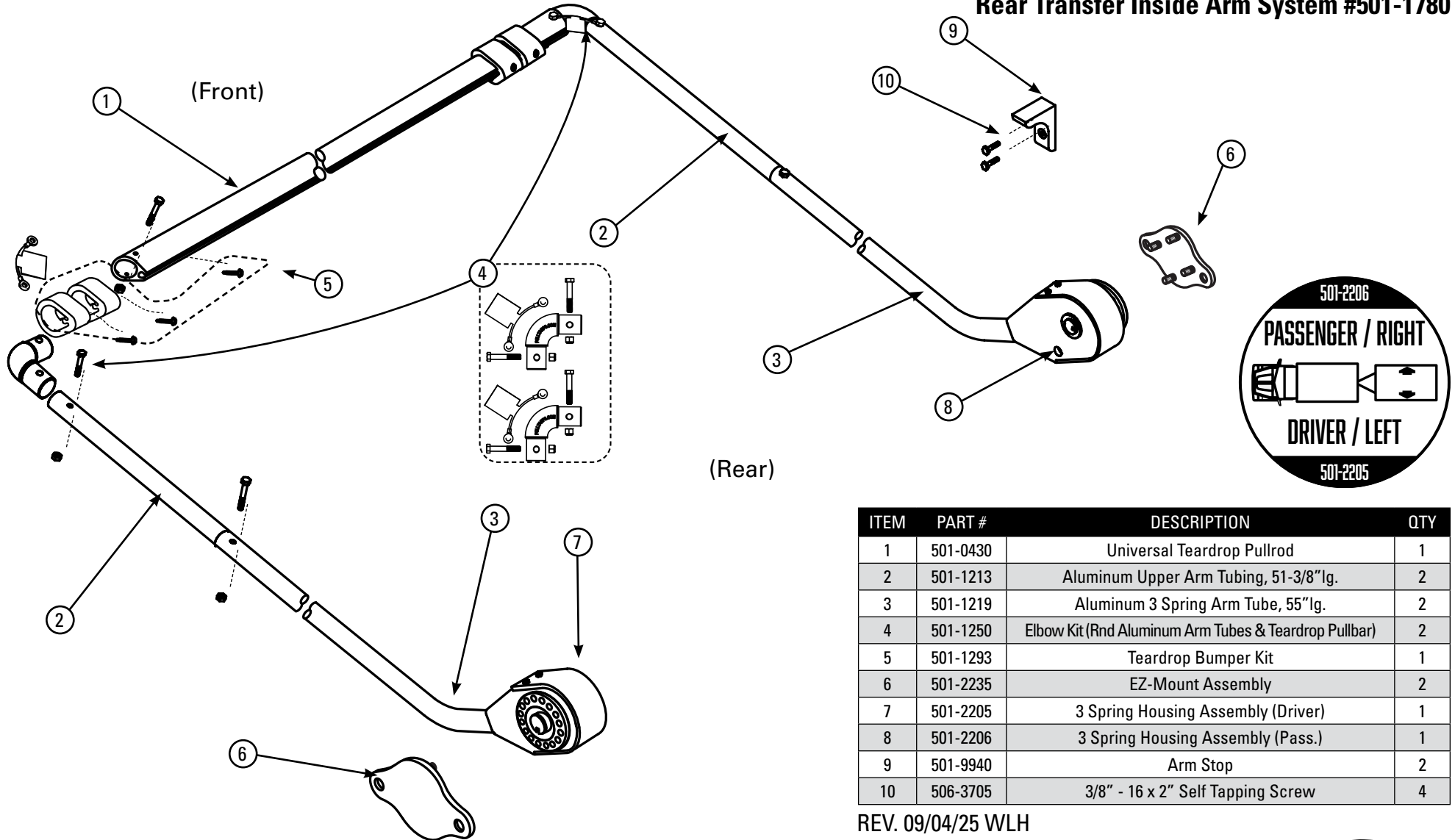

ITEM	PART #	DESCRIPTION	QTY
1	501-0430	Universal Teardrop Pullrod	1
2	501-1213	Aluminum Upper Arm Tubing, 51-3/8"lg.	2
3	501-1219	Aluminum 3 Spring Arm Tube, 55"lg.	2
4	501-1250	Elbow Kit (Rnd Aluminum Arm Tubes & Teardrop Pullbar)	2
5	501-1293	Teardrop Bumper Kit	1
6	501-2235	EZ-Mount Assembly	2
7	501-2205	3 Spring Housing Assembly (Driver)	1
8	501-2206	3 Spring Housing Assembly (Pass.)	1
9	501-9940	Arm Stop	2
10	506-3705	3/8" - 16 x 2" Self Tapping Screw	4

REV. 09/04/25 WLH



INSTALLATION INSTRUCTIONS

Inside Transfer & High Mount Arm Kits

High Mount Arm System #501-1781

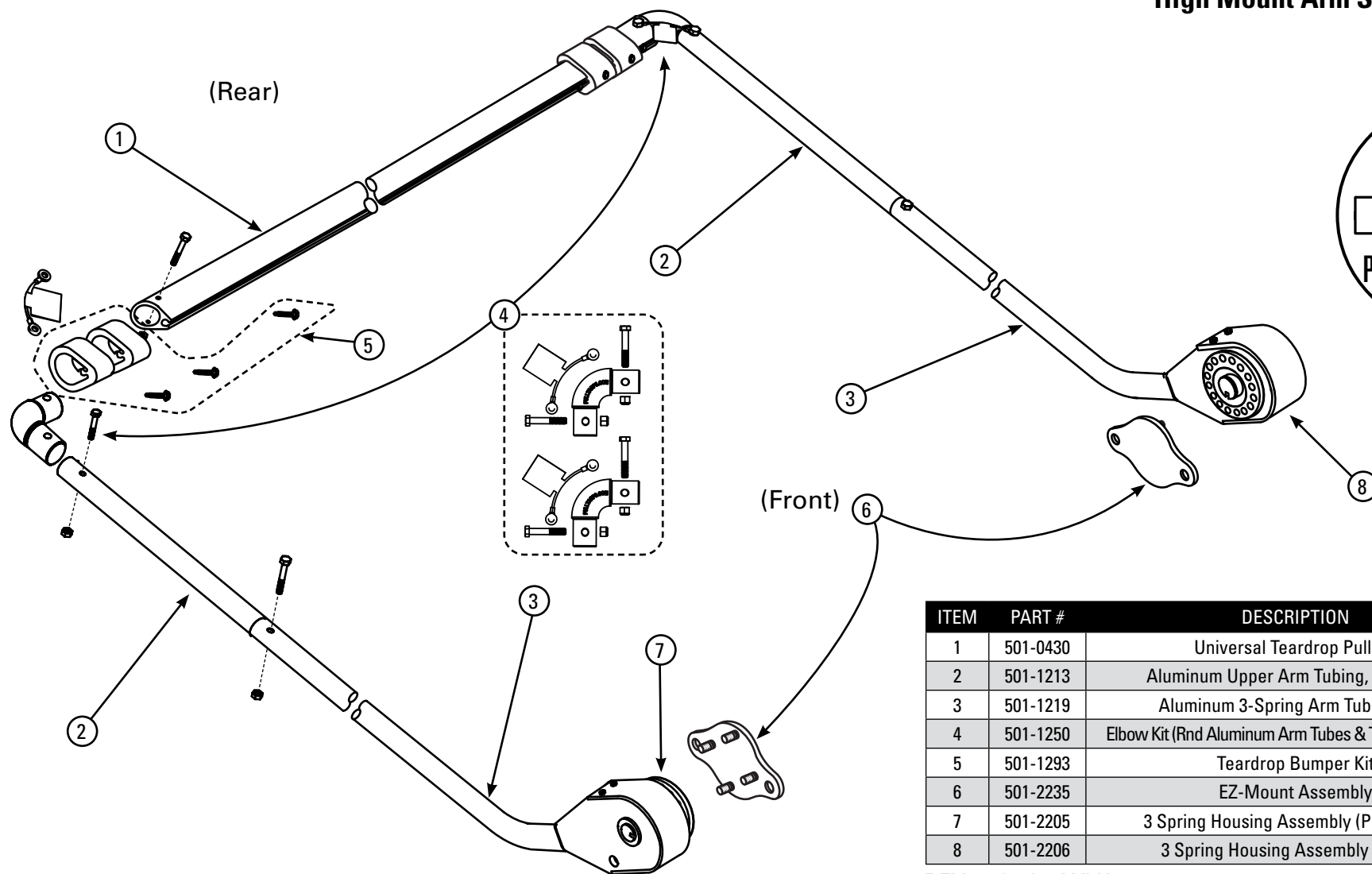

ITEM	PART #	DESCRIPTION	QTY
1	501-0430	Universal Teardrop Pullrod	1
2	501-1213	Aluminum Upper Arm Tubing, 51-3/8"lg.	2
3	501-1219	Aluminum 3-Spring Arm Tube, 55"lg.	2
4	501-1250	Elbow Kit (Rnd Aluminum Arm Tubes & Teardrop Pullbar)	2
5	501-1293	Teardrop Bumper Kit	1
6	501-2235	EZ-Mount Assembly	1
7	501-2205	3 Spring Housing Assembly (Passenger)	1
8	501-2206	3 Spring Housing Assembly (Driver)	1

REV. 09/05/25 WLH



A Roll-Rite Brand



INSTALLATION INSTRUCTIONS

Inside Transfer & High Mount Arm Kits

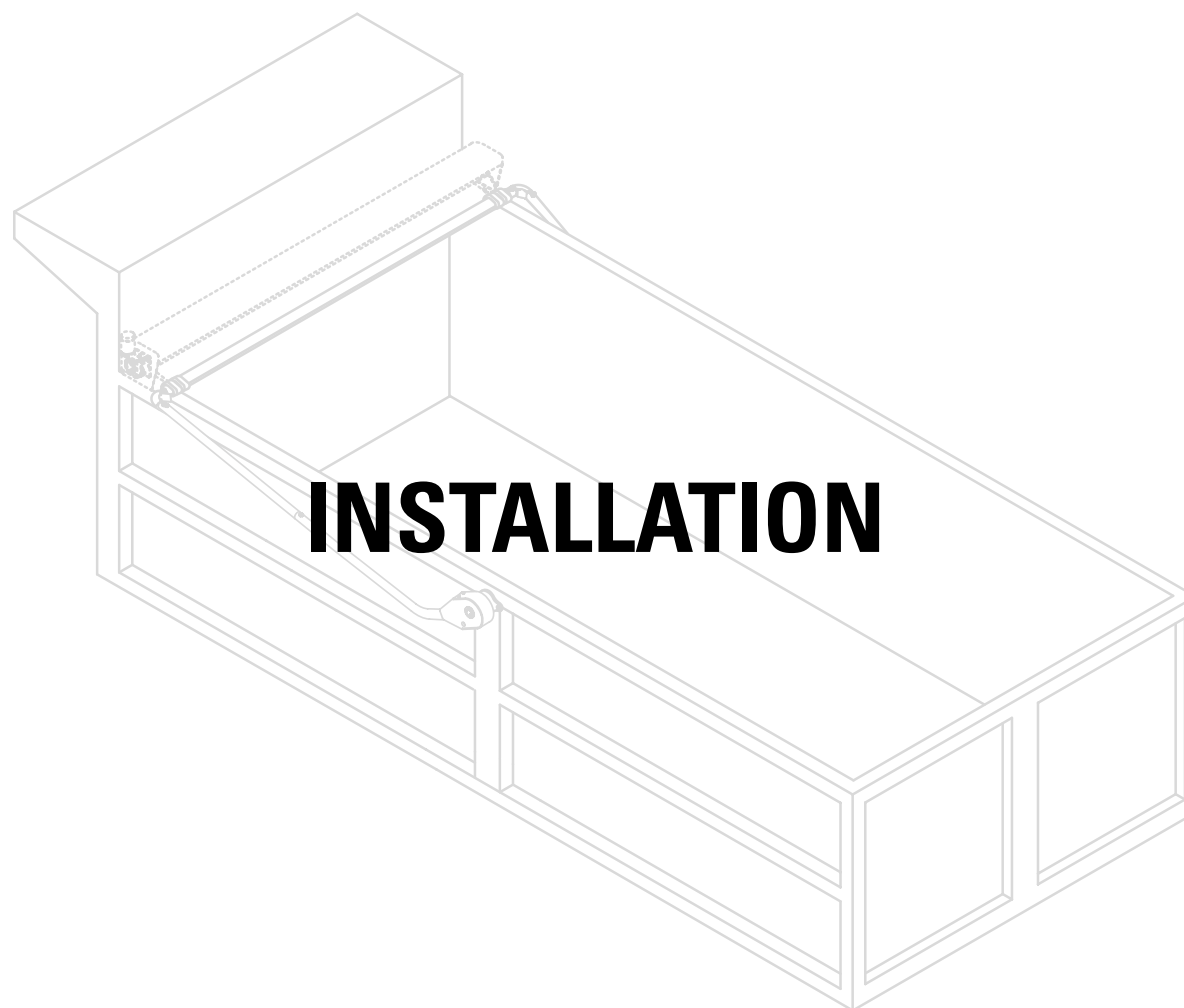



INSTALLATION INSTRUCTIONS

Inside Transfer & High Mount Arm Kits

Pivot Points and Mounting Locations (Inside Transfer & High Mount)

Step 1: Careful measurements must be taken to insure that the arm and pivot assemblies are mounted square and parallel to the truck or trailer body. Locate the proper mounting positions by determining Point "A" and Point "B" and insuring measurement "D" and "E" are equal (Fig. 1). The pivot "C" should be 1/2 way between Point "A" and Point "B" and 7" below the top rail on both sides (Fig. 2).

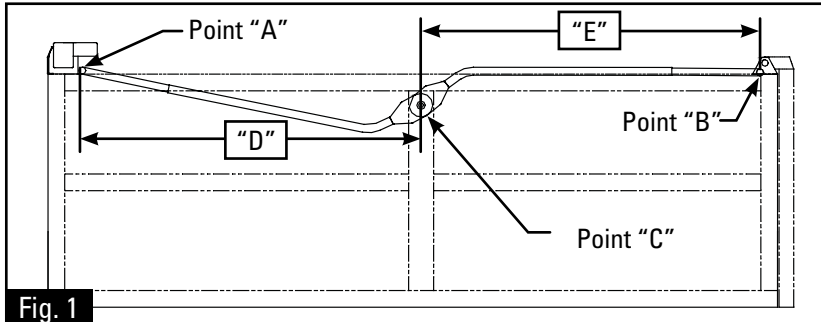

Fig. 1

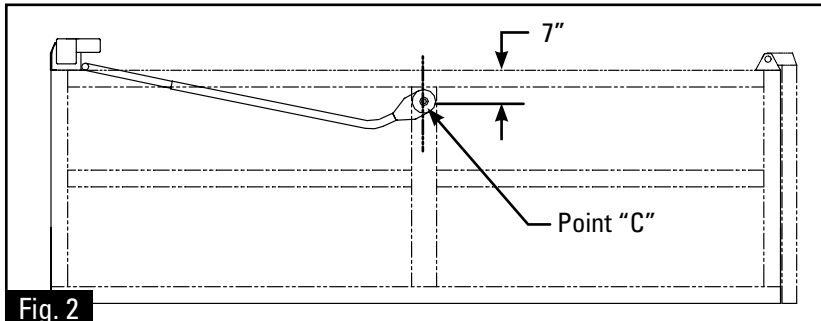

Fig. 2

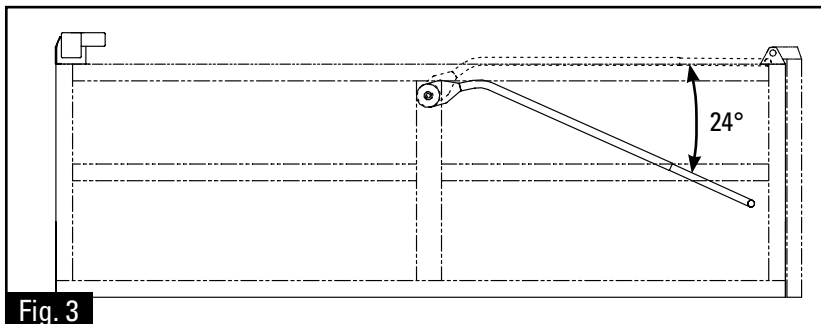

Fig. 3

Step 2 - Arm Preload:

Arm must be indexed with no load at 24 degrees to top rail for proper preload of springs (Fig. 3).

Step 3 - Mounting the Pivot:

Once the mounting positions has been determined, weld or bolt the Arm Adaptor Plate in place (Fig. 4) inside the box (for Inside Transfers) and on the outside of the box (for High Mount Arms).

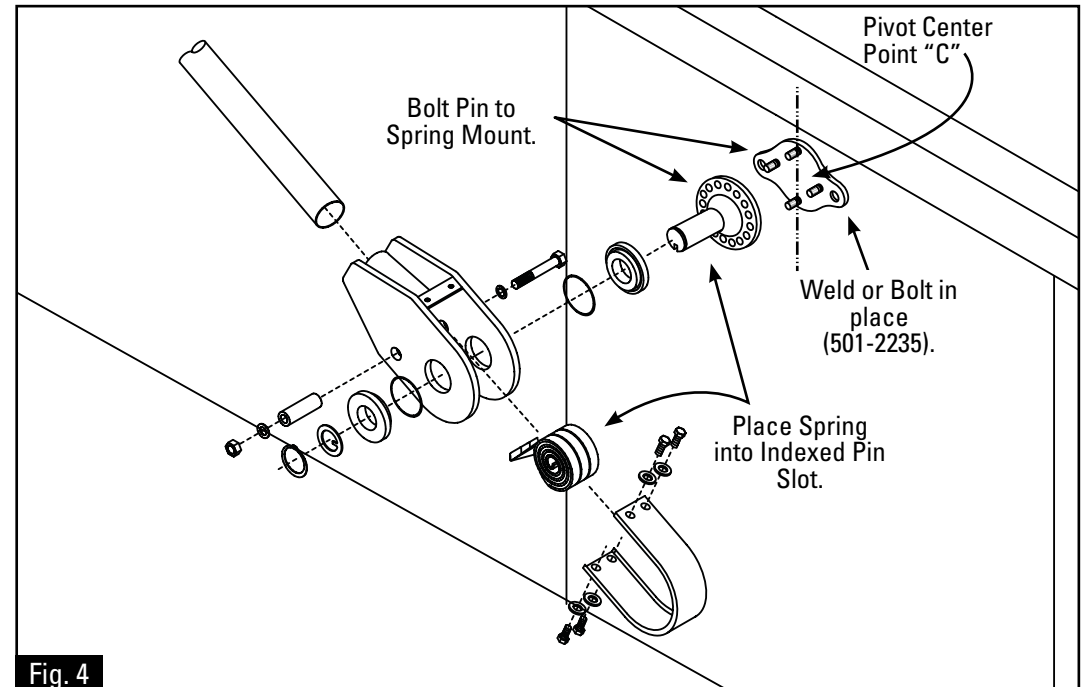

Fig. 4



INSTALLATION INSTRUCTIONS

Inside Transfer & High Mount Arm Kits

Setting the Index

Step 4 - Setting the Index for EZ-Mount Systems: The illustrations below are for setting the proper index (Fig. 5A, 5B, 5C & 5D). For an Inside Transfer, the measurement is taken inside the box on the passenger side. For High Mount, the measurement is taken outside the box on the driver side.

Fig. 5A

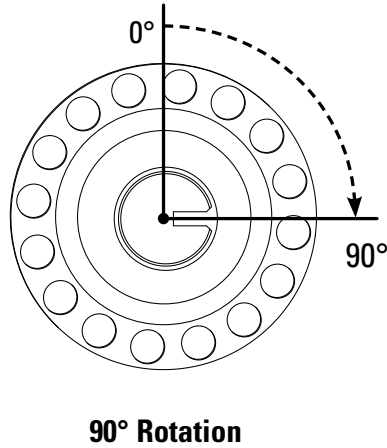

Fig. 5B

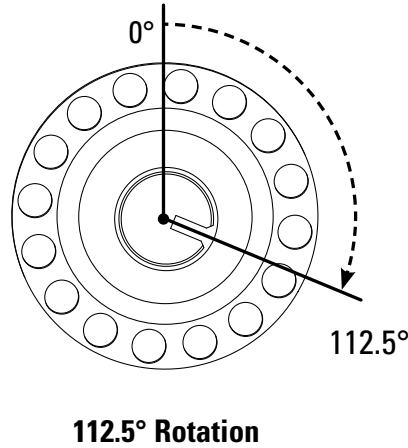

Fig. 5C

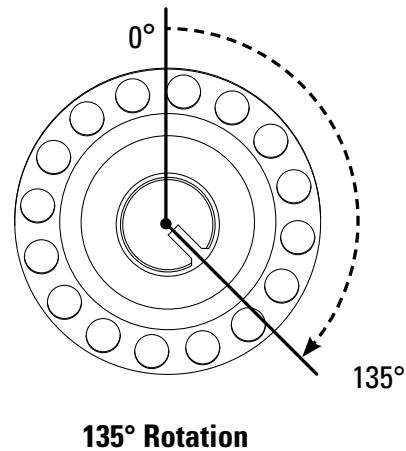
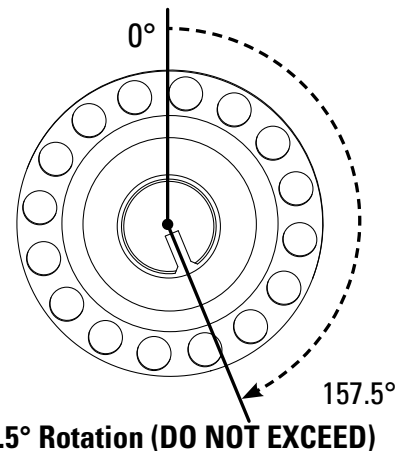

Fig. 5D



Step 5

High Mount - Outside of Box:

Measure the index by adjusting the Pin until you get the desired rotation (Fig. 6A).

Fig. 6A

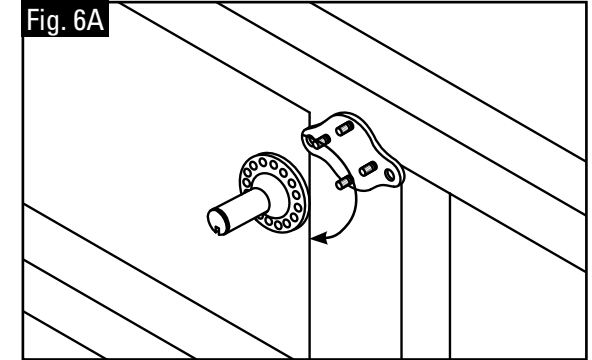

High Mount - Outside of Box:

Measure the index by adjusting the Pin until you get the desired rotation (Fig. 6B).

Fig. 6B

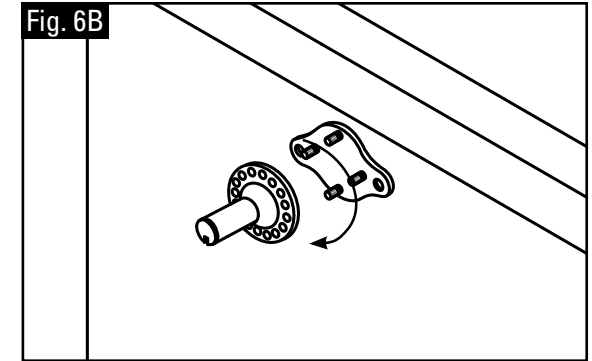



INSTALLATION INSTRUCTIONS

Inside Transfer & High Mount Arm Kits

Arm Alignment & Arm Stop

Fig. 7A

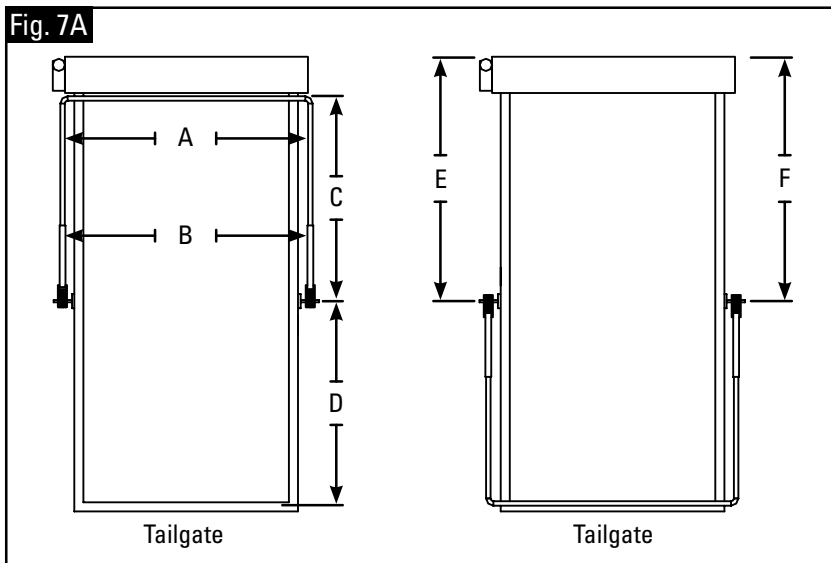
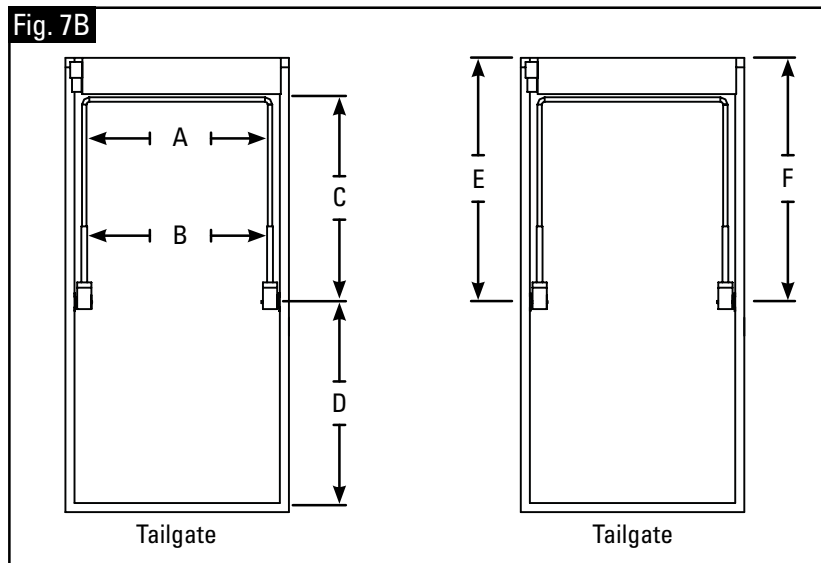

Fig. 7B



Step 6 - Correct Alignment of High Mount Arms: Arms and pivots must be square and parallel to truck (Fig. 7A & 7B).

(Dimension "A" must equal "B" - Dimension "C" must equal "D" - Dimension "E" must equal "F")

Step 7: Adjust the Arms on both sides to be the same length (Fig. 8).

Fig. 8

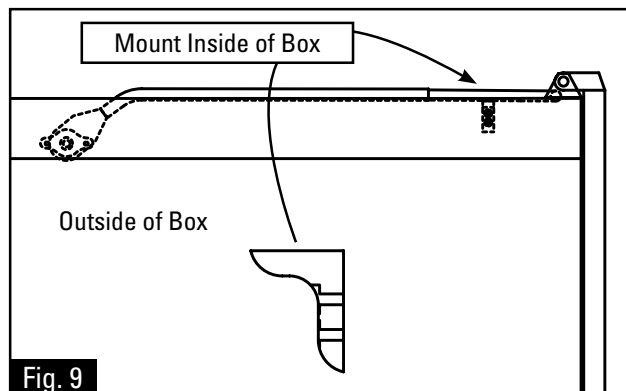
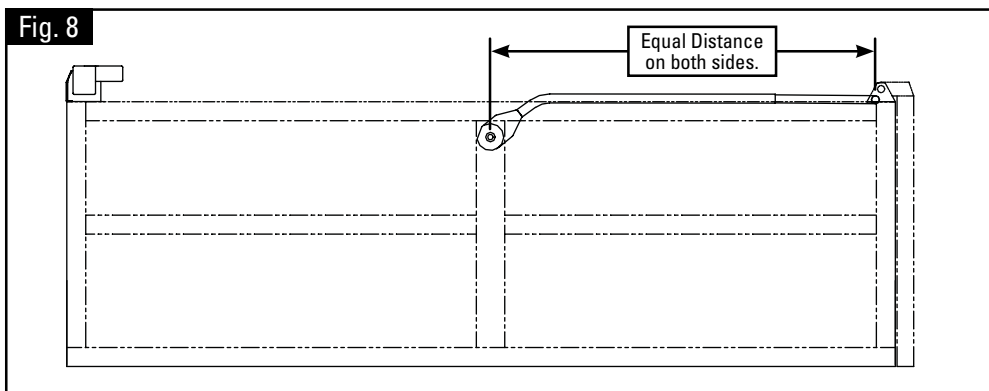

Fig. 9

Step 8:

For Inside Transfers, install the Arm Stop on the inside of the truck box (Fig. 9).



INSTALLATION INSTRUCTIONS

Inside Transfer & High Mount Arm Kits

Tarp and Pullbar Installation

Step 9 - Tarp Installation: Slide Tarp into Groove on roller tube and center (Fig. 10).

Fig. 10

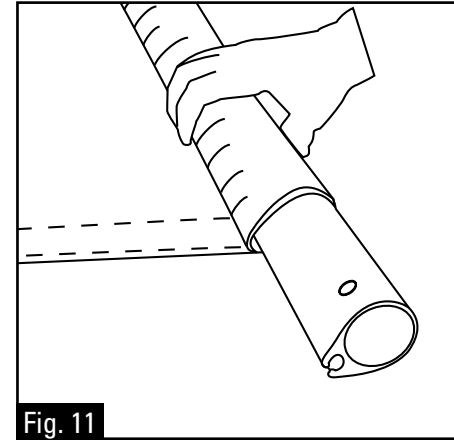
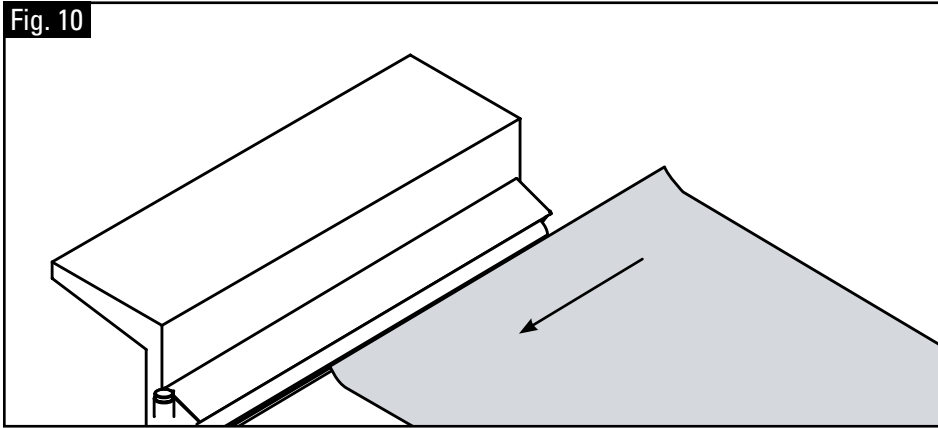

Fig. 11

Step 10 - Installing The Pullbar:

Cut the pullbar to length making sure the arms remain parallel and square to the body.

Slide the tarp into groove in the pullbar and center the tarp.

Roll the tarp up on the pullbar two revolutions (Fig. 11).

Fig. 12

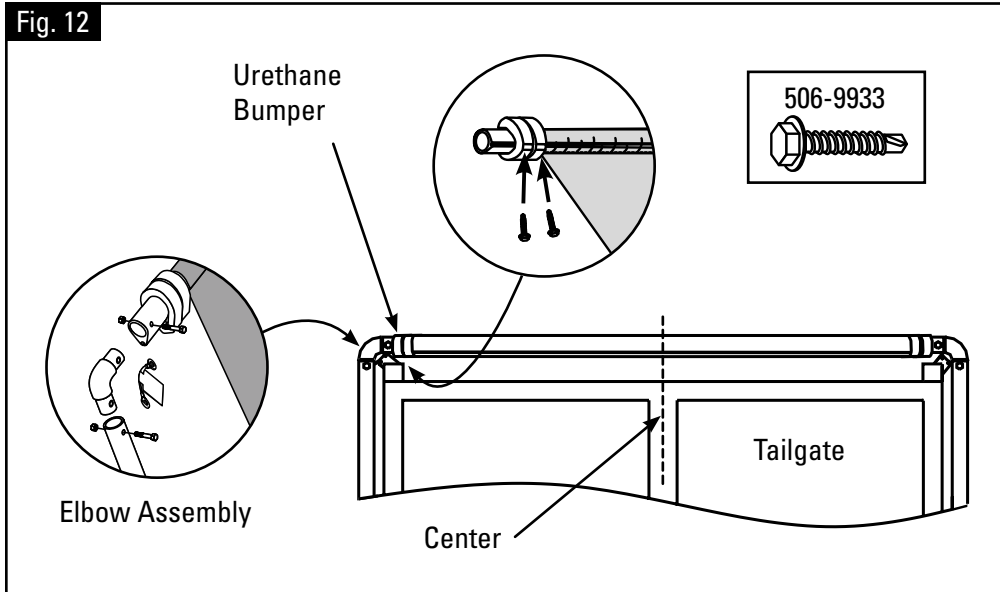

Step 11: Fasten the tarp in place by sliding the two urethane bumpers on to the pullbar far enough to touch the edges of the tarp. Lock in place by installing a 1-1/2" long (506-9933) self drilling screw through the bumper and into the hem tube groove of the pullbar (Fig. 12).

For elbows, use the long bolts provided in the kit, when deployed to catch the rope on flap tarps. Install tether onto elbows as shown.

Note: Tarp must be retracted when dumping.



A Roll-Rite Brand



INSTALLATION INSTRUCTIONS

Inside Transfer & High Mount Arm Kits

FLAP TARP, ROPE & HOOK INSTALLATION





INSTALLATION INSTRUCTIONS

Inside Transfer & High Mount Arm Kits

Optional Flap Tarp, Rope and Hook Installation

Parts:

Tie Down Hooks (Steel or Alum.)

Pull Down Hook

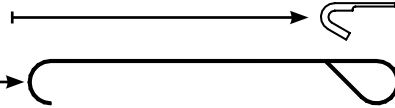

Note: The Location Of The Tie Down Hooks Is Critical!

Step 1: Flip the braided rope over the corner so that the flaps and tie down ropes hang over each side of the box. The number of tie down hooks vary depending on the length of your tarp. One pull down hook is included with your Pulltarp system. If needed. Use the hook to pull the braided rope and flaps over the side of the box.

The tie down hooks must be positioned so that:

1. The tie down rope can be reached from the ground.
2. The bungee cord has to be stretched to reach the last hook (see **Step 2** in **Bungee Cord Installation** section).
3. The rope has no slack.
4. The tie down hooks are level with one another.

To ensure proper hook placement, first duct tape the rope to the box in place of the tie down hooks. Start with hook closest to the cab.

1. Position the first hook 6" (15.24cm) down and 12" (30.48cm) forward (toward the cab) from the first grommet (Fig. 13).
2. Position 2nd hook straight down from 1st grommet. This hook should be reached from ground (Fig. 14).
3. Place middle hooks equal distances from grommet (Fig. 15). These hooks should be placed at the same height as the second hook.
4. Position last hook (closest to the tailgate) below the last grommet at the same height as the others (Fig. 16).
5. Weld hooks in place.

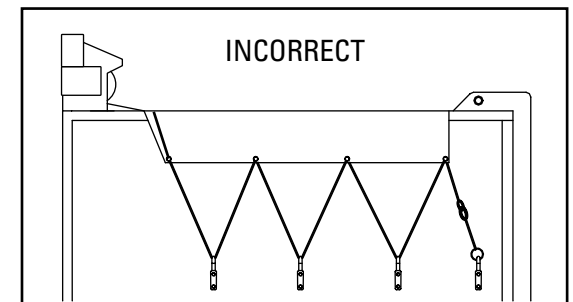
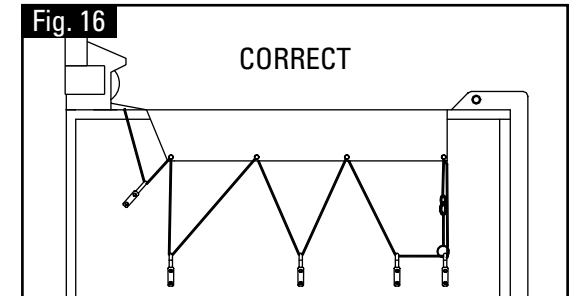
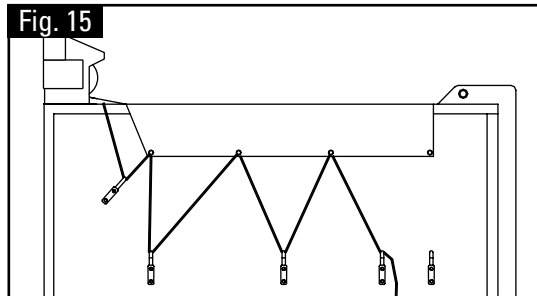
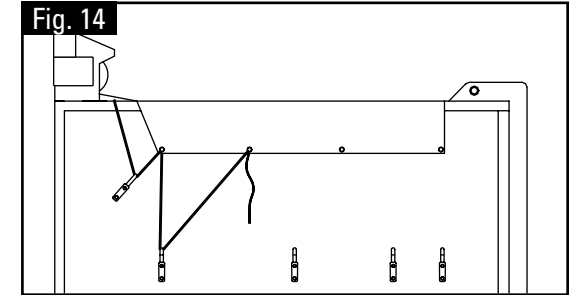
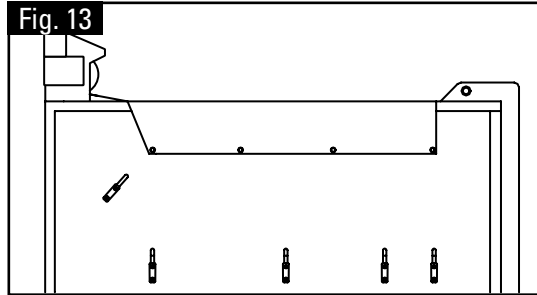



INSTALLATION INSTRUCTIONS

Inside Transfer & High Mount Arm Kits

Bungee Cord Installation

Parts:

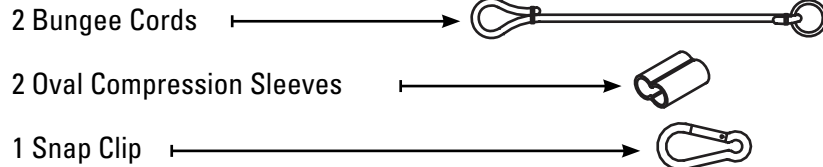

Step 2: After side hooks are installed, the tie down rope must be installed and cut to proper length. It is important to get all of the slack out of the rope to prevent blowing and rubbing of flaps in windy conditions.

Tarps with Side Flaps

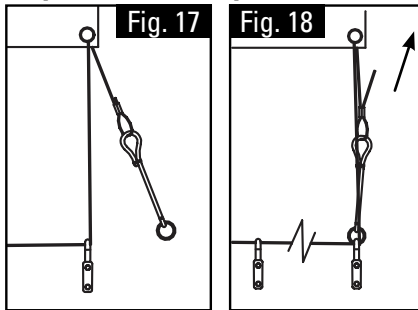

To tighten, pull loose end of rope through the Oval Compression Sleeve (Fig. 17). Stretch the bungee cord making sure all slack is taken out of the rope, crimp compression sleeve (Fig. 18). Be sure to keep flaps even on sides so Tie Down Ropes remain equal in length.

Note: Check for proper placement of rope through the last two hooks.

Snap Clip Installation

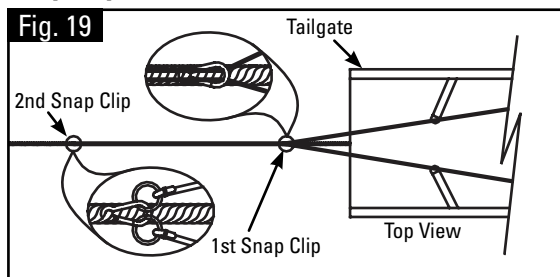

Note: First snap clip should not be used on long wheel base belly dumps.

Flip the rope back on top of the tarp, making sure to hold the bungee at all times. The first snap clip is factory installed 5'-6" from the pullrod. Open the clip and enclose the rope. Weave the second clip through the main pullrope where the ends of the bungee cords meet the main pullrope. Make sure the rope is taught when clipped (Fig. 19).

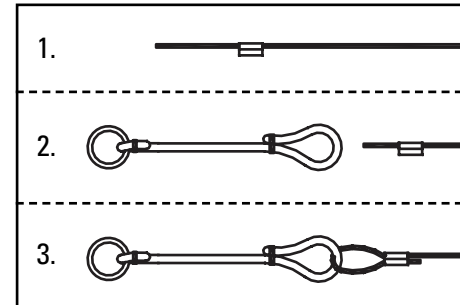

Connect Bungee Cord to Rope

1. Thread braided rope through Oval Compression Sleeve.
2. Feed rope through the eye of the bungee cord.
3. Thread the rope back through the oval compression sleeve. Adjust for proper length. Crimp compression sleeve.

Excess Rope

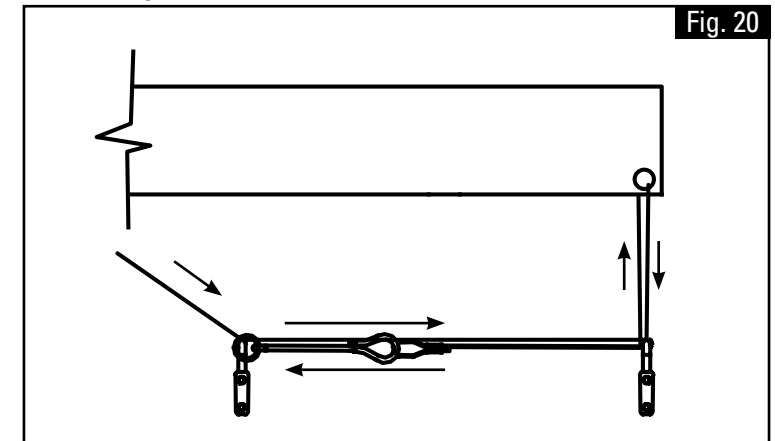

You may need extra rope to keep the side flap system ground operated. If your application requires extra rope, the slack needs to be taken up by tacking the end of the bungee cord to an alternate hook (Fig. 20).



INSTALLATION INSTRUCTIONS

Inside Transfer & High Mount Arm Kits

Flap, Rope and Rope Hook Placement

Step 3 - Flap / Tie Down Rope Placement and Installation (Fig. 21).

Fig. 21

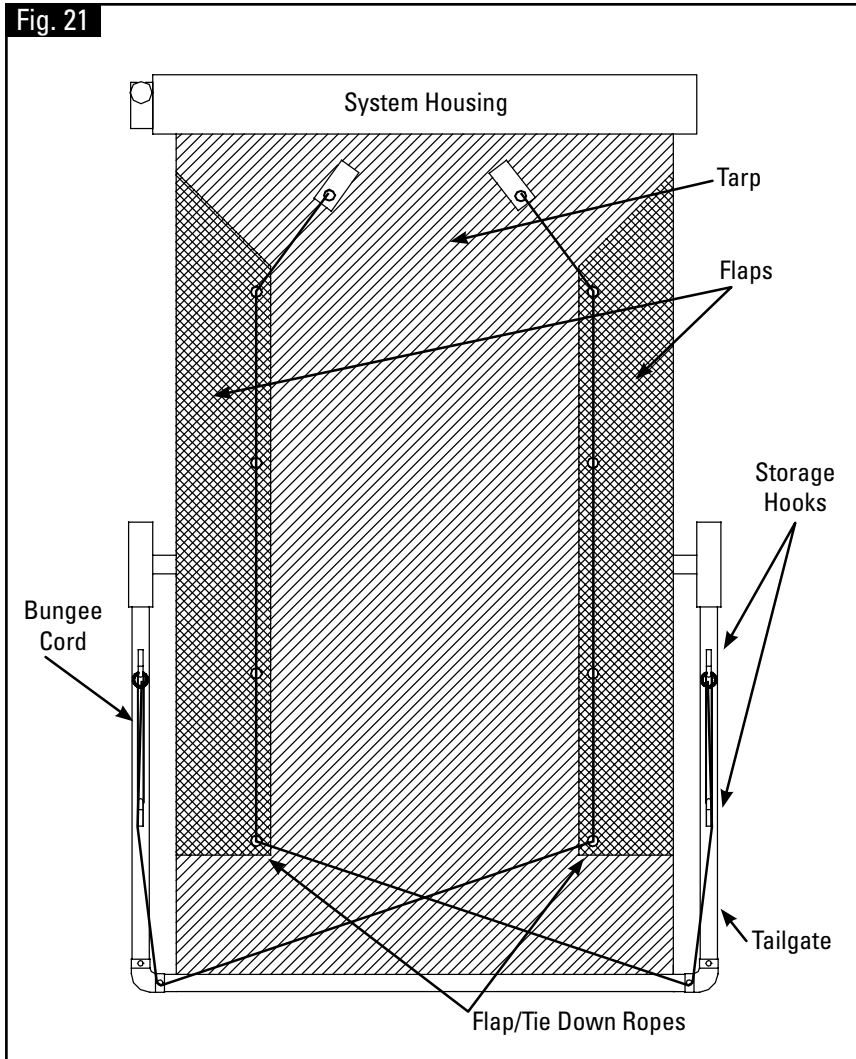
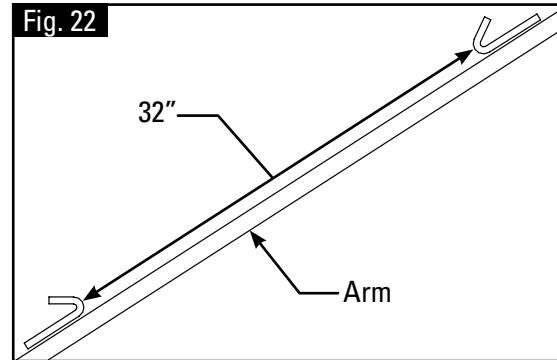
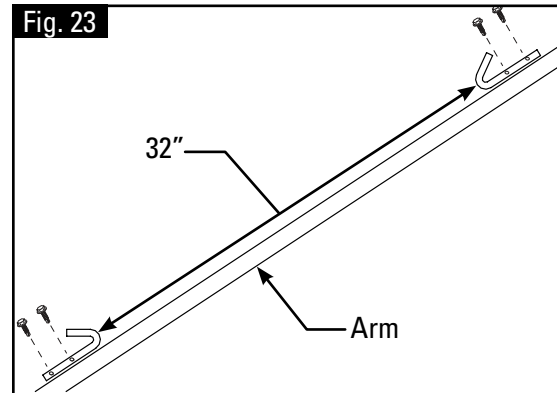

Fig. 22



Step 4 - Rope Hook Placement: Weld rope storage hook on the top of the arms approx. 32" apart (Fig. 22).

Fig. 23



Step 5 - Rope Hook Placement For Aluminum Arms: Use Self Drilling screws (part #506-9933) to install hooks (Fig. 23).

Fig. 24

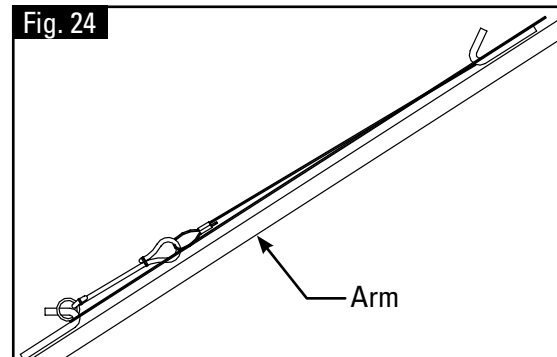

Step 6 - Rope storage on Arms (Fig. 24).